



www.worldrivet.com

Please contact us upon your riveting requirements!

**SUZHOU RIVMATE IMPORT & EXPORT CO.,LTD**

Address: Room 9016 of 2# Building, No. 436 Changjiang Road,  
Huqiu District, Suzhou City, Jiangsu Province, China 215011  
Tel: 0086-512-65280456 Fax: 0086-512-65280262  
E-mail: factory@world-rivet.com  
http://www.worldrivet.com

**JIANGSU WASHEN FASTENER MANUFACTURE CO.,LTD**

Factory address: No.2 of Shuangyu Road of South Industry  
Zone,Jingjiang city of JiangSu Province  
Tel:0086-523-80237002 Fax:0086-523-80237111  
E-mail:factory@world-rivet.com  
http://www.worldrivet.com

RIVMATE RESERVE THE RIGHT TO EXPLAIN AND REVISE FOR BROCHURES

Rivmате Brochure of Blind Rivet Series · IFI Standard

RIVMATE

Washen



Scan to View Factory Video  
In Youtube

2026 Edition

# HIGH STRENGTH BLIND RIVETING & BOLTING SYSTEM!

Rivet the world Connect all of us!



Automotive Lightweight Riveting Solution



2026 Edition



# COMPANY PROFILE

**Suzhou Rivmate Import&Export Co.,Ltd**  
**Jiangsu Washen Fastener Manufacture Co.,Ltd**

Jiangsu Washen Fastener Manufacture Co., Ltd is a High-Tech fastener factory that supplies rivets & solutions to Automobile, Mid/High Voltage Cabinets and Home Appliance industries.

We have introduced 48 sets imported multi-station machines and 6 sets laser selecting machines will be expected in 2018. Our factory manufactures 400 million pieces of structural rivets and automobile blind rivets, 1 billion standard blind rivets annually now. Our Laboratory is equipped with Measuring Projector, Tensile & Shear Machines, Hardness Testing Set, Vision Measuring System, Destructive Testing Machine, Profilometer, Thickness Testing Machine and Salt Spray Testing Machine so that we can meet the automobile industry, electrical cabinet industry's strict requirement by providing fast & accurate testing data.

We choose top-ranking domestic suppliers as partners, from material selecting, manufacturing, till shipment are all strictly monitored and recorded according to ISO/TS16949 management system. We follow ISO, DIN7337, IFI114, HUCK and Avdel standard, and also we can design and produce according to customer requirement.



# CONTENTS

<b>Open Type Blind Rivet</b> 		<b>09</b>
1	5052 Aluminum&Carbon steel Open Type Dome Head	09
2	5052 Aluminum&Carbon steel Open Type CSK Head	11
3	5052 Aluminum&Carbon steel Open Type Large Flange	13
4	Full Aluminum Open Type Dome Head	15
5	Full Stainless Steel Open Type Dome Head	17
6	Full Stainless Steel Open Type CSK Head	19
7	Full Stainless Steel Open Type Large Flange	21
8	Full Steel Open Type Dome Head	23
9	Full Steel Open Type CSK Head	25
10	Full Steel Open Type Large Flange	27
11	Open Type Blind Rivet (Monel series) <b>*New</b>	29

Applied in the Automotive, White goods, Snowmobile trailer, Lighting equipment, Conference room furnishings, Gutter...



Scan to View Test Video  
 (All Carbon Steel Open Type)  
 In Youtube

<b>Sealed Type Blind Rivet</b> 		<b>33</b>
12	Aluminum&Steel Sealed Type Dome Head	33
13	Aluminum&Steel Sealed Type CSK Head	35
14	Aluminum&Steel Sealed Type Large Flange	37
15	Aluminum&Stainless Steel Sealed Type Blind Rivet	39
16	Full Stainless Steel Sealed Type Blind Rivet	41
17	Full Stainless Steel Sealed Type CSK Head	43

Applied in the White goods, Lawn and garden, School bus, Electronic enclosure, Electronic switch Sunroof...



Scan to View Test Video  
 (All Stainless Steel Sealed Type)  
 In Youtube

<b>Multi-grip Blind Rivet</b> 		<b>45</b>
18	Aluminum&Steel Multi-grip Dome Head	45
19	Aluminum&Steel Multi-grip CSK Head	47
20	Aluminum&Steel Multi-grip Large Flange	49
21	Aluminum&Stainless Steel Multi-grip Blind Rivet	51
22	Full Steel Multi-grip Blind Rivet	53
23	Full Stainless Steel Multi-grip Blind Rivet	55

Applied in the Snowmobile, Passenger air bag, Roll-up security door...



Scan to View Test Video  
 (All Stainless Steel Multi-grip)  
 In Youtube

# CONTENTS

## Uni-grip Blind Rivet 57

- [24 Full Carbon Steel Uni-grip Blind Rivet](#) 57
- [25 Full Stainless Steel Uni-grip Blind Rivet](#) 59

Applied in the Telecommunications cabinets, Electronic components, Ladders...



Scan to View Test Video  
(All Carbon Steel Uni-grip)  
In Youtube

## Trifirm Rivet 61

- [26 Full Aluminum Folding Rivet](#) 61
- [28 7.5mm Aluminum Watertight Folding Rivet](#) 65
- [27 5.2/6.4 Aluminum Watertight Folding Rivet](#) 63

Applied in the Refrigerated truck, Container, Cladding, Commercial vehicles...



Scan to View Test Video  
(All Aluminum Trifirm)  
In Youtube

## Now-Lock Blind Rivet 67

- [29 Full Carbon Steel Now-Lock Blind Rivet](#) 67
- [31 Full Aluminum Now-Lock Blind Rivet](#) 71
- [30 Full Stainless Steel Now-Lock Blind Rivet](#) 69

Applied in the Automotive, Cabinets and enclosures, Commercial vehicles, Domestic appliances, Heating and ventilation...



Scan to View Test Video  
(Carbon Steel Now-Lock)  
In Youtube

## Mono-Lock Blind Rivet 73

- [32 Full Carbon Steel Mono-Lock Blind Rivet](#) 73
- [34 Full Aluminum Mono-Lock Blind Rivet](#) 77
- [33 Full Stainless Steel Mono-Lock Blind Rivet](#) 75

Applied in the Automotive, Cabinets and enclosures, Commercial vehicles, Domestic appliances, Heating and ventilation...



Scan to View Test Video  
(Carbon Steel Mono-Lock)  
In Youtube

## Hem-Firm Blind Rivet 79

- [35 Full Carbon Steel Hem-Firm Blind Rivet](#) 79

Applied in the Scaffold tower, Step ladder, Car seat base, Vehicle mud flaps...



Scan to View Test Video  
(Hem-Firm Type A)  
In Youtube

## Rivlok & Rivbulb Double-locking System 81

- [36 Rivlok & Rivbulb Double-locking System](#) 81

Applied in the Car frame & Car load-bearing beam.



Scan to View Test Video  
(Rivlok)  
In Youtube



Scan to View Test Video  
(Rivbulb)  
In Youtube

# CONTENTS

## High Strength Lockbolt System 85

- 37 Carbon Steel High Strength Lockbolt System 85
- 38 Carbon Steel High Strength Mi-Lock System **\*New** 91

Applied in the HVAC, Trailer and Container assembly, Rotating equipment, Shopping carts, Railroad and Transit cars, Geodesic structures...



Scan to View Test Video  
(Carbon Steel High Strength Lockbolt)  
In Youtube

## Boom-Lock Blind Rivet 95

- 39 Full Carbon Steel Boom-Lock Blind Rivet 95

Applied in the Photovoltaic Industry, Railway...



Scan to View Test Video  
(Carbon Steel Boom-Lock)  
In Youtube

## Double Countersunk Head Pull Through Rivet 99

- 40 Double Countersunk Head Pull Through Rivet 99

Applied in the Electronic enclosures, Computer Servers, Lighting...

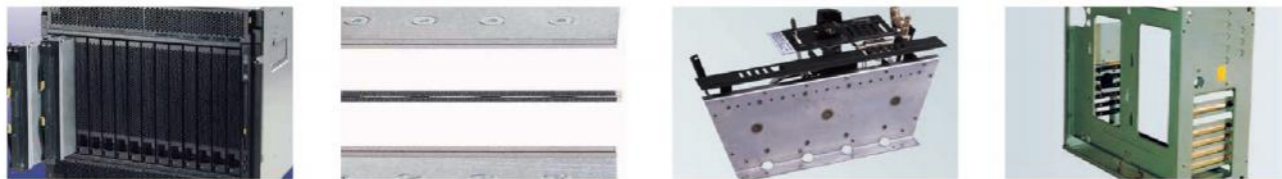

## Speed Rivet Series 103

- 41 Speed Rivet Series 103

Applied in the Automotive, Granary...

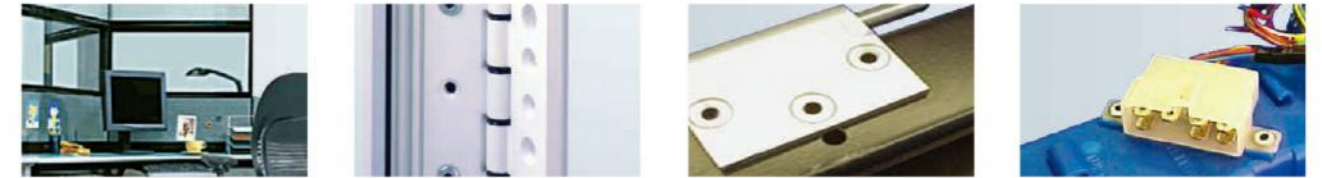

## Q-Lock Blind Rivet 109

- 42 Q-Lock Blind Rivet 109

Applied in the Automotive, Building industries, Commercial vehicles, Domestic appliances, Heating and ventilation...



## Self Piercing Rivet 119

- 43 Carbon Steel Self Piercing Rivet 119

car sunroof, engine hood, heavy truck cab, door plate reinforcement and etc



Scan to View Test Video  
(Carbon Steel Self Piercing Rivet)  
In Youtube

# CROSS REFERENCE

Rivmate	Huck	Avdel	POP	Gesipa	Marson	Rivet King	Ornit	Gobel
<b>STANDARD BLIND RIVETS</b>								
Open Type	/	Open End	Open End	Open End	Open End	Open End	/	STANDARD
Sealed Type	/	Closed End	Closed End	CAP®	CAP	Closed End	/	CUP
<b>PULL THROUGH BLIND RIVETS</b>								
Pull Through	/	/	Pull-Thru (PT)	/	/	/	/	/
<b>MULTI-GRIP BLIND RIVETS</b>								
Multi-grip	/	AVEX®	MULTIGRIP™	POLYGRIP	MULTI-GRIP™	MULTI-GRIP-CT MULTI-GRIP-RT	U-FIX	MULTI-CT MULTI-RT
<b>SEMI-STRUCTURAL BLIND RIVETS</b>								
Uni-Grip	/	AVIBULB®	HR-RIVET®	G-BULB®	/	RIVIBUL®	STELOCK	GO-BULB
Uni-Grip	/	AVINOX®				RIVINOX®		GO-INOX

Rivmate	Huck	Avdel	POP	Gesipa	Marson	Rivet King	Ornit	Gobel
<b>STRUCTURAL BLIND RIVETS</b>								
Mono-LOCK	/	MONOBOLT®	/	/	/	TIGERBOLT®	OR-BOLT	M-LOCK
Now-Lock	MAGNALOK®	INTERLOCK®	/	MEGAGRIP®	KLICK-LOCK	IN-LOCK®	ORNILOCK	GO-LOCK
Hem-Firm-A Type	AUTOBOLT®	HEMLOK®	/	/	/	STEMLOCK®	/	H-LOCK
Hem-Firm-B Type	/	/	/	/	/	/	ORLOCK	PREMIUM
<b>TRI-FOLDING/LOAD SPREADING RIVETS</b>								
Trifirm	/	BULBEX®	LSR LOAD "R"SPREADING	TRI-FOLD®	TRI-BULB®	TRI-FIX®	OR-BULB	TRI-GO
Bulbtight Trifirm	MAGNATITE®	KLAMPTITE®	/	BULB-TITE®	/	SUPERTRIFIX®	/	TRE-GO
<b>SPECIALTY BLIND RIVETS</b>								
GROOVED RIVETS	/	/	/	/	/	GROOVED RIVETS	/	RILLI
Peel Type(Normal Peel, Peel lock) Note: ①Normal Peel: a.The head remains inside the rivet housing after riveting; b.The rivet head is not retained inside the rivet housing after riveting. ②Peel lock:The product has a lock cylinder function.	/	T RIVET	/	PEEL BLIND RIVET	/	PLR RIVETS®	/	STAR

# 5052 Aluminum & Carbon steel Open Type Dome Head

## Available Sizes

Φ2.4(3/32"), Φ3.2(1/8"), Φ4.0(3/16"),  
Φ4.8(3/16"), Φ6.4(1/4")

## Head Styles

Dome Head

## Materials

Body: Aluminum  
Mandrel: Carbon steel



5052 Aluminum & Carbon steel Open Type Dome Head

RWMATE

Washen

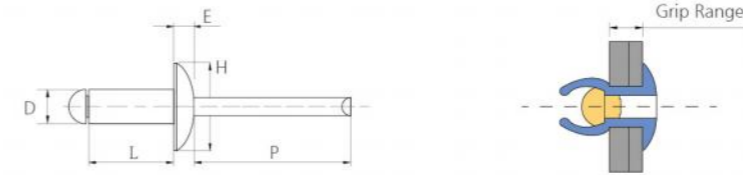

Material	Body	5052 Aluminum
	Mandrel	Carbon steel
Finish	Body	Polished
	Mandrel	Zinc Plated

D Nom.	Art. Code	Part. No	Grip Range		L(Max.)		H Nom.	E Max.	Dirll No. & Hole Size	P Min.	Shear LBS	Tensile LBS
			Inch	mm	Inch	mm						
(3/32") 2.4mm	2-AS32	IFI-2AS24064	0.020-0.125	0.5-3.2	0.250	6.4	0.188" 4.8	0.032" 0.81	#41 2.5-2.6	1.00" 25.4	70 310N	80 360N
	2-AS34	IFI-2AS24095	0.126-0.250	3.2-6.4	0.375	9.5						
	2-AS36	IFI-2AS24127	0.251-0.375	6.4-9.5	0.500	12.7						
(1/8") 3.2mm	2-AS41	IFI-2AS32054	0.020-0.062	0.5-1.6	0.212	5.4	0.25" 6.4	0.040" 1.02	#30 3.3-3.4	1.06" 27	120 530N	150 670N
	2-AS42	IFI-2AS32070	0.063-0.125	1.6-3.2	0.275	7.0						
	2-AS43	IFI-2AS32086	0.126-0.187	3.2-4.8	0.337	8.6						
	2-AS44	IFI-2AS32102	0.188-0.250	4.8-6.4	0.400	10.2						
	2-AS45	IFI-2AS32117	0.251-0.312	6.4-7.9	0.462	11.7						
	2-AS46	IFI-2AS32133	0.313-0.375	7.9-9.5	0.525	13.3						
	2-AS48	IFI-2AS32165	0.376-0.500	9.5-12.7	0.650	16.5						
	2-AS410	IFI-2AS32197	0.501-0.625	12.7-15.9	0.775	19.7						
(5/32") 4.0mm	2-AS52	IFI-2AS40076	0.020-0.125	0.5-3.2	0.300	7.6	0.312" 7.9	0.050" 1.27	#20 4.1-4.2	1.06" 27	190 850N	230 1020N
	2-AS53	IFI-2AS40092	0.126-0.187	3.2-4.8	0.362	9.2						
	2-AS54	IFI-2AS40108	0.188-0.250	4.8-6.4	0.425	10.8						
	2-AS56	IFI-2AS40140	0.251-0.375	6.4-9.5	0.550	14.0						
	2-AS58	IFI-2AS40171	0.376-0.500	9.5-12.7	0.675	17.1						
	2-AS510	IFI-2AS40203	0.501-0.625	12.7-15.9	0.800	20.3						
	2-AS516	IFI-2AS40298	0.876-1.000	22.2-25.4	1.175	29.8						
	(3/16") 4.8mm	2-AS62	IFI-2AS48083	0.020-0.125	0.5-3.2	0.325						
2-AS63		IFI-2AS48098	0.126-0.187	3.2-4.8	0.387	9.8						
2-AS64		IFI-2AS48114	0.188-0.250	4.8-6.4	0.450	11.4						
2-AS66		IFI-2AS48146	0.251-0.375	6.4-9.5	0.575	14.6						
2-AS68		IFI-2AS48178	0.376-0.500	9.5-12.7	0.700	17.8						
2-AS610		IFI-2AS48210	0.501-0.625	12.7-15.9	0.825	21.0						
2-AS612		IFI-2AS48241	0.626-0.750	15.9-19.1	0.950	24.1						
2-AS614		IFI-2AS48273	0.751-0.875	19.1-22.2	1.075	27.3						
2-AS616		IFI-2AS48305	0.876-1.000	22.2-25.4	1.200	30.5						
2-AS618		IFI-2AS48337	1.001-1.125	25.4-28.6	1.325	33.7						
(1/4") 6.4mm	2-AS82	IFI-2AS64095	0.020-0.125	0.5-3.2	0.375	9.5	0.500" 12.7	0.080" 2.03	F 6.5-6.6	1.25" 32	460 2050N	560 2500N
	2-AS84	IFI-2AS64127	0.126-0.250	3.2-6.4	0.500	12.7						
	2-AS86	IFI-2AS64159	0.251-0.375	6.4-9.5	0.625	15.9						
	2-AS88	IFI-2AS64191	0.376-0.500	9.5-12.7	0.750	19.1						
	2-AS810	IFI-2AS64222	0.501-0.625	12.7-15.9	0.875	22.2						
	2-AS812	IFI-2AS64254	0.626-0.750	15.9-19.1	1.000	25.4						
	2-AS814	IFI-2AS64286	0.751-0.875	19.1-22.2	1.125	28.6						
	2-AS816	IFI-2AS64318	0.876-1.000	22.2-25.4	1.250	31.8						
	2-AS818	IFI-2AS64349	1.001-1.125	25.4-28.6	1.375	34.9						

# 5052 Aluminum & Carbon steel Open Type CSK Head

## Available Sizes

Φ2.4(3/32"), Φ3.2(1/8"), Φ4.0(3/16"),  
Φ4.8(3/16"), Φ6.4(1/4")

## Head Styles

CSK Head

## Materials

Body: Aluminum  
Mandrel: Carbon steel

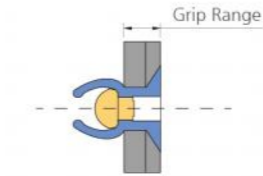
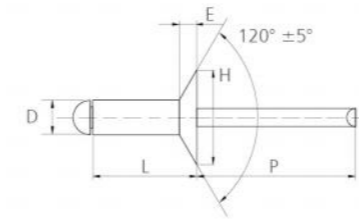

Material	Body	5052 Aluminum
	Mandrel	Carbon steel
Finish	Body	Polished
	Mandrel	Zinc Plated

D Nom.	Art. Code	Part. No	Grip Range		L(Max.)		H Nom.	E Ref.	Dirll No. & Hole Size	P Min.	Shear LBS	Tensile LBS
			Inch	mm	Inch	mm						
(3/32") 2.4mm	2-AS32C	IFI-2ASC24064	0.079-0.125	2.0-3.2	0.250	6.4	0.174" 4.4	0.027" 0.69	#41 2.5 - 2.6	1.00" 25.4	70 310N	80 360N
	2-AS34C	IFI-2ASC24095	0.126-0.250	3.2-6.4	0.375	9.5						
	2-AS36C	IFI-2ASC24127	0.251-0.375	6.4-9.5	0.500	12.7						
(1/8") 3.2mm	2-AS42C	IFI-2ASC32070	0.092-0.125	2.3-3.2	0.275	7.0	0.220" 5.6	0.031" 0.79	#30 3.3 - 3.4	1.06" 27	120 530N	150 670N
	2-AS43C	IFI-2ASC32086	0.126-0.187	3.2-4.8	0.337	8.6						
	2-AS44C	IFI-2ASC32102	0.188-0.250	4.8-6.4	0.400	10.2						
	2-AS45C	IFI-2ASC32117	0.251-0.312	6.4-7.9	0.462	11.7						
	2-AS46C	IFI-2ASC32133	0.313-0.375	7.9-9.5	0.525	13.3						
	2-AS48C	IFI-2ASC32165	0.376-0.500	9.5-12.7	0.650	16.5						
(5/32") 4.0mm	2-AS53C	IFI-2ASC40092	0.120-0.187	3.0-4.8	0.362	9.2	0.281" 7.1	0.040" 1.02	#20 4.1 - 4.2	1.06" 27	190 850N	230 1020N
	2-AS54C	IFI-2ASC40108	0.188-0.250	4.8-6.4	0.425	10.8						
	2-AS56C	IFI-2ASC40140	0.251-0.375	6.4-9.5	0.550	14.0						
	2-AS58C	IFI-2ASC40171	0.376-0.500	9.5-12.7	0.675	17.1						
(3/16") 4.8mm	2-AS63C	IFI-2ASC48098	0.151-0.187	3.8-4.8	0.387	9.8	0.348" 8.8	0.050" 1.27	#11 4.9 - 5.0	1.06" 27	260 1160N	320 1430N
	2-AS64C	IFI-2ASC48114	0.188-0.250	4.8-6.4	0.450	11.4						
	2-AS66C	IFI-2ASC48146	0.251-0.375	6.4-9.5	0.575	14.6						
	2-AS68C	IFI-2ASC48178	0.376-0.500	9.5-12.7	0.700	17.8						
	2-AS610C	IFI-2ASC48210	0.501-0.625	12.7-15.9	0.825	21.0						
(1/4") 6.4mm	2-AS84C	IFI-2ASC64127	0.126-0.250	3.2-6.4	0.500	12.7	0.470" 11.9	0.060" 1.52	F 6.5 - 6.6	1.25" 32	460 2050N	560 2500N
	2-AS86C	IFI-2ASC64159	0.251-0.375	6.4-9.5	0.625	15.9						
	2-AS88C	IFI-2ASC64191	0.376-0.500	9.5-12.7	0.750	19.1						

# 5052 Aluminum & Carbon steel Open Type Large Flange

## Available Sizes

Φ3.2(1/8"), Φ4.0(5/32"),  
Φ4.8(3/16")

## Head Styles

Large Flange

## Materials

Body: Aluminum  
Mandrel: Carbon steel



5052 Aluminum & Carbon steel Open Type Large Flange

RWMATE

Washen



Material	Body	5052 Aluminum
	Mandrel	Carbon steel
Finish	Body	Polished
	Mandrel	Zinc Plated

D Nom.	Art. Code	Part. No	Grip Range		L(Max.)		H Nom.	E Max.	Dirll No. & Hole Size	P Min.	Shear LBS	Tensile LBS
			Inch	mm	Inch	mm						
(1/8") 3.2mm	2-AS42LF	IFI-2ASLF3207010	0.062-0.125	1.6-3.2	0.275	7.0	0.375" 9.5	0.065" 1.65	#30 3.3 - 3.4	1.06" 27	120 530N	150 670N
	2-AS43LF	IFI-2ASLF3208610	0.126-0.187	3.2-4.8	0.337	8.6						
	2-AS44LF	IFI-2ASLF3210210	0.188-0.250	4.8-6.4	0.400	10.2						
	2-AS45LF	IFI-2ASLF3211710	0.251-0.312	6.4-7.9	0.462	11.7						
	2-AS46LF	IFI-2ASLF3213310	0.313-0.375	7.9-9.5	0.525	13.3						
	2-AS48LF	IFI-2ASLF3216510	0.376-0.500	9.5-12.7	0.650	16.5						
	2-AS410LF	IFI-2ASLF3219710	0.501-0.625	12.7-15.9	0.775	19.7						
(5/32") 4.0mm	2-AS52LF	IFI-2ASLF4007612	0.020-0.125	0.5-3.2	0.300	7.6	0.468" 12.0	0.075" 1.90	#20 4.1 - 4.2	1.06" 27	190 850N	230 1020N
	2-AS53LF	IFI-2ASLF4009212	0.126-0.187	3.2-4.8	0.362	9.2						
	2-AS54LF	IFI-2ASLF4010812	0.188-0.250	4.8-6.4	0.425	10.8						
	2-AS56LF	IFI-2ASLF4014012	0.251-0.375	6.4-9.5	0.550	14.0						
	2-AS58LF	IFI-2ASLF4017112	0.376-0.500	9.5-12.7	0.675	17.1						
	2-AS510LF	IFI-2ASLF4020312	0.501-0.625	12.7-15.9	0.800	20.3						
(3/16") 4.8mm	2-AS62LF	IFI-2ASLF4808316	0.020-0.125	0.5-3.2	0.325	8.3	0.625" 16.0	0.092" 2.33	#11 4.9 - 5.0	1.06" 27	260 1160N	320 1430N
	2-AS63LF	IFI-2ASLF4809816	0.126-0.187	3.2-4.8	0.387	9.8						
	2-AS64LF	IFI-2ASLF4811416	0.188-0.250	4.8-6.4	0.450	11.4						
	2-AS66LF	IFI-2ASLF4814616	0.251-0.375	6.4-9.5	0.575	14.6						
	2-AS68LF	IFI-2ASLF4817816	0.376-0.500	9.5-12.7	0.700	17.8						
	2-AS610LF	IFI-2ASLF4821016	0.501-0.625	12.7-15.9	0.825	21.0						
	2-AS612LF	IFI-2ASLF4824116	0.626-0.750	15.9-19.1	0.950	24.1						
	2-AS614LF	IFI-2ASLF4827316	0.751-0.875	19.1-22.2	1.075	27.3						
	2-AS616LF	IFI-2ASLF4830516	0.876-1.000	22.2-25.4	1.200	30.5						
	2-AS618LF	IFI-2ASLF4833716	1.001-1.125	25.4-28.6	1.325	33.7						

# Full Aluminum Open Type Dome Head

Full Aluminum Open Type Dome Head

RWMATE

Washen

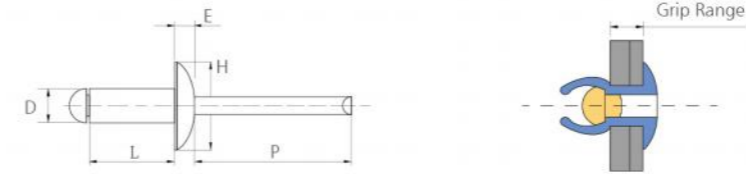

Material	Body	Aluminum
	Mandrel	Aluminum
Finish	Body	Polished
	Mandrel	Polished

## Available Sizes

Φ2.4(3/32"), Φ3.2(1/8"),  
Φ4.0(5/32"), Φ4.8(3/16"),  
Φ6.4(1/4")

## Head Styles

Dome Head

## Materials

Body: Aluminum  
Mandrel: Aluminum



D Nom.	Art. Code	Part. No	Grip Range		L(Max.)		H Nom.	E Max.	Dirll No. & Hole Size	P Min.	Shear LBS	Tensile LBS
			Inch	mm	Inch	mm						
(3/32") 2.4mm	AA32	IFI-AA24064	0.020-0.125	0.5-3.2	0.250	6.4	0.188" 4.8	0.032" 0.81	#41 2.5 - 2.6	1.00" 25.4	70 310N	80 360N
	AA34	IFI-AA24095	0.126-0.250	3.2-6.4	0.375	9.5						
	AA36	IFI-AA24127	0.251-0.375	6.4-9.5	0.500	12.7						
(1/8") 3.2mm	AA41	IFI-AA32054	0.020-0.062	0.5-1.6	0.212	5.4	0.250" 6.4	0.040" 1.02	#30 3.3 - 3.4	1.06" 27	120 530N	150 670N
	AA42	IFI-AA32070	0.063-0.125	1.6-3.2	0.275	7.0						
	AA43	IFI-AA32086	0.126-0.187	3.2-4.8	0.337	8.6						
	AA44	IFI-AA32102	0.188-0.250	4.8-6.4	0.400	10.2						
	AA45	IFI-AA32117	0.251-0.312	6.4-7.9	0.462	11.7						
	AA46	IFI-AA32133	0.313-0.375	7.9-9.5	0.525	13.3						
	AA48	IFI-AA32165	0.376-0.500	9.5-12.7	0.650	16.5						
	AA410	IFI-AA32197	0.501-0.625	12.7-15.9	0.775	19.7						
(5/32") 4.0mm	AA52	IFI-AA40076	0.020-0.125	0.5-3.2	0.300	7.6	0.312" 7.9	0.050" 1.27	#20 4.1 - 4.2	1.06" 27	190 850N	230 1020N
	AA53	IFI-AA40092	0.126-0.187	3.2-4.8	0.362	9.2						
	AA54	IFI-AA40108	0.188-0.250	4.8-6.4	0.425	10.8						
	AA56	IFI-AA40140	0.251-0.375	6.4-9.5	0.550	14.0						
	AA58	IFI-AA40171	0.376-0.500	9.5-12.7	0.675	17.1						
	AA510	IFI-AA40203	0.501-0.625	12.7-15.9	0.800	20.3						
	AA516	IFI-AA40298	0.876-1.000	22.2-25.4	1.175	29.8						
(3/16") 4.8mm	AA62	IFI-AA48083	0.020-0.125	0.5-3.2	0.325	8.3	0.375" 9.5	0.060" 1.52	#11 4.9 - 5.0	1.06" 27	260 1160N	320 1430N
	AA63	IFI-AA48098	0.126-0.187	3.2-4.8	0.387	9.8						
	AA64	IFI-AA48114	0.188-0.250	4.8-6.4	0.450	11.4						
	AA66	IFI-AA48146	0.251-0.375	6.4-9.5	0.575	14.6						
	AA68	IFI-AA48178	0.376-0.500	9.5-12.7	0.700	17.8						
	AA610	IFI-AA48210	0.501-0.625	12.7-15.9	0.825	21.0						
	AA612	IFI-AA48241	0.626-0.750	15.9-19.1	0.950	24.1						
	AA614	IFI-AA48273	0.751-0.875	19.1-22.2	1.075	27.3						
	AA616	IFI-AA48305	0.876-1.000	22.2-25.4	1.200	30.5						
	AA618	IFI-AA48337	1.001-1.125	25.4-28.6	1.325	33.7						
(1/4") 6.4mm	AA620	IFI-AA48368	1.126-1.250	28.6-31.8	1.450	36.8	0.500" 12.7	0.080" 2.03	F 6.5 - 6.6	1.25" 32	460 2050N	560 2500N
	AA82	IFI-AA64095	0.020-0.125	0.5-3.2	0.375	9.5						
	AA84	IFI-AA64127	0.126-0.250	3.2-6.4	0.500	12.7						
	AA86	IFI-AA64159	0.251-0.375	6.4-9.5	0.625	15.9						
	AA88	IFI-AA64191	0.376-0.500	9.5-12.7	0.750	19.1						
	AA810	IFI-AA64222	0.501-0.625	12.7-15.9	0.875	22.2						
	AA812	IFI-AA64254	0.626-0.750	15.9-19.1	1.000	25.4						
	AA814	IFI-AA64286	0.751-0.875	19.1-22.2	1.125	28.6						
	AA816	IFI-AA64318	0.876-1.000	22.2-25.4	1.250	31.8						
	AA818	IFI-AA64349	1.001-1.125	25.4-28.6	1.375	34.9						

# Full Stainless Steel Open Type Dome Head

## Available Sizes

Φ3.2(1/8"), Φ4.0(3/16"),  
Φ4.8(3/16"), Φ6.4(1/4")

## Head Styles

Dome Head

## Materials

Body:304 Stainless Steel  
Mandrel:304 Stainless Steel



Scan to View Test Video  
(All Stainless Steel Open Type BB66)  
In Youtube

Full Stainless Steel Open Type Dome Head

RVMATE

Washen

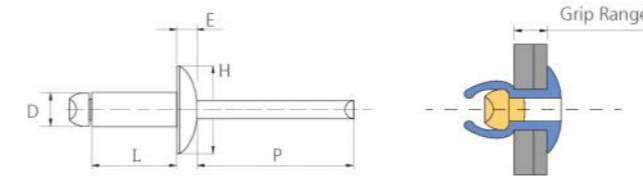

Material	Body	304 Stainless Steel
	Mandrel	304 Stainless Steel
Finish	Body	Polished
	Mandrel	Polished

D Nom.	Art.Code	Part.No	Grip Range		L(Max.)		H Nom.	E Max.	Dirll No.& Hole Size	P Min.	Shear LBS	Tensile LBS
			Inch	mm	Inch	mm						
(1/8") 3.2mm	BB41	IFI-BB32054	0.020-0.062	0.5-1.6	0.212	5.4	0.238-0.262" 6.05-6.65	0.040" 1.02	#30 3.3 - 3.4	1.06" 27	420 1870N	530 2360N
	BB42	IFI-BB32070	0.063-0.125	1.6-3.2	0.275	7.0						
	BB43	IFI-BB32086	0.126-0.187	3.2-4.8	0.337	8.6						
	BB44	IFI-BB32102	0.188-0.250	4.8-6.4	0.400	10.2						
	BB45	IFI-BB32117	0.251-0.312	6.4-7.9	0.462	11.7						
	BB46	IFI-BB32133	0.313-0.375	7.9-9.5	0.525	13.3						
	BB48	IFI-BB32165	0.376-0.500	9.5-12.7	0.650	16.5						
(5/32") 4.0mm	BB52	IFI-BB40076	0.020-0.125	0.5-3.2	0.300	7.6	0.296-0.328" 7.52-8.3	0.050" 1.27	#20 4.1 - 4.2	1.06" 27	650 2900N	820 3650N
	BB53	IFI-BB40092	0.126-0.187	3.2-4.8	0.362	9.2						
	BB54	IFI-BB40108	0.188-0.250	4.8-6.4	0.425	10.8						
	BB56	IFI-BB40140	0.251-0.375	6.4-9.5	0.550	14.0						
	BB58	IFI-BB40171	0.376-0.500	9.5-12.7	0.675	17.1						
	BB510	IFI-BB40203	0.501-0.625	12.7-15.9	0.800	20.3						
(3/16") 4.8mm	BB62	IFI-BB48083	0.020-0.125	0.5-3.2	0.325	8.3	0.356-0.394" 9.04-10.0	0.060" 1.52	#11 4.9 - 5.0	1.06" 27	950 4230N	1200 5340N
	BB63	IFI-BB48098	0.126-0.187	3.2-4.8	0.387	9.8						
	BB64	IFI-BB48114	0.188-0.250	4.8-6.4	0.450	11.4						
	BB66	IFI-BB48146	0.251-0.375	6.4-9.5	0.575	14.6						
	BB68	IFI-BB48178	0.376-0.500	9.5-12.7	0.700	17.8						
	BB610	IFI-BB48210	0.501-0.625	12.7-15.9	0.825	21.0						
	BB612	IFI-BB48241	0.626-0.750	15.9-19.1	0.950	24.1						
	BB614	IFI-BB48273	0.751-0.875	19.1-22.2	1.075	27.3						
	BB616	IFI-BB48305	0.876-1.000	22.2-25.4	1.200	30.5						
(1/4") 6.4mm	BB84	IFI-BB64127	0.126-0.250	3.2-6.4	0.500	12.7	0.475-0.525" 12.06-13.3	0.080" 2.03	F 6.5 - 6.6	1.25" 32	1700 7570N	2100 9350N
	BB86	IFI-BB64159	0.251-0.375	6.4-9.5	0.625	15.9						
	BB88	IFI-BB64191	0.376-0.500	9.5-12.7	0.750	19.1						
	BB810	IFI-BB64222	0.501-0.625	12.7-15.9	0.875	22.2						
	BB812	IFI-BB64254	0.626-0.750	15.9-19.1	1.000	25.4						

# Full Stainless Steel Open Type CSK Head

## Available Sizes

Φ3.2(1/8"), Φ4.0(5/32"),  
Φ4.8(3/16")

## Head Styles

CSK Head

## Materials

Body:304 Stainless Steel  
Mandrel:304 Stainless Steel



Full Stainless Steel Open Type CSK Head

RWMATE

Washen

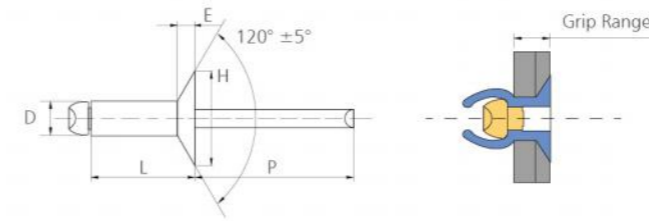

Material	Body	304 Stainless Steel
	Mandrel	304 Stainless Steel
Finish	Body	Polished
	Mandrel	Polished

D Nom.	Art.Code	Part.No	Grip Range		L(Max.)		H Nom.	E Ref.	Dirll No.& Hole Size	P Min.	Shear LBS	Tensile LBS
			Inch	mm	Inch	mm						
(1/8") 3.2mm	BBC42	IFI-BBC32070	0.092-0.125	2.3-3.2	0.275	7.0	0.220" 5.6	0.031" 0.79	#30 3.3 - 3.4	1.06" 27	420 1870N	530 2360N
	BBC43	IFI-BBC32086	0.126-0.187	3.2-4.8	0.337	8.6						
	BBC44	IFI-BBC32102	0.188-0.250	4.8-6.4	0.400	10.2						
	BBC45	IFI-BBC32117	0.251-0.312	6.4-7.9	0.462	11.7						
	BBC46	IFI-BBC32133	0.313-0.375	7.9-9.5	0.525	13.3						
	BBC48	IFI-BBC32165	0.376-0.500	9.5-12.7	0.650	16.5						
(5/32") 4.0mm	BBC53	IFI-BBC40092	0.120-0.187	3.0-4.8	0.362	9.2	0.281" 7.1	0.040" 1.02	#20 4.1 - 4.2	1.06" 27	650 2900N	820 3650N
	BBC54	IFI-BBC40108	0.188-0.250	4.8-6.4	0.425	10.8						
	BBC56	IFI-BBC40140	0.251-0.375	6.4-9.5	0.550	14.0						
	BBC58	IFI-BBC40171	0.376-0.500	9.5-12.7	0.675	17.1						
(3/16") 4.8mm	BBC63	IFI-BBC48098	0.151-0.187	3.8-4.8	0.387	9.8	0.348" 8.8	0.050" 1.27	#11 4.9 - 5.0	1.06" 27	950 4230N	1200 5340N
	BBC64	IFI-BBC48114	0.188-0.250	4.8-6.4	0.450	11.4						
	BBC66	IFI-BBC48146	0.251-0.375	6.4-9.5	0.575	14.6						
	BBC68	IFI-BBC48178	0.376-0.500	9.5-12.7	0.700	17.8						
	BBC610	IFI-BBC48210	0.501-0.625	12.7-15.9	0.825	21.0						

# Full Stainless Steel Open Type Large Flange

## Available Sizes

Φ3.2(1/8"), Φ4.0(5/32"),  
Φ4.8(3/16")

## Head Styles

Large Flange

## Materials

Body:304 Stainless Steel  
Mandrel:304 Stainless Steel



Full Stainless Steel Open Type Large Flange

RWMATE

Washen

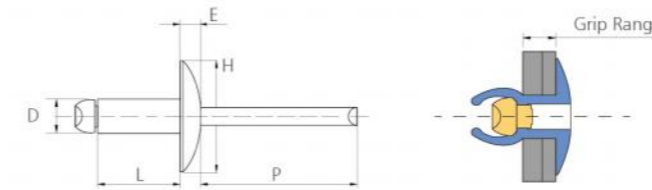

Material	Body	304 Stainless Steel
	Mandrel	304 Stainless Steel
Finish	Body	Polished
	Mandrel	Polished

D Nom.	Art.Code	Part.No	Grip Range		L(Max.)		H Nom.	E Max.	Dirll No.& Hole Size	P Min.	Shear LBS	Tensile LBS
			Inch	mm	Inch	mm						
(1/8") 3.2mm	BBLF42	IFI-BBLF3207010	0.063-0.125	1.6-3.2	0.275	7.0	0.375" 9.5	0.065" 1.65	#30 3.3 - 3.4	1.06" 27	420 1870N	530 2360N
	BBLF43	IFI-BBLF3208610	0.126-0.187	3.2-4.8	0.337	8.6						
	BBLF44	IFI-BBLF3210210	0.188-0.250	4.8-6.4	0.400	10.2						
	BBLF45	IFI-BBLF3211710	0.251-0.312	6.4-7.9	0.462	11.7						
	BBLF46	IFI-BBLF3213310	0.313-0.375	7.9-9.5	0.525	13.3						
	BBLF48	IFI-BBLF3216510	0.376-0.500	9.5-12.7	0.650	16.5						
(5/32") 4.0mm	BBLF52	IFI-BBLF4007612	0.020-0.125	0.5-3.2	0.300	7.6	0.468" 12.0	0.075" 1.90	#20 4.1 - 4.2	1.06" 27	650 2900N	820 3650N
	BBLF53	IFI-BBLF4009212	0.126-0.187	3.2-4.8	0.362	9.2						
	BBLF54	IFI-BBLF4010812	0.188-0.250	4.8-6.4	0.425	10.8						
	BBLF56	IFI-BBLF4014012	0.251-0.375	6.4-9.5	0.550	14.0						
	BBLF58	IFI-BBLF4017112	0.376-0.500	9.5-12.7	0.675	17.1						
	BBLF510	IFI-BBLF4020312	0.501-0.625	12.7-15.9	0.800	20.3						
(3/16") 4.8mm	BBLF62	IFI-BBLF4808316	0.020-0.125	0.5-3.2	0.325	8.3	0.625" 16.0	0.092" 2.33	#11 4.9 - 5.0	1.06" 27	950 4230N	1200 5340N
	BBLF63	IFI-BBLF4809816	0.126-0.187	3.2-4.8	0.387	9.8						
	BBLF64	IFI-BBLF4811416	0.188-0.250	4.8-6.4	0.450	11.4						
	BBLF66	IFI-BBLF4814616	0.251-0.375	6.4-9.5	0.575	14.6						
	BBLF68	IFI-BBLF4817816	0.376-0.500	9.5-12.7	0.700	17.8						
	BBLF610	IFI-BBLF4821016	0.501-0.625	12.7-15.9	0.825	21.0						
	BBLF612	IFI-BBLF4824116	0.626-0.750	15.9-19.1	0.950	24.1						
	BBLF614	IFI-BBLF4827316	0.751-0.875	19.1-22.2	1.075	27.3						
	BBLF616	IFI-BBLF4830516	0.876-1.000	22.2-25.4	1.200	30.5						
	BBLF618	IFI-BBLF4833716	1.001-1.125	25.4-28.6	1.325	33.7						

# Full Steel Open Type Dome Head



Scan to View Test Video  
(All Carbon Steel Open Type SS64)  
In Youtube

Full Steel Open Type Dome Head

RWMATE

Washen

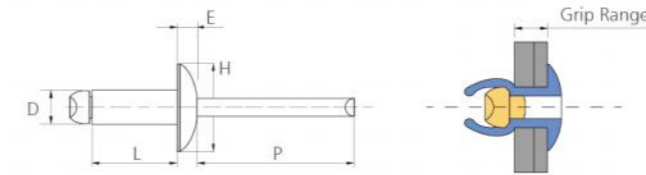

Material	Body	Carbon Steel
	Mandrel	Carbon Steel
Finish	Body	Zinc Plated
	Mandrel	Zinc Plated

## Available Sizes

Φ2.4(3/32"), Φ3.2(1/8"),  
Φ4.0(5/32"), Φ4.8(3/16"),  
Φ6.4(1/4")

## Head Styles

Dome Head

## Materials

Body: Carbon Steel  
Mandrel: Carbon Steel



D Nom.	Art. Code	Part. No	Grip Range		L(Max.)		H Nom.	E Max.	Dirll No. & Hole Size	P Min.	Shear LBS	Tensile LBS
			Inch	mm	Inch	mm						
(3/32") 2.4mm	SS32	IFI-SS24064	0.020-0.125	0.5-3.2	0.250	6.4	0.188" 4.8	0.032" 0.81	#41 2.5 - 2.6	1.00" 25.4	130 580N	170 760N
	SS34	IFI-SS24095	0.126-0.250	3.2-6.4	0.375	9.5						
	SS36	IFI-SS24127	0.251-0.375	6.4-9.5	0.500	12.7						
(1/8") 3.2mm	SS41	IFI-SS32054	0.020-0.062	0.5-1.6	0.212	5.4	0.250" 6.4	0.040" 1.02	#30 3.3 - 3.4	1.06" 27	260 1160N	310 1380N
	SS42	IFI-SS32070	0.063-0.125	1.6-3.2	0.275	7.0						
	SS43	IFI-SS32086	0.126-0.187	3.2-4.8	0.337	8.6						
	SS44	IFI-SS32102	0.188-0.250	4.8-6.4	0.400	10.2						
	SS45	IFI-SS32117	0.251-0.312	6.4-7.9	0.462	11.7						
	SS46	IFI-SS32133	0.313-0.375	7.9-9.5	0.525	13.3						
	SS48	IFI-SS32165	0.376-0.500	9.5-12.7	0.650	16.5						
	SS410	IFI-SS32197	0.501-0.625	12.7-15.9	0.775	19.7						
(5/32") 4.0mm	SS52	IFI-SS40076	0.020-0.125	0.5-3.2	0.300	7.6	0.312" 7.9	0.050" 1.27	#20 4.1 - 4.2	1.06" 27	370 1650N	470 2100N
	SS53	IFI-SS40092	0.126-0.187	3.2-4.8	0.362	9.2						
	SS54	IFI-SS40108	0.188-0.250	4.8-6.4	0.425	10.8						
	SS56	IFI-SS40140	0.251-0.375	6.4-9.5	0.550	14.0						
	SS58	IFI-SS40171	0.376-0.500	9.5-12.7	0.675	17.1						
	SS510	IFI-SS40203	0.501-0.625	12.7-15.9	0.800	20.3						
(3/16") 4.8mm	SS516	IFI-SS40298	0.876-1.000	22.2-25.4	1.175	29.8	0.375" 9.5	0.060" 1.52	#11 4.9 - 5.0	1.06" 27	540 2400N	680 3030N
	SS62	IFI-SS48083	0.020-0.125	0.5-3.2	0.325	8.3						
	SS63	IFI-SS48098	0.126-0.187	3.2-4.8	0.387	9.8						
	SS64	IFI-SS48114	0.188-0.250	4.8-6.4	0.450	11.4						
	SS66	IFI-SS48146	0.251-0.375	6.4-9.5	0.575	14.6						
	SS68	IFI-SS48178	0.376-0.500	9.5-12.7	0.700	17.8						
	SS610	IFI-SS48210	0.501-0.625	12.7-15.9	0.825	21.0						
	SS612	IFI-SS48241	0.626-0.750	15.9-19.1	0.950	24.1						
	SS614	IFI-SS48273	0.751-0.875	19.1-22.2	1.075	27.3						
	SS616	IFI-SS48305	0.876-1.000	22.2-25.4	1.200	30.5						
(1/4") 6.4mm	SS618	IFI-SS48337	1.001-1.125	25.4-28.6	1.325	33.7	0.500" 12.7	0.080" 2.03	F 6.5 - 6.6	1.25" 32	1000 4450N	1240 5520N
	SS620	IFI-SS48368	1.126-1.250	28.6-31.8	1.450	36.8						
	SS82	IFI-SS64095	0.020-0.125	0.5-3.2	0.375	9.5						
	SS84	IFI-SS64127	0.126-0.250	3.2-6.4	0.500	12.7						
	SS86	IFI-SS64159	0.251-0.375	6.4-9.5	0.625	15.9						
	SS88	IFI-SS64191	0.376-0.500	9.5-12.7	0.750	19.1						
	SS810	IFI-SS64222	0.501-0.625	12.7-15.9	0.875	22.2						
	SS812	IFI-SS64254	0.626-0.750	15.9-19.1	1.000	25.4						
	SS814	IFI-SS64286	0.751-0.875	19.1-22.2	1.125	28.6						
	SS816	IFI-SS64318	0.876-1.000	22.2-25.4	1.250	31.8						
SS818	IFI-SS64349	1.001-1.125	25.4-28.6	1.375	34.9							

# Full Steel Open Type CSK Head

## Available Sizes

Φ3.2(1/8"), Φ4.0(5/32"),  
Φ4.8(3/16"), Φ6.4(1/4")

## Head Styles

Csk Head

## Materials

Body: Carbon Steel  
Mandrel: Carbon Steel



Full Steel Open Type CSK Type

RWMATE

Washen

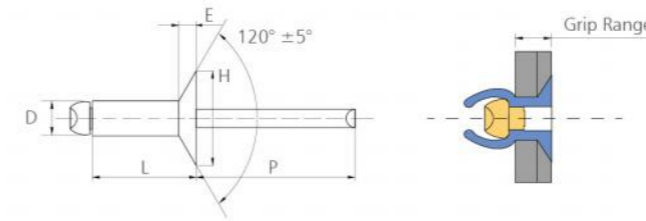

Material	Body	Carbon Steel
	Mandrel	Carbon Steel
Finish	Body	Zinc Plated
	Mandrel	Zinc Plated

D Nom.	Art.Code	Part.No	Grip Range		L(Max.)		H Nom.	E Ref.	Dirll No. & Hole Size	P Min.	Shear LBS	Tensile LBS
			Inch	mm	Inch	mm						
(1/8") 3.2mm	SSC42	IFI-SSC32070	0.092-0.125	2.3-3.2	0.275	7.0	0.220" 5.6	0.031" 0.79	#30 3.3 - 3.4	1.06" 27	260 1160N	310 1380N
	SSC43	IFI-SSC32086	0.126-0.187	3.2-4.8	0.337	8.6						
	SSC44	IFI-SSC32102	0.188-0.250	4.8-6.4	0.400	10.2						
	SSC45	IFI-SSC32117	0.251-0.312	6.4-7.9	0.462	11.7						
	SSC46	IFI-SSC32133	0.313-0.375	7.9-9.5	0.525	13.3						
	SSC48	IFI-SSC32165	0.376-0.500	9.5-12.7	0.650	16.5						
(5/32") 4.0mm	SSC53	IFI-SSC40092	0.120-0.187	3.0-4.8	0.362	9.2	0.281" 7.1	0.040" 1.02	#20 4.1 - 4.2	1.06" 27	370 1650N	470 2100N
	SSC54	IFI-SSC40108	0.188-0.250	4.8-6.4	0.425	10.8						
	SSC56	IFI-SSC40140	0.251-0.375	6.4-9.5	0.550	14.0						
	SSC58	IFI-SSC40171	0.376-0.500	9.5-12.7	0.675	17.1						
(3/16") 4.8mm	SSC63	IFI-SSC48098	0.151-0.187	3.8-4.8	0.387	9.8	0.348" 8.8	0.050" 1.27	#11 4.9 - 5.0	1.06" 27	540 2400N	680 3030N
	SSC64	IFI-SSC48114	0.188-0.250	4.8-6.4	0.450	11.4						
	SSC66	IFI-SSC48146	0.251-0.375	6.4-9.5	0.575	14.6						
	SSC68	IFI-SSC48178	0.376-0.500	9.5-12.7	0.700	17.8						
	SSC610	IFI-SSC48210	0.501-0.625	12.7-15.9	0.825	21.0						
(1/4") 6.4mm	SSC84	IFI-SSC64127	0.125-0.250	3.2-6.4	0.500	12.7	0.470" 19.1	0.060" 1.52	F 6.5 - 6.6	1.25" 32	1000 4450N	1240 5520N
	SSC86	IFI-SSC64159	0.251-0.375	6.4-9.5	0.625	15.9						
	SSC88	IFI-SSC64191	0.376-0.500	9.5-12.7	0.750	19.1						

# Full Steel Open Type Large Flange

## Available Sizes

Φ3.2(1/8"), Φ4.0(5/32"),  
Φ4.8(3/16")

## Head Styles

Large Flange

## Materials

Body: Carbon Steel  
Mandrel: Carbon Steel



Full Steel Open Type Large Flange

RWMATE

Washen

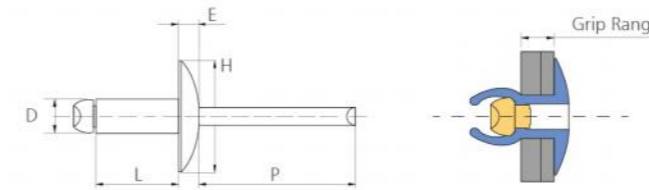

Material	Body	Carbon Steel
	Mandrel	Carbon Steel
Finish	Body	Zinc Plated
	Mandrel	Zinc Plated

D Nom.	Art. Code	Part. No	Grip Range		L(Max.)		H Nom.	E Max.	Dirll No. & Hole Size	P Min.	Shear LBS	Tensile LBS
			Inch	mm	Inch	mm						
(1/8") 3.2mm	SSLF42	IFI-SSLF3207010	0.063-0.125	1.6-3.2	0.275	7.0	0.375" 9.5	0.065" 1.65	#30 3.3 - 3.4	1.06" 27	260 1160N	310 1380N
	SSLF43	IFI-SSLF3208610	0.126-0.187	3.2-4.8	0.337	8.6						
	SSLF44	IFI-SSLF3210210	0.188-0.250	4.8-6.4	0.400	10.2						
	SSLF45	IFI-SSLF3211710	0.251-0.312	6.4-7.9	0.462	11.7						
	SSLF46	IFI-SSLF3213310	0.313-0.375	7.9-9.5	0.525	13.3						
	SSLF48	IFI-SSLF3216510	0.376-0.500	9.5-12.7	0.650	16.5						
	SSLF410	IFI-SSLF3219710	0.501-0.625	12.7-15.9	0.775	19.7						
(5/32") 4.0mm	SSLF52	IFI-SSLF4007612	0.020-0.125	0.5-3.2	0.300	7.6	0.468" 12.0	0.075" 1.90	#20 4.1 - 4.2	1.06" 27	370 1650N	470 2100N
	SSLF53	IFI-SSLF4009212	0.126-0.187	3.2-4.8	0.362	9.2						
	SSLF54	IFI-SSLF4010812	0.188-0.250	4.8-6.4	0.425	10.8						
	SSLF56	IFI-SSLF4014012	0.251-0.375	6.4-9.5	0.550	14.0						
	SSLF58	IFI-SSLF4017112	0.376-0.500	9.5-12.7	0.675	17.1						
	SSLF510	IFI-SSLF4020312	0.501-0.625	12.7-15.9	0.800	20.3						
(3/16") 4.8mm	SSLF62	IFI-SSLF4808316	0.020-0.125	0.5-3.2	0.325	8.3	0.625" 16.0	0.092" 2.33	#11 4.9 - 5.0	1.06" 27	540 2400N	680 3030N
	SSLF63	IFI-SSLF4809816	0.126-0.187	3.2-4.8	0.387	9.8						
	SSLF64	IFI-SSLF4811416	0.188-0.250	4.8-6.4	0.450	11.4						
	SSLF66	IFI-SSLF4814616	0.251-0.375	6.4-9.5	0.575	14.6						
	SSLF68	IFI-SSLF4817816	0.376-0.500	9.5-12.7	0.700	17.8						
	SSLF610	IFI-SSLF4821016	0.501-0.625	12.7-15.9	0.825	21.0						
	SSLF612	IFI-SSLF4824116	0.626-0.750	15.9-19.1	0.950	24.1						
	SSLF614	IFI-SSLF4827316	0.751-0.875	19.1-22.2	1.075	27.3						
	SSLF616	IFI-SSLF4830516	0.876-1.000	22.2-25.4	1.200	30.5						
	SSLF618	IFI-SSLF4833716	1.001-1.125	25.4-28.6	1.325	33.7						

# Open Type Blind Rivet (Monel & Carbon steel/ Stainless steel)

## Available Sizes

Φ3.2(1/8"), Φ4.0(5/32"),  
Φ4.8(3/16")

## Head Styles

Dome Head  
Csk Head

## Materials

Body: Monel  
Mandrel: Carbon steel/Stainless steel



Open Type Blind Rivet (Monel series)

RWMATE

Washen

## Open Type Blind Rivet (Monel & Carbon steel/Stainless steel)

Mandrel	Material	Carbon steel/Stainless steel
	Surface	Zinc plated/Polished
Body	Material	Monel
	Surface	Polished

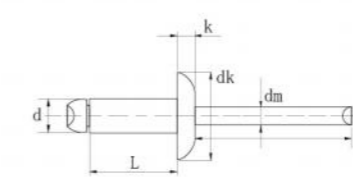

Dome Head

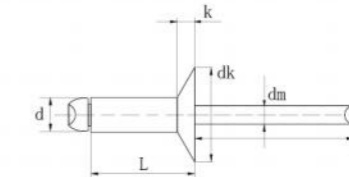

Countersunk Head

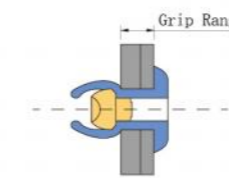

SS

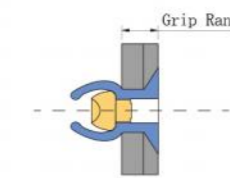

SSC

Diameter [d]	Part No.	Size	Body Length [L] (nom.)	Grip Range	Drill	Dome Head (Max)		Csk Head (Max)		Large Head (Max)		Mandrel Dia [dm] (max.)	Mandrel Reveal [P] (min.)	Typical Ultimate Strength	
						dk	k	dk	k	dk	k			Tensile	Shear
3.2 (1/8")	MS32060 MSC32060	3.2×6.0	6.0-7.0	1.5-3.5											
	MS32080 MSC32080	3.2×8.0	8.0-9.0	3.0-5.0											
	MS32100 MSC32100	3.2×10.0	10.0-11.0	5.0-7.0											
	MS32120 MSC32120	3.2×12.0	12.0-13.0	7.0-9.0	3.3-3.4	6.7	1.3	6.7	1.3	/	/	2.1	27.0	1920N	1530N
	MS32140 MSC32140	3.2×14.0	14.0-15.0	9.0-11.0											
	MS32160 MSC32160	3.2×16.0	16.0-17.0	11.0-13.0											
	MS32180 MSC32180	3.2×18.0	18.0-19.0	13.0-15.0											

# Open Type Blind Rivet (Monel & Carbon steel/ Stainless steel)

## Available Sizes

Φ3.2(1/8"), Φ4.0(5/32"),  
Φ4.8(3/16")

## Head Styles

Dome Head  
Csk Head

## Materials

Body: Monel  
Mandrel: Carbon steel/Stainless steel



Open Type Blind Rivet (Monel series)

RWMATE

Washen

Units: mm

Diameter [d]	Part No.	Size	Body Length [L] (nom.)	Grip Range	Drill	Dome Head (Max)		Csk Head (Max)		Large Head (Max)		Mandrel Dia [dm] (max.)	Mandrel Reveal [P] (min.)	Typical Ultimate Strength	
						dk	k	dk	k	dk	k			Tensile	Shear
4.0 (5/32")	MS40060 MSC40060	4.0×6.0	6.0-7.0	0.5-2.5	4.1-4.2	8.5	1.7	8.5	1.7	/	/	2.6	27.0	3050N	2220N
	MS40080 MSC40080	4.0×8.0	8.0-9.0	2.5-4.5											
	MS40100 MSC40100	4.0×10.0	10.0-11.0	4.5-6.5											
	MS40120 MSC40120	4.0×12.0	12.0-13.0	6.5-8.5											
	MS40140 MSC40140	4.0×14.0	14.0-15.0	8.5-10.5											
	MS40160 MSC40160	4.0×16.0	16.0-17.00	10.5-12.5											
	MS40180 MSC40180	4.0×18.0	18.0-19.0	12.5-14.5											
	MS40200 MSC40200	4.0×20.0	20.0-21.0	14.5-16.5											
4.8 (3/16")	MS48060 MSC48060	4.8×6.0	6.0-7.0	1.0-2.5	4.9-5.0	10.1	2.0	10.1	2.0	/	/	3.1	27.0	3700N	3300N
	MS48080 MSC48080	4.8×8.0	8.0-9.0	2.5-4.5											
	MS48100 MSC48100	4.8×10.0	10.0-11.0	4.0-6.0											
	MS48120 MSC48120	4.8×12.0	12.0-13.0	6.0-8.0											
	MS48140 MSC48140	4.8×14.0	14.0-15.0	8.0-10.0											
	MS48160 MSC48160	4.8×16.0	16.0-17.0	10.0-11.5											
	MS48180 MSC48180	4.8×18.0	18.0-19.0	11.5-13.5											
	MS48200 MSC48200	4.8×20.0	20.0-21.0	13.5-15.0											
	MS48250 MSC48250	4.8×25.0	25.0-26.0	17.0-20.0											
	MS48300 MSC48300	4.8×30.0	30.0-31.0	20.0-25.0											

# Aluminum&Steel Sealed Type Dome Head



Scan to View Test Video  
(5%Mg Aluminum / Steel Sealed Type ASF63)  
In Youtube

Aluminum&Steel Sealed Type Dome Head

RVMATE

Washen

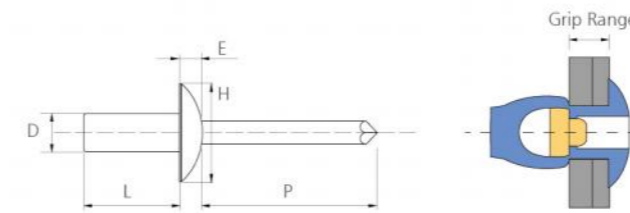

Material	Body	Aluminum
	Mandrel	Steel
Finish	Body	Polished
	Mandrel	Phosphate

## Available Sizes

Φ3.2(1/8"), Φ4.0(5/32"),  
Φ4.8(3/16"), Φ6.4(1/4")

## Head Styles

Dome Head

## Materials

Body:Aluminum  
Mandrel:Steel



D Nom.	Art.Code	Part.No	Grip Range		L(Max.)		H Nom.	E Max.	Dirll No. & Hole Size	P Min.	Shear LBS	Tensile LBS
			Inch	mm	Inch	mm						
(1/8") 3.2mm	ASF41	IFI-ASF32075	0.020-0.062	0.5-1.6	0.297	7.5	0.238" 6.0	0.050" 1.27	#30 3.3 - 3.4	1.06" 27	240 1070N	280 1250N
	ASF42	IFI-ASF32091	0.063-0.125	1.6-3.2	0.360	9.1						
	ASF43	IFI-ASF32107	0.126-0.187	3.2-4.8	0.422	10.7						
	ASF44	IFI-ASF32123	0.188-0.250	4.8-6.4	0.485	12.3						
	ASF45	IFI-ASF32139	0.251-0.312	6.4-7.9	0.547	13.9						
	ASF46	IFI-ASF32155	0.313-0.375	7.9-9.5	0.610	15.5						
(5/32") 4.0mm	ASF52	IFI-ASF40095	0.020-0.125	0.5-3.2	0.375	9.5	0.312" 7.9	0.065" 1.65	#20 4.1 - 4.2	1.06" 27	350 1560N	480 2140N
	ASF53	IFI-ASF40111	0.126-0.187	3.2-4.8	0.437	11.1						
	ASF54	IFI-ASF40127	0.188-0.250	4.8-6.4	0.500	12.7						
	ASF55	IFI-ASF40143	0.251-0.312	6.4-7.9	0.562	14.3						
	ASF56	IFI-ASF40159	0.313-0.375	7.9-9.5	0.625	15.9						
(3/16") 4.8mm	ASF62	IFI-ASF48103	0.020-0.125	0.5-3.2	0.406	10.3	0.375" 9.5	0.080" 2.03	#11 4.9 - 5.0	1.06" 27	500 2230N	690 3070N
	ASF63	IFI-ASF48119	0.126-0.187	3.2-4.8	0.468	11.9						
	ASF64	IFI-ASF48135	0.188-0.250	4.8-6.4	0.531	13.5						
	ASF66	IFI-ASF48167	0.251-0.375	6.4-9.5	0.656	16.7						
	ASF68	IFI-ASF48198	0.376-0.500	9.5-12.7	0.781	19.8						
	ASF610	IFI-ASF48230	0.501-0.625	12.7-15.9	0.906	23.0						
	ASF612	IFI-ASF48261	0.626-0.750	15.9-19.1	1.026	26.1						
(1/4") 6.4mm	ASF82	IFI-ASF64113	0.020-0.125	0.5-3.2	0.445	11.3	0.500" 12.7	0.100" 2.54	F 6.5 - 6.6	1.25" 32	900 4000N	1100 4890N
	ASF84	IFI-ASF64145	0.126-0.250	3.2-6.4	0.570	14.5						
	ASF86	IFI-ASF64177	0.251-0.375	6.4-9.5	0.695	17.7						
	ASF88	IFI-ASF64208	0.376-0.500	9.5-12.7	0.820	20.8						
	ASF810	IFI-ASF64240	0.501-0.625	12.7-15.9	0.945	24.0						

# Aluminum&Steel Sealed Type CSK Head

## Available Sizes

Φ3.2(1/8"), Φ4.0(5/32"),  
Φ4.8(3/16"), Φ6.4(1/4")

## Head Styles

Csk Head

## Materials

Body:Aluminum  
Mandrel:Steel



Aluminum&Steel Sealed Type CSK Type

RWMATE

Washen

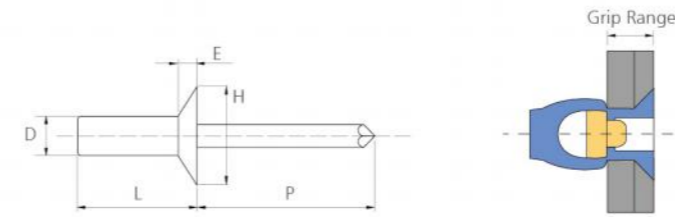

Material	Body	Aluminum
	Mandrel	Steel
Finish	Body	Polished
	Mandrel	Phosphated

D Nom.	Art.Code	Part.No	Grip Range		L(Max.)		H Nom.	E Ref.	Dirll No. & Hole Size	P Min.	Shear LBS	Tensile LBS
			Inch	mm	Inch	mm						
(1/8") 3.2mm	ASFC42	IFI-ASFC32100	0.063-0.125	1.6-3.2	0.395	10.0	0.233" 5.9	0.042" 1.07	#30 3.3 - 3.4	1.06" 27	240 1070N	280 1250N
	ASFC43	IFI-ASFC32116	0.126-0.187	3.2-4.8	0.457	11.6						
	ASFC44	IFI-ASFC32132	0.188-0.250	4.8-6.4	0.520	13.2						
	ASFC45	IFI-ASFC32148	0.251-0.312	6.4-7.9	0.582	14.8						
	ASFC46	IFI-ASFC32164	0.313-0.375	7.9-9.5	0.645	16.4						
(5/32") 4.0mm	ASFC52	IFI-ASFC40108	0.063-0.125	1.6-3.2	0.425	10.8	0.312" 7.9	0.051" 1.29	#20 4.1 - 4.2	1.06" 27	350 1560N	480 2140N
	ASFC53	IFI-ASFC40124	0.126-0.187	3.2-4.8	0.487	12.4						
	ASFC54	IFI-ASFC40140	0.188-0.250	4.8-6.4	0.550	14.0						
	ASFC55	IFI-ASFC40155	0.251-0.312	6.4-7.9	0.612	15.5						
(3/16") 4.8mm	ASFC62	IFI-ASFC48120	0.063-0.125	1.6-3.2	0.471	12.0	0.375" 9.5	0.060" 1.52	#11 4.9 - 5.0	1.06" 27	500 2230N	690 3070N
	ASFC63	IFI-ASFC48137	0.126-0.187	3.2-4.8	0.538	13.7						
	ASFC64	IFI-ASFC48153	0.188-0.250	4.8-6.4	0.601	15.3						
	ASFC66	IFI-ASFC48187	0.251-0.375	6.4-9.5	0.736	18.7						
	ASFC68	IFI-ASFC48216	0.376-0.500	9.5-12.7	0.851	21.6						
	ASFC610	IFI-ASFC48261	0.501-0.625	12.9-15.9	1.026	26.1						
(1/4") 6.4mm	ASFC82	IFI-ASFC64133	0.020-0.125	0.5-3.2	0.525	13.3	0.500" 12.7	0.80" 2.03	F 6.5-6.6	1.25" 32	900 4000N	1100 4890N
	ASFC84	IFI-ASFC64165	0.126-0.250	3.2-6.4	0.650	16.5						
	ASFC86	IFI-ASFC64197	0.251-0.375	6.4-9.5	0.775	19.7						
	ASFC88	IFI-ASFC64229	0.376-0.500	9.5-12.7	0.900	22.9						
	ASFC810	IFI-ASFC64260	0.501-0.625	12.7-15.9	1.025	26.0						

# Aluminum&Steel Sealed Type Large Flange

## Available Sizes

Φ3.2(1/8"), Φ4.0(5/32"),  
Φ4.8(3/16")

## Head Styles

Large Flange

## Materials

Body:Aluminum  
Mandrel:Steel



Aluminum&Steel Sealed Type Large Flange

Rivmate

Washen

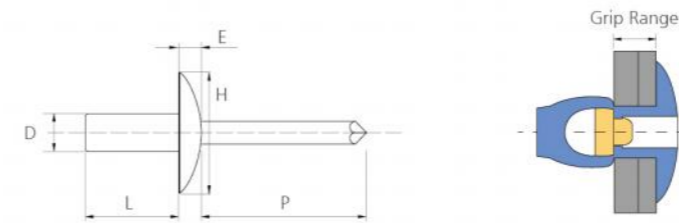

Material	Body	Aluminum
	Mandrel	Steel
Finish	Body	Polished
	Mandrel	Phosphated

D Nom.	Art.Code	Part.No	Grip Range		L(Max.)		H Nom.	E Max.	Dirll No. & Hole Size	P Min.	Shear LBS	Tensile LBS
			Inch	mm	Inch	mm						
(1/8") 3.2mm	ASFLF41	IF-ASFLF3207510	0.020-0.062	0.5-1.6	0.297	7.5	0.375" 9.5	0.082" 2.1	#30 3.3 - 3.4	1.06" 27	240 1070N	280 1250N
	ASFLF42	IF-ASFLF3209110	0.063-0.125	1.6-3.2	0.360	9.1						
	ASFLF43	IF-ASFLF3210710	0.126-0.187	3.2-4.8	0.422	10.7						
	ASFLF44	IF-ASFLF3212310	0.188-0.250	4.8-6.4	0.485	12.3						
	ASFLF45	IF-ASFLF3213910	0.251-0.312	6.4-7.9	0.547	13.9						
	ASFLF46	IF-ASFLF3215510	0.313-0.375	7.9-9.5	0.610	15.5						
(5/32") 4.0mm	ASFLF52	IF-ASFLF4009512	0.020-0.125	0.5-3.2	0.375	9.5	0.468" 12.0	0.102" 2.6	#20 4.1 - 4.2	1.06" 27	350 1560N	480 2140N
	ASFLF53	IF-ASFLF4011112	0.126-0.187	3.2-4.8	0.437	11.1						
	ASFLF54	IF-ASFLF4012712	0.188-0.250	4.8-6.4	0.500	12.7						
	ASFLF55	IF-ASFLF4014312	0.251-0.312	6.4-7.9	0.562	14.3						
	ASFLF56	IF-ASFLF4015912	0.313-0.375	7.9-9.5	0.625	15.9						
(3/16") 4.8mm	ASFLF62	IF-ASFLF4810316	0.020-0.125	0.5-3.2	0.406	10.3	0.625" 16.0	0.110" 2.8	#11 4.9 - 5.0	1.06" 27	500 2230N	690 3070N
	ASFLF63	IF-ASFLF4811916	0.126-0.187	3.2-4.8	0.468	11.9						
	ASFLF64	IF-ASFLF4813516	0.188-0.250	4.8-6.4	0.531	13.5						
	ASFLF66	IF-ASFLF4816716	0.251-0.375	6.4-9.5	0.656	16.7						
	ASFLF68	IF-ASFLF4819816	0.376-0.500	9.5-12.7	0.781	19.8						
	ASFLF610	IF-ASFLF4823016	0.501-0.625	12.7-15.9	0.906	23.0						
	ASFLF612	IF-ASFLF4826116	0.626-0.750	15.9-19.1	1.026	26.1						

# Aluminum&Stainless Steel Sealed Type Blind Rivet

## Available Sizes

Φ3.2(1/8"), Φ4.0(5/32"),  
Φ4.8(3/16"), Φ6.4(1/4")

## Head Styles

Dome Head , Large Flange  
Csk Head

## Materials

Body:Aluminum  
Mandrel:Stainless steel

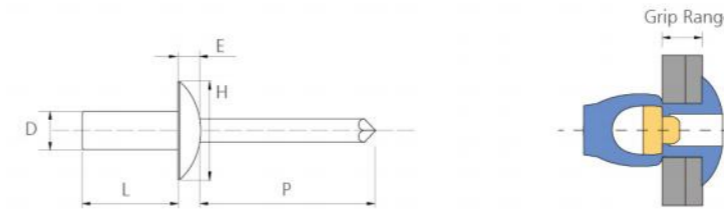

Material	Body	Aluminum
	Mandrel	Stainless Steel
Finish	Body	Polished
	Mandrel	Polished

D Nom.	Art.Code	Part.No	Grip Range		L(Max.)		H Nom.	E Max.	Dir   No.& Hole Size	P Min.	Shear LBS	Tensile LBS
			Inch	mm	Inch	mm						
(1/8") 3.2mm	ABF41	IFI-ABF32075	0.020-0.062	0.5-1.6	0.297	7.5	0.238" 6.0	0.050" 1.27	#30 3.3 - 3.4	1.06" 27	240 1070N	280 1250N
	ABF42	IFI-ABF32091	0.063-0.125	1.6-3.2	0.360	9.1						
	ABF43	IFI-ABF32107	0.126-0.187	3.2-4.8	0.422	10.7						
	ABF44	IFI-ABF32123	0.188-0.250	4.8-6.4	0.485	12.3						
	ABF45	IFI-ABF32139	0.251-0.312	6.4-7.9	0.547	13.9						
	ABF46	IFI-ABF32155	0.313-0.375	7.9-9.5	0.610	15.5						
(5/32") 4.0mm	ABF52	IFI-ABF40095	0.020-0.125	0.5-3.2	0.375	9.5	0.312" 7.9	0.065" 1.65	#20 4.1 - 4.2	1.06" 27	350 1560N	480 2140N
	ABF53	IFI-ABF40111	0.126-0.187	3.2-4.8	0.437	11.1						
	ABF54	IFI-ABF40127	0.188-0.250	4.8-6.4	0.500	12.7						
	ABF55	IFI-ABF40143	0.251-0.312	6.4-7.9	0.562	14.3						
	ABF56	IFI-ABF40159	0.313-0.375	7.9-9.5	0.625	15.9						
	(3/16") 4.8mm	ABF62	IFI-ABF48103	0.020-0.125	0.5-3.2	0.406						
ABF63		IFI-ABF48119	0.126-0.187	3.2-4.8	0.468	11.9						
ABF64		IFI-ABF48135	0.188-0.250	4.8-6.4	0.531	13.5						
ABF66		IFI-ABF48167	0.251-0.375	6.4-9.5	0.656	16.7						
ABF68		IFI-ABF48198	0.376-0.500	9.5-12.7	0.781	19.8						
ABF610		IFI-ABF48230	0.501-0.625	12.7-15.9	0.906	23.0						
(1/4") 6.4mm	ABF612	IFI-ABF48261	0.626-0.750	15.9-19.1	1.026	26.1	0.500" 12.7	0.100" 2.54	F 6.5-6.6	1.25" 32	900 4000N	1100 4890N
	ABF82	IFI-ABF64113	0.020-0.125	0.5-3.2	0.445	11.3						
	ABF84	IFI-ABF64145	0.126-0.250	3.2-6.4	0.570	14.5						
	ABF86	IFI-ABF64177	0.251-0.375	6.4-9.5	0.695	17.7						
	ABF88	IFI-ABF64208	0.376-0.500	9.5-12.7	0.820	20.8						
	ABF810	IFI-ABF64240	0.501-0.625	12.7-15.9	0.945	24.0						

# Full Stainless Steel Sealed Type Blind Rivet



Scan to View Test Video  
(All Stainless Steel Sealed Type BBF-S64)  
In Youtube

Full Stainless Steel Sealed Type Blind Rivet

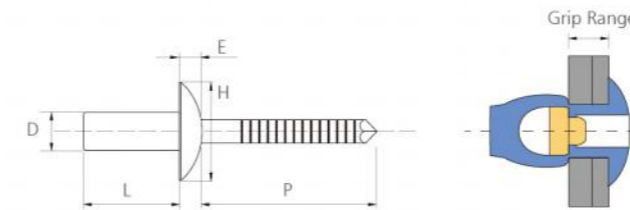

Material	Body	304 Stainless Steel
	Mandrel	420 Stainless Steel
Finish	Body	Polished
	Mandrel	Polished

## Available Sizes

Φ3.2(1/8"), Φ4.0(5/32"),  
Φ4.8(3/16"), Φ6.4(1/4")

## Head Styles

Dome Head , Large Flange ,  
Csk Head

## Materials

Body:Stainless Steel  
Mandrel:Stainless Steel



D Nom.	Art.Code	Part.No	Grip Range		L(Max.)		H Nom.	E Max.	Dirll No.& Hole Size	P Min.	Shear LBS	Tensile LBS
			Inch	mm	Inch	mm						
(1/8") 3.2mm	BBF-S41	IFI-BBF-S32075	0.020-0.062	0.5-1.6	0.297	7.5	0.238" 6.0	0.050" 1.27	#30 3.3 - 3.4	1.06" 27	400 1780N	450 2000N
	BBF-S42	IFI-BBF-S32091	0.063-0.125	1.6-3.2	0.360	9.1						
	BBF-S43	IFI-BBF-S32107	0.126-0.187	3.2-4.8	0.422	10.7						
	BBF-S44	IFI-BBF-S32123	0.188-0.250	4.8-6.4	0.485	12.3						
	BBF-S45	IFI-BBF-S32139	0.251-0.312	6.4-7.9	0.547	13.9						
	BBF-S46	IFI-BBF-S32155	0.313-0.375	7.9-9.5	0.610	15.5						
	BBF-S48	IFI-BBF-S32187	0.375-0.500	9.5-12.7	0.735	18.7						
(5/32") 4.0mm	BBF-S52	IFI-BBF-S40095	0.020-0.125	0.5-3.2	0.375	9.5	0.312" 7.9	0.065" 1.65	#20 4.1 - 4.2	1.06" 27	700 3120N	800 3560N
	BBF-S53	IFI-BBF-S40111	0.126-0.187	3.2-4.8	0.437	11.1						
	BBF-S54	IFI-BBF-S40127	0.188-0.250	4.8-6.4	0.500	12.7						
	BBF-S55	IFI-BBF-S40143	0.251-0.312	6.4-7.9	0.562	14.3						
	BBF-S56	IFI-BBF-S40159	0.313-0.375	7.9-9.5	0.625	15.9						
	BBF-S58	IFI-BBF-S40191	0.376-0.500	9.5-12.7	0.750	19.1						
(3/16") 4.8mm	BBF-S62	IFI-BBF-S48103	0.020-0.125	0.5-3.2	0.406	10.3	0.375" 9.5	0.080" 2.03	#11 4.9 - 5.0	1.06" 27	850 3790N	900 4010N
	BBF-S63	IFI-BBF-S48119	0.126-0.187	3.2-4.8	0.468	11.9						
	BBF-S64	IFI-BBF-S48135	0.188-0.250	4.8-6.4	0.531	13.5						
	BBF-S66	IFI-BBF-S48167	0.251-0.375	6.4-9.5	0.656	16.7						
	BBF-S68	IFI-BBF-S48198	0.376-0.500	9.5-12.7	0.781	19.8						
	BBF-S610	IFI-BBF-S48230	0.501-0.625	12.7-15.9	0.906	23.0						
	BBF-S612	IFI-BBF-S48261	0.626-0.750	15.9-19.1	1.026	26.1						
(1/4") 6.4mm	BBF-S82	IFI-BBF-S64113	0.020-0.125	0.5-3.2	0.445	11.3	0.500" 12.7	0.100" 2.54	F 6.5-6.6	1.25" 32	1348 6000N	1797 8000N
	BBF-S84	IFI-BBF-S64145	0.126-0.250	3.2-6.4	0.570	14.5						
	BBF-S86	IFI-BBF-S64177	0.251-0.375	6.4-9.5	0.695	17.7						
	BBF-S88	IFI-BBF-S64208	0.376-0.500	9.5-12.7	0.820	20.8						
	BBF-S810	IFI-BBF-S64240	0.501-0.625	12.7-15.9	0.945	24.0						
	BBF-S812	IFI-BBF-S64272	0.626-0.750	15.9-19.1	1.070	27.2						
	BBF-S814	IFI-BBF-S64304	0.751-0.875	19.1-22.2	1.195	30.4						
	BBF-S816	IFI-BBF-S64335	0.876-1.000	22.2-25.4	1.320	33.5						

# Full Stainless Steel Sealed Type CSK Head

## Available Sizes

Φ3.2(1/8"), Φ4.0(5/32"),  
Φ4.8(3/16"), Φ6.4(1/4")

## Head Styles

CSK Head

## Materials

Body:Stainless Steel  
Mandrel:Stainless Steel



Full Stainless Steel Sealed Type Blind Rivet

Rivmate

Washen

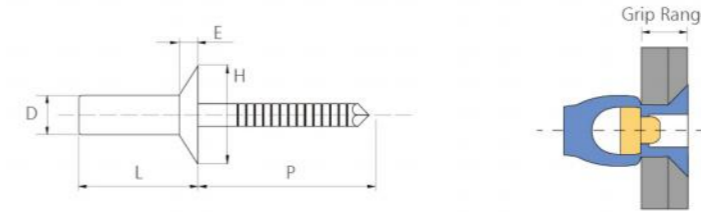

Material	Body	304 Stainless Steel
	Mandrel	420 Stainless Steel
Finish	Body	Polished
	Mandrel	Polished

D Nom.	Art.Code	Part.No	Grip Range		L(Max.)		H Nom.	E Ref.	Dirll No. & Hole Size	P Min.	Shear LBS	Tensile LBS
			Inch	mm	Inch	mm						
(1/8") 3.2mm	BBF-S42C	IFI-BBFC-S32100	0.063-0.125	1.6-3.2	0.395	10.0	0.233" 5.9	0.042" 1.07	#30 3.3 - 3.4	1.06" 27	400 1780N	450 2000N
	BBF-S43C	IFI-BBFC-S32116	0.126-0.187	3.2-4.8	0.457	11.6						
	BBF-S44C	IFI-BBFC-S32132	0.188-0.250	4.8-6.4	0.520	13.2						
	BBF-S45C	IFI-BBFC-S32148	0.251-0.312	6.4-7.9	0.582	14.8						
	BBF-S46C	IFI-BBFC-S32164	0.313-0.375	7.9-9.5	0.645	16.4						
(5/32") 4.0mm	BBF-S52C	IFI-BBFC-S40108	0.063-0.125	1.6-3.2	0.425	10.8	0.312" 7.9	0.051" 1.29	#20 4.1 - 4.2	1.06" 27	700 3120N	800 3560N
	BBF-S53C	IFI-BBFC-S40124	0.126-0.187	3.2-4.8	0.487	12.4						
	BBF-S54C	IFI-BBFC-S40140	0.188-0.250	4.8-6.4	0.550	14.0						
	BBF-S55C	IFI-BBFC-S40155	0.251-0.312	6.4-7.9	0.612	15.5						
(3/16") 4.8mm	BBF-S62C	IFI-BBFC-S48120	0.063-0.125	1.6-3.2	0.471	12.0	0.375" 9.5	0.060" 1.52	#11 4.9 - 5.0	1.06" 27	850 3790N	900 4010N
	BBF-S63C	IFI-BBFC-S48137	0.126-0.187	3.2-4.8	0.538	13.7						
	BBF-S64C	IFI-BBFC-S48153	0.188-0.250	4.8-6.4	0.601	15.3						
	BBF-S66C	IFI-BBFC-S48187	0.251-0.375	6.4-9.5	0.736	18.7						
	BBF-S68C	IFI-BBFC-S48216	0.376-0.500	9.5-12.7	0.851	21.6						
	BBF-S610C	IFI-BBFC-S48261	0.501-0.625	12.7-15.9	1.026	26.1						
(1/4") 6.4mm	BBF-S82C	IFI-BBFC-S64133	0.020-0.125	0.5-3.2	0.525	13.3	0.500" 12.7	0.080" 2.03	F 6.5-6.6	1.25" 32	1348 6000N	1797 8000N
	BBF-S84C	IFI-BBFC-S64165	0.126-0.250	3.2-6.4	0.650	16.5						
	BBF-S86C	IFI-BBFC-S64197	0.251-0.375	6.4-9.5	0.775	19.7						
	BBF-S88C	IFI-BBFC-S64229	0.376-0.500	9.5-12.7	0.900	22.9						
	BBF-S810C	IFI-BBFC-S64260	0.501-0.625	12.7-15.9	1.025	26.0						

# Aluminum&Steel Multi-grip Dome Head

## Available Sizes

Φ3.2(1/8"), Φ4.0(5/32"),  
Φ4.8(3/16")

## Head Styles

Dome Head

## Materials

Body:Aluminum(5052)  
Mandrel:Steel



Aluminum&Steel Multi-grip Dome Head

Rivmate

Wasfen

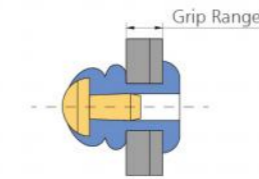
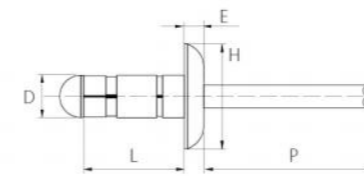

Material	Body	Aluminum(5052)
	Mandrel	Steel
Finish	Body	Polished
	Mandrel	Zinc Plated

D Nom.	Art.Code	Part.No	Grip Range		L(Max.)		H Nom.	E Ref.	Dirll No.& Hole Size	P Min.	Shear LBS	Tensile LBS
			Inch	mm	Inch	mm						
(1/8") 3.2mm	ASMG42	IFI-ASMG32072	0.031-0.134	0.8-3.4	0.283	7.2	0.252" 6.4	0.041" 1.05	#30 3.3 - 3.4	1.06" 27	135 600N	202 900N
	ASMG43	IFI-ASMG32084	0.031-0.187	0.8-4.8	0.331	8.4						
	ASMG44	IFI-ASMG32099	0.046-0.250	1.2-6.4	0.390	9.9						
	ASMG45	IFI-ASMG32115	0.156-0.312	4.0-7.9	0.453	11.5						
	ASMG46	IFI-ASMG32131	0.216-0.375	5.5-9.5	0.516	13.1						
	ASMG47	IFI-ASMG32155	0.250-0.437	6.4-11.1	0.610	15.5						
(5/32") 4.0mm	ASMG52	IFI-ASMG40072	0.020-0.125	0.5-3.2	0.283	7.2	0.312" 7.9	0.051" 1.30	#20 4.1 - 4.2	1.06" 27	213 950N	337 1500N
	ASMG54	IFI-ASMG40099	0.046-0.250	1.2-6.4	0.390	9.9						
	ASMG55	IFI-ASMG40115	0.125-0.312	3.2-7.9	0.453	11.5						
	ASMG56	IFI-ASMG40131	0.156-0.375	4.0-9.5	0.516	13.1						
	ASMG57	IFI-ASMG40155	0.250-0.437	6.4-11.1	0.610	15.5						
	ASMG58	IFI-ASMG40173	0.250-0.500	6.4-12.7	0.681	17.3						
(3/16") 4.8mm	ASMG64	IFI-ASMG48107	0.062-0.250	1.6-6.4	0.421	10.7	0.386" 9.8	0.061" 1.55	#11 4.9 - 5.0	1.06" 27	296 1320N	450 2000N
	ASMG65	IFI-ASMG48125	0.079-0.315	2.0-8.0	0.492	12.5						
	ASMG66	IFI-ASMG48149	0.125-0.375	3.2-9.5	0.587	14.9						
	ASMG67	IFI-ASMG48155	0.187-0.437	4.8-11.1	0.610	15.5						
	ASMG68	IFI-ASMG48173	0.250-0.500	6.4-12.7	0.681	17.3						
	ASMG610	IFI-ASMG48199	0.354-0.590	9.0-15.0	0.783	19.9						
ASMG612	IFI-ASMG48252	0.500-0.781	12.7-19.8	0.992	25.2							

# Aluminum&Steel Multi-grip CSK Head

## Available Sizes

Φ3.2(1/8"), Φ4.0(5/32"),  
Φ4.8(3/16")

## Head Styles

Csk Head

## Materials

Body:Aluminum(5052)  
Mandrel:Steel



Aluminum&Steel Multi-grip CSK Type

Rivmate

Wasfen

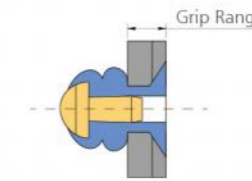
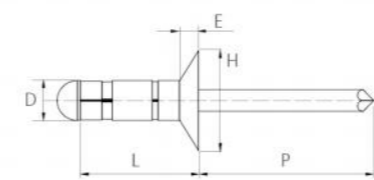

Material	Body	Aluminum(5052)
	Mandrel	Steel
Finish	Body	Polished
	Mandrel	Zinc Plated

D Nom.	Art.Code	Part.No	Grip Range		L(Max.)		H Nom.	E Ref.	Dirll No.& Hole Size	P Min.	Shear LBS	Tensile LBS
			Inch	mm	Inch	mm						
(1/8") 3.2mm	ASMGC44	IFI-ASMGC32101	0.093-0.250	2.4-6.4	0.398	10.1	0.210" 5.35	0.033" 0.85	#30 3.3 - 3.4	1.06" 27	135 600N	202 900N
	ASMGC45	IFI-ASMGC32115	0.156-0.312	4.0-7.9	0.453	11.5						
	ASMGC46	IFI-ASMGC32131	0.156-0.375	4.0-9.5	0.516	13.1						
(5/32") 4.0mm	ASMGC54	IFI-ASMGC40101	0.046-0.250	1.2-6.4	0.398	10.1	0.248" 6.3	0.035" 0.90	#20 4.1 - 4.2	1.06" 27	213 950N	337 1500N
	ASMGC55	IFI-ASMGC40117	0.109-0.312	2.8-7.9	0.461	11.7						
	ASMGC56	IFI-ASMGC40131	0.171-0.375	4.3-9.5	0.516	13.1						
(3/16") 4.8mm	ASMGC65	IFI-ASMGC48125	0.125-0.312	3.2-7.9	0.492	12.5	0.347" 8.8	0.053" 1.35	#11 4.9 - 5.0	1.06" 27	296 1320N	450 2000N
	ASMGC68	IFI-ASMGC48173	0.250-0.500	6.4-127	0.681	17.3						
	ASMGC612	IFI-ASMGC48252	0.500-0.781	12.7-198	0.992	25.2						

# Aluminum&Steel Multi-grip Large Flange

## Available Sizes

Φ3.2(1/8"), Φ4.0(5/32"),  
Φ4.8(3/16")

## Head Styles

Large Flange

## Materials

Body:Aluminum(5052)  
Mandrel:Steel



Aluminum&Steel Multi-grip Large Flange

Rivmate

Washen

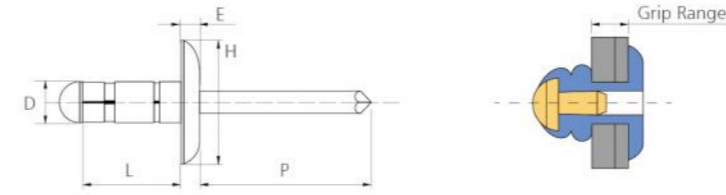

Material	Body	Aluminum(5052)
	Mandrel	Steel
Finish	Body	Polished
	Mandrel	Zinc Plated

D Nom.	Art.Code	Part.No	Grip Range		L(Max.)		H Nom.	E Ref.	Dirll No.& Hole Size	P Min.	Shear LBS	Tensile LBS
			Inch	mm	Inch	mm						
(1/8") 3.2mm	ASMGLF42	IF-ASMGLF3207210	0.031-0.134	0.8-3.4	0.283	7.2	0.375" 9.5	0.047" 1.20	#30 3.3 - 3.4	1.06" 27	135 600N	202 900N
	ASMGLF43	IF-ASMGLF3208410	0.031-0.187	0.8-4.8	0.331	8.4						
	ASMGLF44	IF-ASMGLF3209910	0.046-0.250	1.2-6.4	0.390	9.9						
	ASMGLF45	IF-ASMGLF3211510	0.156-0.312	4.0-7.9	0.453	11.5						
	ASMGLF46	IF-ASMGLF3213110	0.216-0.375	5.5-9.5	0.516	13.1						
	ASMGLF54	IF-ASMGLF4009912	0.046-0.250	1.2-6.4	0.390	9.9						
(5/32") 4.0mm	ASMGLF55	IF-ASMGLF4011512	0.125-0.312	3.2-7.9	0.453	11.5	0.468" 12.0	0.059" 1.50	#20 4.1 - 4.2	1.06" 27	213 950N	337 1500N
	ASMGLF56	IF-ASMGLF4013112	0.156-0.375	4.0-9.5	0.516	13.1						
	ASMGLF57	IF-ASMGLF4015512	0.250-0.437	6.4-11.1	0.610	15.5						
	ASMGLF58	IF-ASMGLF4017312	0.250-0.500	6.4-12.7	0.681	17.3						
(3/16") 4.8mm	ASMGLF64	IF-ASMGLF4810716	0.062-0.250	1.6-6.4	0.421	10.7	0.625" 15.9	0.069" 1.75	#11 4.9 - 5.0	1.06" 27	296 1320N	450 2000N
	ASMGLF67	IF-ASMGLF4815516	0.187-0.437	4.8-11.1	0.610	15.5						
	ASMGLF68	IF-ASMGLF4817316	0.250-0.500	6.4-12.7	0.681	17.3						
	ASMGLF612	IF-ASMGLF4825216	0.500-0.781	12.7-19.8	0.992	25.2						

# Aluminum&Stainless Steel Multi-grip Blind Rivet

Aluminum&Stainless Steel Multi-grip Blind Rivet

Rivmate

Wasfen

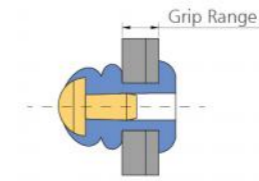
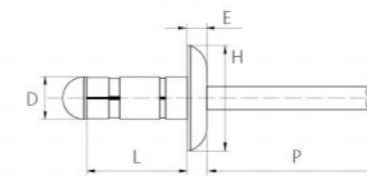

Material	Body	Aluminum(5052)
	Mandrel	Stainless Steel
Finish	Body	Polished
	Mandrel	Polished

### Available Sizes

Φ3.2(1/8"), Φ4.0(5/32"),  
Φ4.8(3/16")

### Head Styles

Dome Head , Large Flange ,  
Csk Head

### Materials

Body:Aluminum(5052)  
Mandrel:Stainless Steel



D Nom.	Art.Code	Part.No	Grip Range		L(Max.)		H Nom.	E Ref.	Dirll No.& Hole Size	P Min.	Shear LBS	Tensile LBS
			Inch	mm	Inch	mm						
(1/8") 3.2mm	ABMG42	IFI-ABMG32072	0.031-0.134	0.8-3.4	0.283	7.2	0.252" 6.4	0.041" 1.05	#30 3.3 - 3.4	1.06" 27	135 600N	202 900N
	ABMG43	IFI-ABMG32084	0.031-0.187	0.8-4.8	0.331	8.4						
	ABMG44	IFI-ABMG32099	0.046-0.250	1.2-6.4	0.390	9.9						
	ABMG45	IFI-ABMG32115	0.156-0.312	4.0-7.9	0.453	11.5						
	ABMG46	IFI-ABMG32131	0.216-0.375	5.5-9.5	0.516	13.1						
	ABMG47	IFI-ABMG32155	0.250-0.437	6.4-11.1	0.610	15.5						
(5/32") 4.0mm	ABMG52	IFI-ABMG40072	0.020-0.125	0.5-3.2	0.283	7.2	0.312" 7.9	0.051" 1.30	#20 4.1 - 4.2	1.06" 27	213 950N	337 1500N
	ABMG54	IFI-ABMG40099	0.046-0.250	1.2-6.4	0.390	9.9						
	ABMG55	IFI-ABMG40115	0.125-0.312	3.2-7.9	0.453	11.5						
	ABMG56	IFI-ABMG40131	0.156-0.375	4.0-9.5	0.516	13.1						
	ABMG57	IFI-ABMG40155	0.250-0.437	6.4-11.1	0.610	15.5						
	ABMG58	IFI-ABMG40173	0.250-0.500	6.4-12.7	0.681	17.3						
(3/16") 4.8mm	ABMG64	IFI-ABMG48107	0.062-0.250	1.6-6.4	0.421	10.7	0.386" 9.8	0.061" 1.55	#11 4.9 - 5.0	1.06" 27	296 1320N	450 2000N
	ABMG65	IFI-ABMG48125	0.079-0.315	2.0-8.0	0.492	12.5						
	ABMG66	IFI-ABMG48149	0.125-0.375	3.2-9.5	0.587	14.9						
	ABMG67	IFI-ABMG48155	0.187-0.437	4.8-11.1	0.610	15.5						
	ABMG68	IFI-ABMG48173	0.250-0.500	6.4-12.7	0.681	17.3						
	ABMG610	IFI-ABMG48199	0.354-0.590	9.0-15.0	0.783	19.9						
ABMG612	IFI-ABMG48252	0.500-0.781	12.7-19.8	0.992	25.2							

# Full Steel Multi-grip Blind Rivet

## Available Sizes

Φ3.2(1/8"), Φ4.0(5/32"),  
Φ4.8(3/16")

## Head Styles

Dome Head, Large Flange,  
Csk Head

## Materials

Body: Carbon Steel  
Mandrel: Carbon Steel



Full Steel Multi-grip Blind Rivet

Rivmate

Wasfen

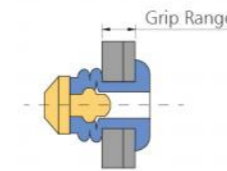
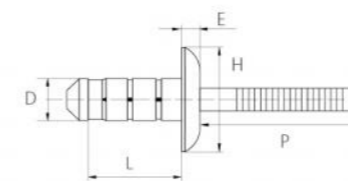

Material	Body	Carbon Steel
	Mandrel	Carbon Steel
Finish	Body	Zinc Plated
	Mandrel	Zinc Plated

Head Type	D Nom.	Art. Code	Part. No	Grip Range		L(Max.) mm	H Nom.	E Ref.	Dirll No. & Hole Size	P Min.	Shear LBS	Tensile LBS
				Inch	mm							
Dome	(1/8") 3.2mm	SSMG32090	IFI-SSMG32090	0.043-0.157	1.1-4.0	9.0	0.238" 7.2	0.033" 0.85	#30 3.3	1.06" 27	353 1500N	385 1700N
		SSMG32130	IFI-SSMG32130	0.039-0.354	1.0-9.0	13.0						
	(5/32") 4.0mm	SSMG40110	IFI-SSMG40110	0.055-0.197	1.4-5.0	11.0	0.319" 8.1	0.047" 1.20	#20 4.1	1.06" 27	440 1950N	530 2350N
		SSMG40140	IFI-SSMG40140	0.055-0.315	2.0-9.0	14.0						
	(3/16") 4.8mm	SSMG48110	IFI-SSMG48110	0.039-0.236	1.0-6.0	11.0	0.386" 9.8	0.057" 1.45	#11 4.9	1.06" 27	785 3500N	740 3300N
		SSMG48140	IFI-SSMG48140	0.039-0.354	1.0-9.0	14.0						
Large	(3/16") 4.8mm	SSMGL48110	IFI-SSMGLF4811014	0.039-0.236	1.0-6.0	11.0	0.511" 14.0	0.067" 1.70	#11 4.9	1.06" 27	785 3500N	740 3300N
		SSMGL48140	IFI-SSMGLF4814014	0.039-0.354	1.0-9.0	14.0						
		SSMGL48170	IFI-SSMGLF4817014	0.118-0.472	3.0-12.0	17.0						
EX-Large	(3/16") 4.8mm	SSMGLF48110	IFI-SSMGLF4811016	0.039-0.236	1.0-6.0	11.0	0.624" 15.9	0.069" 1.75	#11 4.9	1.06" 27	785 3500N	740 3300N
		SSMGLF48140	IFI-SSMGLF4814016	0.039-0.354	1.0-9.0	14.0						
		SSMGLF48170	IFI-SSMGLF4817016	0.118-0.472	3.0-12.0	17.0						
CSK 120°	(3/16") 4.8mm	SSMGC48110	IFI-SSMGC48110	0.098-0.236	2.5-6.0	11.0	0.340" 8.65	0.067" 1.70	#11 4.9	1.06" 27	785 3500N	740 3300N
		SSMGC48140	IFI-SSMGC48140	0.118-0.354	3.0-9.0	14.0						
		SSMGC48170	IFI-SSMGC48170	0.157-0.472	4.0-12.0	17.0						
		SSMGC48220	IFI-SSMGC48220	0.354-0.670	9.0-17.0	22.0						

# Full Stainless Steel Multi-grip Blind Rivet

## Available Sizes

Φ3.2(1/8"), Φ4.0(5/32"),  
Φ4.8(3/16")

## Head Styles

Dome Head , Large Flange ,  
Csk Head

## Materials

Body:Stainless Steel  
Mandrel:Stainless Steel



Scan to View Test Video  
(All Stainless Steel Multi-grip 06-14)  
In Youtube

Full Stainless Steel Multi-grip Blind Rivet

Rivmate

Wasfen

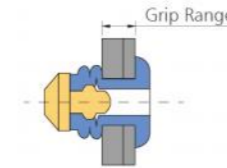
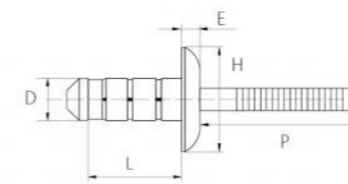

Material	Body	304 Stainless Steel
	Mandrel	304 Stainless Steel
Finish	Body	Polished
	Mandrel	Polished

Head Type	D Nom.	Art.Code	Part.No	Grip Range		L(Max.) mm	H Nom.	E Ref.	Dirll No.& Hole Size	P Min.	Shear LBS	Tensile LBS
				Inch	mm							
Dome	(1/8") 3.2mm	BBMG32090	IFI-BBMG32090	0.043-0.157	1.1-4.0	9.0	0.238" 7.2	0.033" 0.85	#30 3.3	1.06" 27	353 1500N	385 1700N
		BBMG32130	IFI-BBMG32130	0.039-0.354	1.0-9.0	13.0						
	(5/32") 4.0mm	BBMG40110	IFI-BBMG40110	0.055-0.197	1.4-5.0	11.0	0.319" 8.1	0.047" 1.20	#20 4.1	1.06" 27	440 1950N	530 2350N
		BBMG40140	IFI-BBMG40140	0.055-0.315	2.0-9.0	14.0						
	(3/16") 4.8mm	BBMG48110	IFI-BBMG48110	0.039-0.236	1.0-6.0	11.0	0.386" 9.8	0.057" 1.45	#11 4.9	1.06" 27	785 3500N	740 3300N
		BBMG48140	IFI-BBMG48140	0.039-0.354	1.0-9.0	14.0						
BBMG48170		IFI-BBMG48170	0.118-0.472	3.0-12.0	17.0							
Large	(3/16") 4.8mm	BBMGL48110	IFI-BBMGLF4811014	0.039-0.236	1.0-6.0	11.0	0.511" 14.0	0.067" 1.70	#11 4.9	1.06" 27	785 3500N	740 3300N
		BBMGL48140	IFI-BBMGLF4814014	0.039-0.354	1.0-9.0	14.0						
		BBMGL48170	IFI-BBMGLF4817014	0.118-0.472	3.0-12.0	17.0						
EX-Large	(3/16") 4.8mm	BBMGLF48110	IFI-BBMGLF4811016	0.039-0.236	1.0-6.0	11.0	0.624" 15.9	0.069" 1.75	#11 4.9	1.06" 27	785 3500N	740 3300N
		BBMGLF48140	IFI-BBMGLF4814016	0.039-0.354	1.0-9.0	14.0						
		BBMGLF48170	IFI-BBMGLF4817016	0.118-0.472	3.0-12.0	17.0						
CSK 120°	(3/16") 4.8mm	BBMGC48110	IFI-BBMGC48110	0.098-0.236	2.5-6.0	11.0	0.340" 8.65	0.067" 1.70	#11 4.9	1.06" 27	785 3500N	740 3300N
		BBMGC48140	IFI-BBMGC48140	0.118-0.354	3.0-9.0	14.0						
		BBMGC48170	IFI-BBMGC48170	0.157-0.472	4.0-12.0	17.0						
		BBMGC48220	IFI-BBMGC48220	0.354-0.670	9.0-17.0	22.0						

# Full Carbon Steel Uni-grip Blind Rivet

## Available Sizes

Φ3.2(1/8"), Φ4.0(5/32"),  
Φ4.8(3/16"), Φ6.0(15/64")

## Head Styles

Dome Head, 120° Csk Head

## Materials

Body: Carbon Steel 10B21  
Mandrel: Carbon Steel 42A

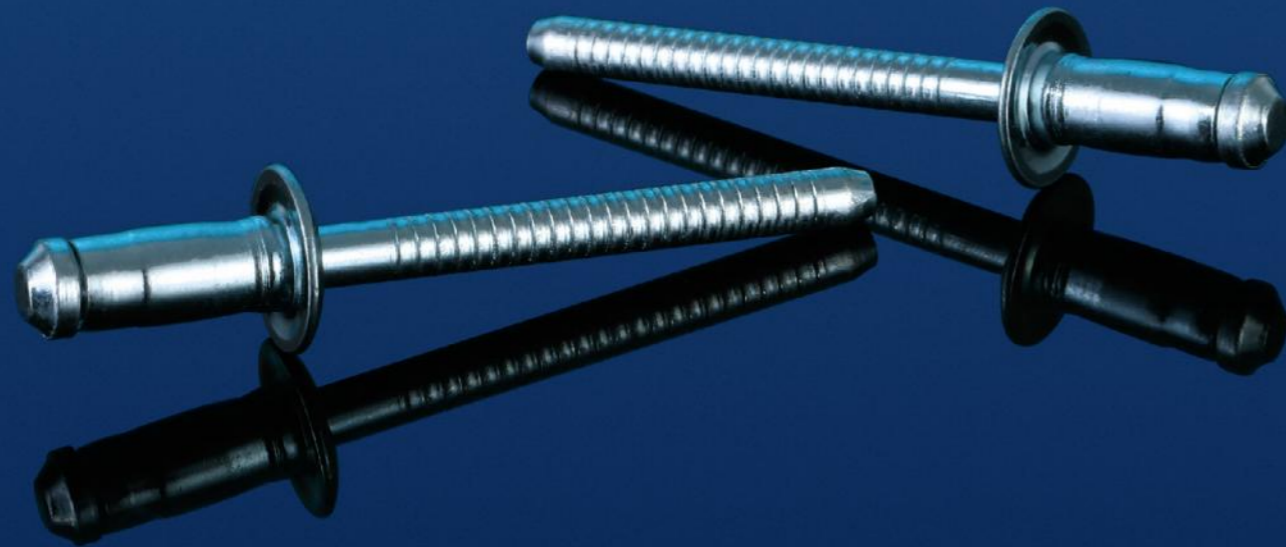

Scan to View Test Video  
(All Carbon Steel Uni-grip 06-11)  
In Youtube

Full Carbon Steel Uni-grip Blind Rivet

Rivmate

Washen

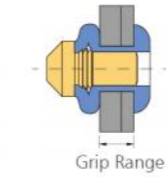
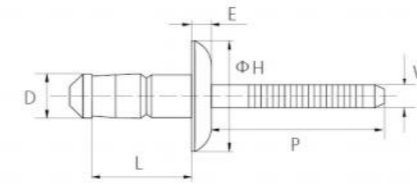

Material	Body	Carbon Steel 10B21
	Mandrel	Carbon Steel 42A
Finish	Body	Zinc Plated
	Mandrel	Zinc Plated

D	Art.Code	Part Number	L [+1/-0]	Grip Range	H	E (Max)	Drill	P (Min)	W (Max)	Shear [N] (Min)	Tensile [N] (Min)
3.2 +0.08 -0.15	SSPMG-0408	SSPMG32065	6.5	1.0-3.0	5.5-6.8	1.4	3.3-3.4	27	2.10	1200	1300
	/	SSPMG32080	8.0	2.0-4.0						1700	
	SSPMG0411	SSPMG32092	9.2	3.0-5.0							
	SSPMG0414	SSPMG32115	11.5	5.0-7.0							
4.0 +0.08 -0.15	SSPMG-0509	SSPMG40075	7.5	1.0-3.0	7.3-8.3	1.6	4.1-4.2	27	2.70	2000	2800
	/	SSPMG40085	8.5	2.0-4.5						3500	
	SSPMG-0512	SSPMG40095	9.5	3.0-5.0							
	SSPMG-0516	SSPMG40125	12.5	5.0-7.0							
4.8 +0.08 -0.15	SSPMG-0611	SSPMG48100	10.0	1.5-3.5	9.0-10.0	1.7	4.9-5.0	27	3.20	3600	3800
	SSPMG-0614	SSPMG48120	12.0	3.5-6.0						4200	
	SSPMG-0618	SSPMG48143	14.3	6.0-8.5							
	/	SSPMG48160	16.0	7.0-10.0							
	/	SSPMG48180	18.0	9.5-12.0							
6.0 +0.08 -0.15	SSPMG-6010	SSPMG60100	10.0	1.5-4.0	11.0-12.3	2.15	6.1-6.2	31	4.10	4200	5400
	SSPMG-6013	SSPMG60130	13.0	3.0-6.0						5900	
	SSPMG-6016	SSPMG60160	16.0	6.0-9.0							
	SSPMG-6019	SSPMG60190	19.0	9.0-12.0							

# Full Stainless Steel Uni-grip Blind Rivet

## Available Sizes

Φ3.2(1/8"), Φ4.0(5/32"),  
Φ4.8(3/16"), Φ6.0(15/64")

## Head Styles

Dome Head, 120° Csk Head

## Materials

Body: 304 Stainless Steel  
Mandrel: 304 Stainless Steel



Full Stainless Steel Uni-grip Blind Rivet

Rivmate

Wasfen

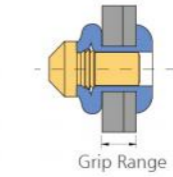
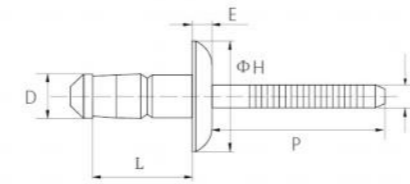

Body	304 Stainless Steel
Mandrel	304 Stainless Steel
Finish	Polished

D	Art. Code	Part Number	L [+1/-0]	Grip Range	H	E (Max)	Drill	P (Min)	W (Max)	Shear [N] (Min)	Tensile [N] (Min)
3.2 +0.08 -0.15	BBPMG-0408	BBPMG32065	1.0-3.0	6.5	5.5-6.6	1.2	3.3-3.4	27	2.15	1600	1600
	/	BBPMG32080	2.0-4.0	8.0						2000	
	BBPMG-0411	BBPMG32092	3.0-5.0	9.2							
	BBPMG-0414	BBPMG32115	5.0-7.0	11.5							
4.0 +0.08 -0.15	BBPMG-0509	BBPMG40075	1.0-3.0	7.5	7.3-8.3	1.6	4.1-4.2	27	2.65	2800	4000
	BBPMG-0512	BBPMG40095	3.0-5.0	9.5						5200	
	BBPMG-0516	BBPMG40125	5.0-7.0	12.5							
	/	BBPMG40140	5.0-8.0	14.0							
	/	BBPMG40150	8.0-10.0	15.0							
	/	BBPMG40160	9.0-11.0	16.0							
4.8 +0.08 -0.15	BBPMG-0611	BBPMG48100	1.5-3.5	10.0	9.0-10.0	1.7	4.9-5.0	27	3.25	4200	5000
	BBPMG-0614	BBPMG48120	3.5-6.0	12.0						5500	
	BBPMG-0618	BBPMG48143	6.0-8.5	14.3							
	BBPMG-0619	BBPMG48160	7.0-10.0	16.0							
	/	BBPMG48185	10.5-13.0	18.5							
	/	BBPMG48200	11.5-14.0	20.0							
	/	BBPMG48250	16.5-20.0	25.0							
6.0 +0.08 -0.15	BBPMG-6010	BBPMG60100	1.5-4.0	10.0	11.0-12.6	2.2	6.1-6.2	31	4.20	7800	6200
	BBPMG-6013	BBPMG60130	3.0-6.0	13.0						9500	
	BBPMG-6016	BBPMG60160	6.0-9.0	16.0							
	BBPMG-6019	BBPMG60190	9.0-12.0	19.0							

# Full Aluminum Folding Rivet

## Available Sizes

Φ4.0(5/32"), Φ4.8(3/16")

## Head Styles

Dome Head

## Materials

Body: Aluminum  
Mandrel: Aluminum



Scan to View Test Video  
(All Aluminum Trifirm 06-19)  
in Youtube

Full Aluminum Folding Rivet

Rivmate

Washen

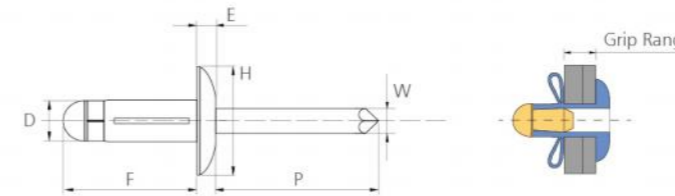

Material	Body	Aluminum
	Mandrel	Aluminum
Finish	Body	Natural
	Mandrel	Natural

No.	Art. Code	Part Number	Size	D (Max)	E (Max)	F (Ref.)	H (Max)	P (Min)	W (Max)	Hole Dia	Grip Range	Tensile ref.	Shear ref.
1	AAT-0516	AAT40140	4.0x14	Φ4.0 (5/32")	1.6	16.0	Φ8.2	27	2.3	Φ4.2~Φ4.5	1.0-3.0	750N	550N
2	AAT-0523	AAT40188	4.0x18.8			21.2					1.0-7.0		
3	AAT-0619	AAT48160	4.8x16	Φ4.8 (3/16")	2.1	18.1	Φ10.1	27	2.9	Φ5.0~Φ5.2	1.0-4.0	950N	750N
4	AAT-0625	AAT48205	4.8x20.5			23.3					1.0-9.0		
5	AAT-0630	AAT48250	4.8x25			27.1					4.0-12.0		

# 5.2mm/6.4mm Aluminum Watertight Folding Rivet

## Available Sizes

Φ5.2(3/16"), Φ6.4(1/4")

## Head Styles

Dome Head

## Materials

Body:AL5056  
Mandrel:AL7A03



Scan to View Test Video  
(Aluminum Bulbtight Trifirm 6604-6-4W)  
In Youtube

## 5.2/6.4 Aluminum Watertight Folding Rivet

RWMATE

Washen

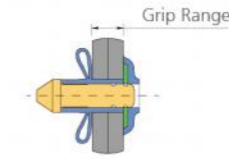
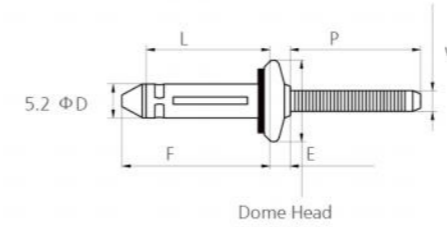

Body	AL5056
Mandrel	AL7A03
Washer	EPDM

No.	Art. Code	Part Number	Size	D (Max)	E (Max)	F (Max)	H (Max)	L (Max)	P (Min)	W (Max)	Hole Dia	Grip Range	Tensile ref.	Shear ref.
1	AATFS6604-6-3W	AATFS52175	5.2x17.5	Φ5.2	3.4	20.9	Φ11.6	17.9	25.4	2.95	Φ5.3 ~ Φ5.5	1.3 ~ 4.8	1800N	2700N
2	AATFS6604-6-4W	AATFS52191	5.2x19.1			22.5		19.5				1.6 ~ 6.4		
3	AATFS6604-6-6W	AATFS52222	5.2x22.2			25.6		22.6				4.7 ~ 9.5		
4	AATFS6604-6-8W	AATFS52254	5.2x25.4			28.8		25.8				7.9 ~ 12.7		
5	AATFS6604-6-10W	AATFS52286	5.2x28.6			32.0		29.0				11.1 ~ 15.9		
6	AATFS6604-6-12W	AATFS52318	5.2x31.8			35.2		32.2				14.3 ~ 19.1		

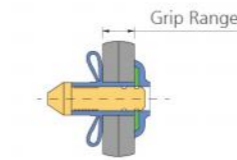
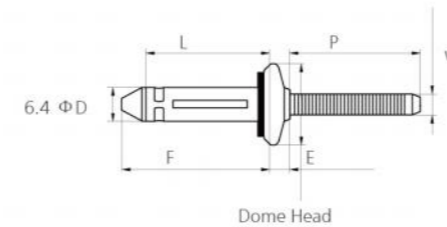

Body	AL5056
Mandrel	AL7A03
Washer	EPDM

No.	Art. Code	Part Number	Size	D (Max)	E (Max)	F (Max)	H (Max)	L (Max)	P (Min)	W (Max)	Hole Dia	Grip Range	Tensile ref.	Shear ref.
1	AATFS6604-8-4W	AATFS64202	6.4x20.2	Φ6.39	4.0	25.5	Φ14.7	20.5	25.4	3.9	Φ6.4 ~ Φ6.6	1.6 ~ 6.4	2500N	3780N
2	AATFS6604-8-6W	AATFS64234	6.4x23.4			28.7		23.7				3.2 ~ 9.5		
3	AATFS6604-8-8W	AATFS64265	6.4x26.5			31.8		26.8				6.4 ~ 12.7		
4	AATFS6604-8-10W	AATFS64297	6.4x29.7			35.0		30.0				9.5 ~ 15.9		

# 7.5mm Aluminum Watertight Folding Rivet

## Available Sizes

Φ7.5(9/32")

## Head Styles

Dome Head , Large Flange

## Materials

Body:AL5056  
Mandrel:AL7A03



7.5mm Aluminum Watertight Folding Rivet

RWMATE

Washen

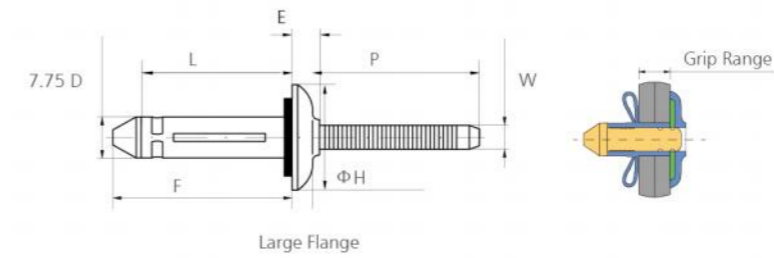

Body	AL5056
Mandrel	AL7A03
Washer	EPDM

No.	Art. Code	Part Number	Size	D (Max)	E (Max)	F (Max)	H (Max)	L (Max)	P (Min)	W (Max)	Hole Dia	Grip Range	Tensile ref.	Shear ref.
1	AATFS6605-9-6W	AATFSLF7528019	7.5×28	Φ7.75	5.33	32.6	Φ19.4	28.2	25.4	4.5	Φ7.8~Φ8.2	1.1 ~ 9.5	4400N	5600N
2	AATFS6605-9-10W	AATFSLF7534019	7.5×34			38.9		34.5				6.4 ~ 15.9		
3	AATFS6605-9-12W	AATFSLF7537019	7.5×37			42.1		37.7				9.5 ~ 19.1		

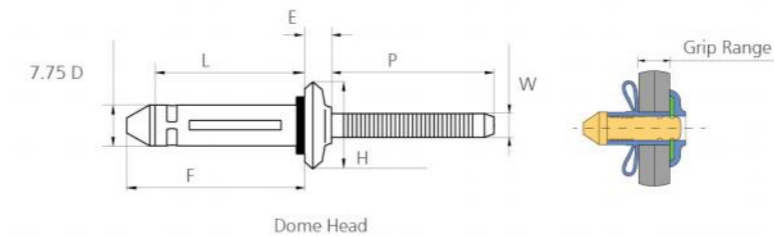

Body	AL5056
Mandrel	AL7A03
Washer	EPDM

No.	Art. Code	Part Number	Size	D (Max)	E (Max)	F (Max)	H (Max)	L (Max)	P (Min)	W (Max)	Hole Dia	Grip Range	Tensile ref.	Shear ref.
1	AATFS6603-9-6W	AATFS75280	7.5×28	Φ7.75	4.83	32.6	Φ15.9	28.2	25.4	4.5	Φ7.8~Φ8.2	0.8 ~ 9.5	4400N	5600N
2	AATFS6603-9-10W	AATFS75340	7.5×34			38.9		34.5				6.4 ~ 15.9		
3	AATFS6603-9-12W	AATFS75370	7.5×37			42.1		37.7				9.5 ~ 19.1		

# Full Carbon Steel Now-Lock Blind Rivet

## Available Sizes

Φ4.8(3/16"), Φ6.4(1/4"),  
Φ9.8(3/8")

## Head Styles

Dome Head, 100° Csk Head

## Materials

Body: Carbon Steel 10B21  
Mandrel: Carbon Steel 45K



Scan to View Test Video  
(Carbon Steel Now-Lock R8-6)  
In Youtube

Full Carbon Steel Now-Lock Blind Rivet

RVMATE

Washen

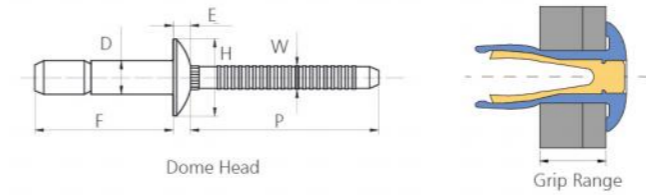

Material	Body	Carbon Steel 10B21
	Mandrel	Carbon Steel SWCH45K
Finish	Body	Zinc Plated
	Mandrel	Zinc Plated

\*IPX-7 Watertightness Approved!

Units: mm

No.	Part Number	Size	AVD.Art. Code	HUK.Art. Code	D	E (Max)	F (Max)	H (Max)	P (Min)	W (Max)	Hole Dia	Grip Range	Tensile ref.	Shear ref.	Breaking Load (Max)	Retention load (Min)
1	SSN-AVD48100	4.8×10	SSN-0604	SSN-R6-4	4.70 4.88	2.5	18.2	10.2	27.0	3.1	4.9-5.1	1.6-6.9	4440N	5780N	8500N	1000N
2	SSN-AVD48140	4.8×14	SSN-E0607	SSN-R6-E			24.6					1.6-11.0				
3	SSN-SC48140	4.8×14	SSN-0607	SSN-R6-7			22.4					5.4-11.0				
4	SSN-AVD48200	4.8×20	SSN-0610	/			27.6					9.5-15.8				
5	SSN-SC48200	4.8×20	/	SSN-R6-10			28.1					11.5-16.9				
6	SSN-AVD64140	6.4×14	SSN-0806	SSN-R8-6	6.40 6.58	3.1	25.3	13.5	27.0	4.1	6.7-6.9	2.1-9.5	8220N	11120N	15000N	1800N
7	SSN-AVD64200	6.4×20	SSN-E0810	SSN-R8-E			35.6					2.1-15.8				
8	SSN-SC64200	6.4×20	SSN-0810	SSN-R8-10			31.0					8.9-15.8				
9	SSN-AVD98210	9.8×21	SSN-1210	SSN-R12-12	9.70 9.88	4.5	40.3	20.5	35.0	6.2	10.0-10.4	3.1-15.5	17700N	26600N	32000N	2500N

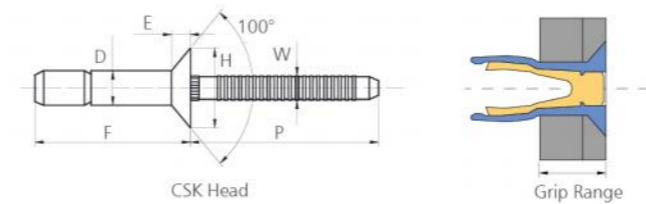

Material	Body	Carbon Steel 10B21
	Mandrel	Carbon Steel SWCH45K
Finish	Body	Zinc Plated
	Mandrel	Zinc Plated

\*IPX-7 Watertightness Approved!

Units: mm

No.	Part Number	Size	AVD.Art. Code	HUK.Art. Code	D	E (Max)	F (Max)	H (Max)	P (Min)	W (Max)	Hole Dia	Grip Range	Tensile ref.	Shear ref.	Breaking Load (Max)	Retention load (Min)
1	SSNC-AVD48120	4.8×12	SSNC-0606	SSNC-R6-6	4.70 4.88	2.1	20.2	9.2	27.0	3.1	4.9-5.1	3.2-8.4	4440N	5780N	8500N	1000N
2	SSNC-AVD48160	4.8×16	/	/			26.5					3.2-12.7				
3	SSNC-AVD64160	6.4×16	SSNC-0808	SSNC-R8-8	6.40 6.58	2.3	28.3	11.4	27.0	4.1	6.7-6.9	4.3-12.1	8220N	11120N	15000N	1800N
4	SSNC-AVD64220	6.4×22	/	/			36.5					4.3-18.4				
5	SSNC-AVD98260	9.8×26	/	/	9.70 9.88	3.7	45.0	16.5	35.0	6.2	10.0-10.4	6.1-19.0	15500N	25000N	32000N	2500N

# Full Stainless Steel Now-Lock Blind Rivet

## Available Sizes

Φ4.8 (3/16"), Φ6.4 (1/4")

## Head Styles

Dome Head, 100° CSK Head

## Materials

Body: 304 Stainless Steel  
Mandrel: 304 Stainless Steel



Scan to View Production Video In Youtube

Full Stainless Steel Now-Lock Blind Rivet

RWMATE

Washen

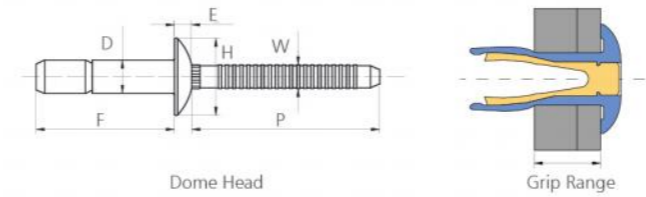

Material	Body	304 Stainless Steel
	Mandrel	304 Stainless Steel
Finish	Body	Polished
	Mandrel	Polished

\*IPX-7 Watertightness Approved!

Units: mm

No.	Part Number	Size	AVD.Art. Code	HUK.Art. Code	D	E (Max)	F (Max)	H (Max)	P (Min)	W (Max)	Hole Dia	Grip Range	Tensile ref.	Shear ref.	Breaking Load (Max)	Retention load (Min)
1	BBN48100	4.8×10	BBN-0604	BBN-U6-4	4.70 4.88	2.5	18.2	10.2	27.0	3.1	4.9-5.1	1.6-6.9	4440N	5800N	6500N	445N
2	BBN48140	4.8×14	BBN-E0607	BBN-U6-E			24.6					1.6-11.1				
3	BBN-SC48140	4.8×14	BBN-0607	BBN-U6-7			22.58					5.4-11.1				
4	BBN-SC48200	4.8×20	/	BBN-U6-10			28.09					11.6-16.9				
5	BBN64140	6.4×14	BBN-0806	BBN-U8-6	6.40	3.2	25.3	13.5	27.0	4.1	6.7-6.9	2.0-9.5	8010N	10500N	12000N	890N
6	BBN64150	6.4×15	BBN-0807	BBN-U8-7	6.58		2.1-11.1									
7	BBN64200	6.4×20	BBN-E0810	BBN-U8-E	6.40		2.0-15.9									
8	BBN-SC64200	6.4×20	BBN-0810	BBN-U8-10	6.58		8.9-15.9									
9	BBN98210	9.8×21	/	BBN-U12-12	9.70 9.88	4.4	41.9	19.5	35.0	6.2	10-10.4	3.0-15.9	19400N	26080N	/	/

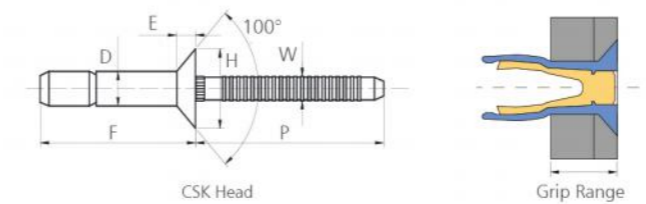

Material	Body	304 Stainless Steel
	Mandrel	304/302 Stainless Steel
Finish	Body	Polished
	Mandrel	Polished

\*IPX-7 Watertightness Approved!

Units: mm

No.	Part Number	Size	AVD.Art. Code	HUK.Art. Code	D	E (Max)	F (Max)	H (Max)	P (Min)	W (Max)	Hole Dia	Grip Range	Tensile ref.	Shear ref.	Breaking Load (Max)	Retention load (Min)
1	BBNC48120	4.8×12	BBNC-0606	BBNC-U6-6	4.70 4.88	2.2	20.2	9.2	27.0	3.1	4.9-5.1	3.2-8.4	4440N	5800N	6500N	445N
2	BBNC48160	4.8×16	/	/			26.5					3.2-12.7				
3	BBNC64160	6.4×16	BBNC-0808	BBNC-U8-8	6.40	2.4	28.3	11.4	27.0	4.1	6.7-6.9	4.3-12.1	8010N	10500N	12000N	890N
4	BBNC64220	6.4×22	/	/	6.58		4.3-17.5									

# Full Aluminum Now-Lock Blind Rivet

## Available Sizes

Φ4.8 (3/16"), Φ6.4 (1/4"),  
Φ9.8 (3/8")

## Head Styles

Dome Head, 100° CSK Head

## Materials

Body: Aluminum  
Mandrel: Aluminum



Full Aluminum Now-Lock Blind Rivet

RWMATE

Wasfen

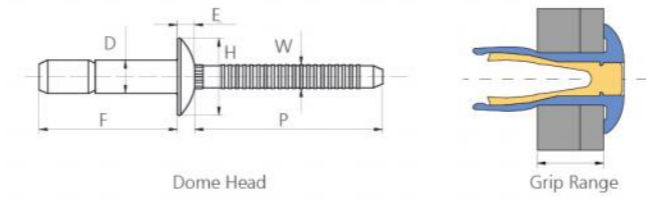

Material	Body	Aluminum
	Mandrel	Aluminum
Finish	Body	Natural
	Mandrel	Natural

\*IPX-7 Watertightness Approved!

Units: mm

No.	Part Number	Size	AVD.Art. Code	HUK.Art. Code	D	E (Max)	F (Max)	H (Max)	P (Min)	W (Max)	Hole Dia	Grip Range	Tensile ref.	Shear ref.	Breaking Load (Max)	Retention load (Min)
1	AAN48100	4.8×10	AAN-0604	AAN-B6-4	4.70 4.88	2.5	18.2	10.2	27.0	3.1	4.9-5.1	1.6-6.9	2225N	2700N	4200N	350N
2	AAN48140	4.8×14	AAN-E0607	AAN-B6-E			24.6					1.6-11.0				
3	AAN-SC48140	4.8×14	AAN-0607	AAN-B6-7			22.4					5.4-11.0	2000N	2660N		
4	AAN64140	6.4×14	AAN-0806	AAN-B8-6	6.40 6.58	3.1	25.3	13.5	27.0	4.1	6.7-6.9	2.1-9.5	3960N	5785N	7000N	450N
5	AAN64200	6.4×20	AAN-E0810	AAN-B8-E			35.6					2.1-15.8				
6	AAN-SC64200	6.4×20	AAN-0810	AAN-B8-10			31.0					8.9-15.8				
7	AAN98210	9.8×21	/	AAN-B12-12	9.70 9.88	4.5	40.3	20.5	35.0	6.2	10.0-10.4	3.1-15.5	8100N	13300N	14000N	1200N

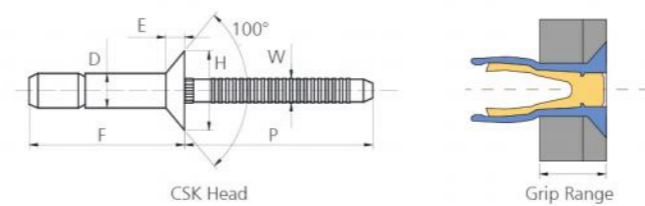

Material	Body	Aluminum
	Mandrel	Aluminum
Finish	Body	Natural
	Mandrel	Natural

\*IPX-7 Watertightness Approved!

Units: mm

No.	Part Number	Size	AVD.Art. Code	HUK.Art. Code	D	E (Max)	F (Max)	H (Max)	P (Min)	W (Max)	Hole Dia	Grip Range	Tensile ref.	Shear ref.	Breaking Load (Max)	Retention load (Min)
1	AANC48120	4.8×12	AANC-0606	AANC-B6-6	4.70 4.88	2.2	20.2	9.2	27.0	3.1	4.9-5.1	3.2-8.4	2225N	2700N	4200N	350N
2	AANC48160	4.8×16	/	/			26.5					3.2-12.7				
3	AANC64160	6.4×16	AANC-0808	AANC-B8-8	6.40 6.58	2.4	28.3	11.4	27.0	4.1	6.7-6.9	4.3-12.1	3960N	5785N	7000N	450N
4	AANC64220	6.4×22	/	/			36.5					4.3-18.4				

# Full Carbon Steel Mono-Lock Blind Rivet

## Available Sizes

Φ4.8(3/16"), Φ6.4(1/4")

## Head Styles

Dome Head , 100° Csk Head

## Materials

Body: Carbon Steel 10B21  
Mandrel: Carbon Steel 45K



Scan to View Test Video  
(Carbon Steel Mono-Lock 08-17)  
In Youtube

Full Carbon Steel Mono-Lock Blind Rivet

RVMATE

Washen

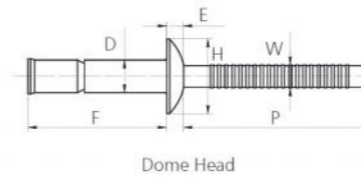

Dome Head

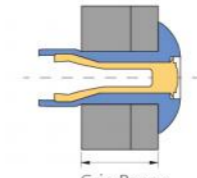

Grip Range

Material	Body	Carbon Steel 10B21
	Mandrel	Carbon Steel SWCH45K
Finish	Body	Zinc Plated
	Mandrel	Zinc Plated

\*IPX-7 Watertightness Approved!

Units: mm

No.	Part Number	Size	AVD.Art. Code	D	E (Max)	F (Max)	H (Max)	P (Min)	W (Max)	Hole Dia	Grip Range	Tensile ref.	Shear ref.	Breaking Load (Max)	Retention load (Min)
1	SSM-AVD48100	4.8×10	SSM-0613	4.70	2.1	18.2	10.1	27.0	3.1	4.9-5.1	1.6-6.9	5110N	6440N	7500N	600N
2	SSM-AVD48140	4.8×14	SSM-0617	4.80		24.5					1.6-11.0				
3	SSM-AVD64140	6.4×14	SSM-0817	6.40	2.9	23.7	13.4	27.0	4.1	6.7-7.0	2.1-9.5	10450N	11780N	12500N	1100N
4	SSM-AVD64190	6.4×19	SSM-0824	6.58		33.0					2.1-15.8				
5	SSM-AVD98213	9.8X21.3	SSM-1228	9.65	4.1	36.2	20.3	32.0	6.1	10.0-10.4	3.0-15.9	14850N	23730N	/	/
				9.9											

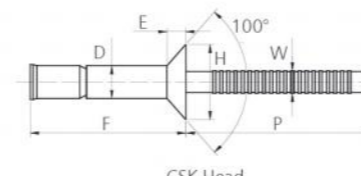

CSK Head

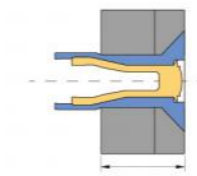

Grip Range

Material	Body	Carbon Steel 10B21
	Mandrel	Carbon Steel SWCH45K
Finish	Body	Zinc Plated
	Mandrel	Zinc Plated

\*IPX-7 Watertightness Approved!

Units: mm

No.	Part Number	Size	AVD.Art. Code	D	E (Max)	F (Max)	H (Max)	P (Min)	W (Max)	Hole Dia	Grip Range	Tensile ref.	Shear ref.	Breaking Load (Max)	Retention load (Min)
1	SSMC-AVD48120	4.8×12	SSMC-0615	4.70	2.2	20	8.8	27.0	3.1	4.9-5.1	3.2-8.3	5110N	6440N	7500N	600N
2	SSMC-AVD48160	4.8×16	SSMC-0619			26.5					3.2-12.2				
3	SSMC-AVD64160	6.4×16	SSMC-0821	6.40	2.4	26.3	10.1	27.0	4.1	6.7-7.0	3.2-12.1	10450N	11780N	12500N	1100N
4	SSMC-AVD64220	6.4×22	/	6.58		34.5					3.2-16.0				

# Full Stainless Steel Mono-Lock Blind Rivet

## Available Sizes

Φ4.8 (3/16"), Φ6.4 (1/4"),  
Φ9.8 (3/8")

## Head Styles

Dome Head, 100° CSK Head

## Materials

Body: 304 Stainless Steel  
Mandrel: 304/302 Stainless Steel

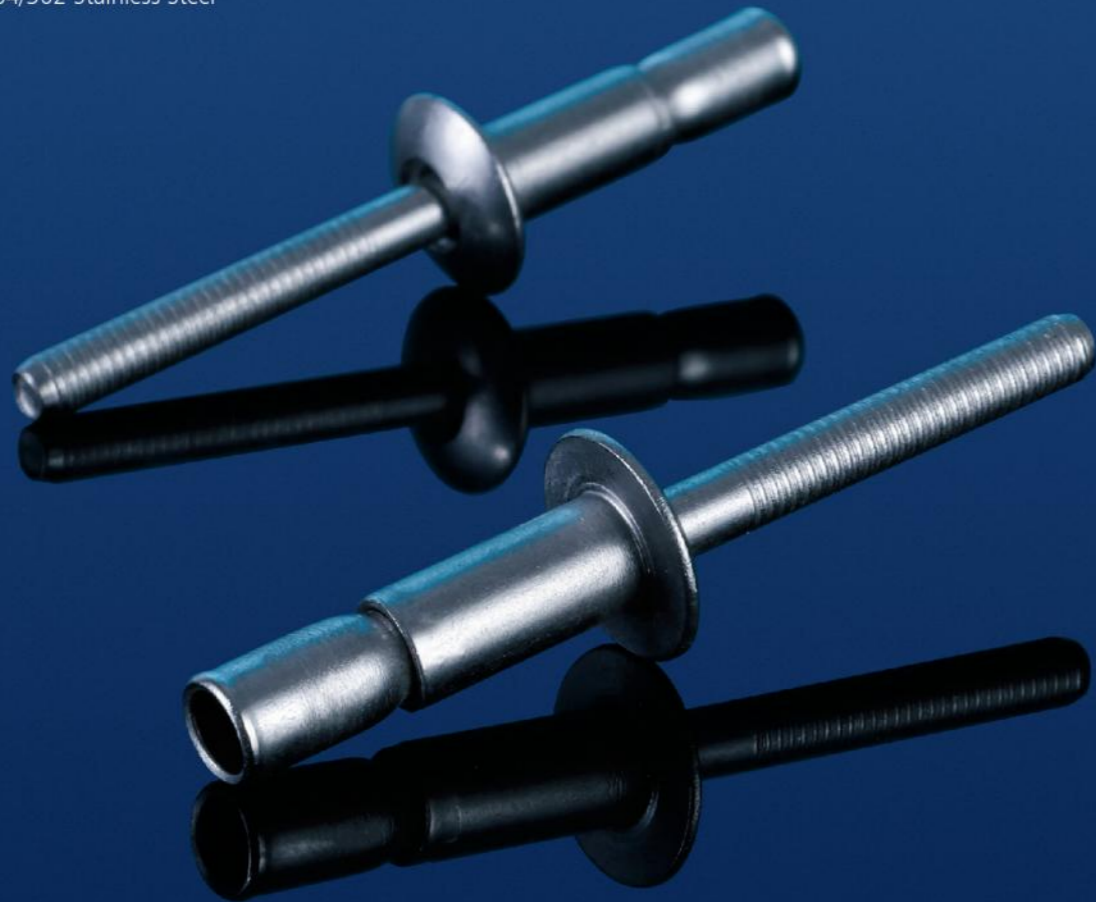

Full Stainless Steel Mono-Lock Blind Rivet

RWMATE

Washen

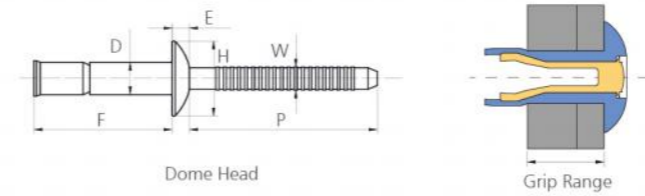

Material	Body	304 Stainless Steel
	Mandrel	304/302 Stainless Steel
Finish	Body	Polished
	Mandrel	Polished

\*IPX-7 Watertightness Approved!

Units: mm

No.	Part Number	Size	AVD.Art. Code	D	E (Max)	F (Max)	H (Max)	P (Min)	W (Max)	Hole Dia	Grip Range	Tensile ref.	Shear ref.	Breaking Load (Max)	Retention load (Min)
1	BBM48100	4.8×10	BBM-0613	4.8	2.2	18.2	10.1	27.0	3.1	4.9-5.1	1.6-6.5	5100N	5400N	7000N	445N
2	BBM48140	4.8×14	BBM-0617			24.4					1.6-11.0				
3	BBM64140	6.4×14	BBM-0817	6.4	3.0	26.7	13.4	27.0	4.1	6.7-7.0	2.1-9.5	9000N	11000N	12000N	1112N
4	BBM64190	6.4×19	BBM-0824			36.5					2.1-16.0				
5	BBM98210	9.8×21	BBM-1228	9.8	4.0	36.2	20.0	32.0	6.15	10.0-10.4	3.0-16.0	19400N	26080N	20000N	2400N

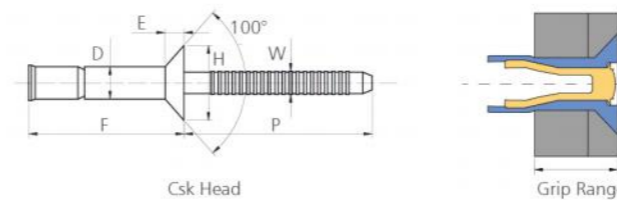

Material	Body	304 Stainless Steel
	Mandrel	304/302 Stainless Steel
Finish	Body	Polished
	Mandrel	Polished

\*IPX-7 Watertightness Approved!

Units: mm

No.	Part Number	Size	Art. Code	D	E (Max)	F (Max)	H (Max)	P (Min)	W (Max)	Hole Dia	Grip Range	Tensile ref.	Shear ref.	Breaking Load (Max)	Retention load (Min)
1	BBMC48120	4.8×12	BBMC-0615	4.8	2.2	20.2	9.0	27.0	3.1	4.9-5.1	3.2-8.4	5100N	6400N	7000N	445N
2	BBMC48160	4.8×16	/			26.5					3.2-12.7				
3	BBMC64160	6.4×16	BBMC-0821	6.4	2.4	28.3	10.5	27.0	4.1	6.7-7.0	4.1-12.1	9000N	11000N	12000N	1112N
4	BBMC64220	6.4×22	/			37.6					4.1-17.5				

# Full Aluminum Mono-Lock Blind Rivet

## Available Sizes

Φ4.8 (3/16"), Φ6.4 (1/4")

## Head Styles

Dome Head, 100° CSK Head

## Materials

Body: Aluminum  
Mandrel: Aluminum



Full Aluminum Mono-Lock Blind Rivet

RWMATE

Washen

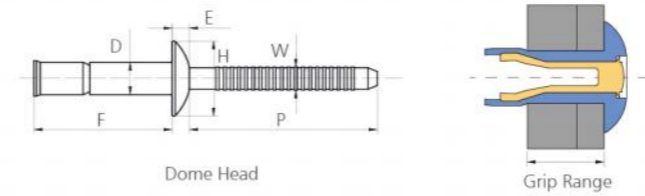

Material	Body	Aluminum
	Mandrel	Aluminum
Finish	Body	Natural
	Mandrel	Natural

\*IPX-7 Watertightness Approved!

Units: mm

No.	Part Number	Size	Art. Code	D	E (Max)	F (Max)	H (Max)	P (Min)	W (Max)	Hole Dia	Grip Range	Tensile ref.	Shear ref.	Breaking Load (Max)	Retention load (Min)
1	AAM48100	4.8×10	AAM-0613	4.70 4.88	2.1	18.2	10.1	27.0	3.1	4.9-5.1	1.6-6.9	2220N	3000N	4000N	250N
2	AAM48140	4.8×14	AAM-0617			24.5					1.6-11.0				
3	AAM64140	6.4×14	AAM-0817	6.40 6.58	2.9	23.7	13.4	27.0	4.1	6.7-7.0	2.1-9.5	4220N	6000N	6800N	550N
4	AAM64190	6.4×19	AAM-0824			33.0					2.1-15.8				
5	AAM98210	9.8×21.3	AAM-1228	9.65 9.90	4.1	36.2	20.3	32.0	6.1	10.0-10.4	3.0-15.9	8500N	11500N	/	/

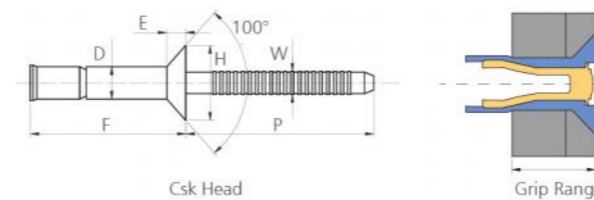

Material	Body	Aluminum
	Mandrel	Aluminum
Finish	Body	Natural
	Mandrel	Natural

\*IPX-7 Watertightness Approved!

Units: mm

No.	Part Number	Size	Art. Code	D	E (Max)	F (Max)	H (Max)	P (Min)	W (Max)	Hole Dia	Grip Range	Tensile ref.	Shear ref.	Breaking Load (Max)	Retention load (Min)
1	AAMC48120	4.8×12	AAMC-0615	4.70 4.88	2.2	20	8.8	27.0	3.1	4.9-5.1	3.2-8.4	2110N	2890N	4000N	250N
2	AAMC48160	4.8×16	AAMC-0619			26.5					3.2-12.2				
3	AAMC64160	6.4×16	AAMC-0821	6.40 6.58	2.4	26.3	10.1	27.0	4.1	6.7-7.0	3.2-12.1	4220N	6000N	6800N	550N
4	AAMC64220	6.4×22	/			34.5					3.2-16.0				

# Full Carbon Steel Hem-Firm Blind Rivet

## Available Sizes

Φ6.4 (1/4")

## Head Styles

Dome Head , Large Head ,  
100° Csk Head

## Materials

Body: Carbon Steel 10B21  
Mandrel: Carbon Steel 45K



Scan to View Test Video  
(Hem-Firm Type A 08-17)  
In Youtube

Full Carbon Steel Hem-Firm Blind Rivet

RVMATE

Washen

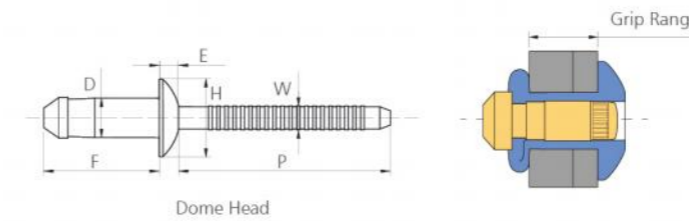

Material	Body	Carbon Steel 10B21
	Mandrel	Carbon Steel SWCH45K
Finish	Body	Zinc Plated
	Mandrel	Zinc Plated

\*IPX-7 Watertightness Approved!

No.	Part Number	Art. Code	Before Grip [F] (max)	Grip Range	Rivet Size (mm)	Head Dia [H] (Max)	Head Height [E] (Max)	Mandrel Dia [W] (Max)	Mandrel Reveal [P] (Min)	Hole Dia	Typical Ultimate Strength			
											Tensile ref.	Shear ref.	Breaking Load (Max)	Retention load (Min)
1	SSH-A64090	SSH-A-0812	13.7	1.50 ~ 3.50	6.40	13.40	3.40	4.20	27.00	6.60 ~ 6.80	8800N	10500N	15000N	1800N
2	SSH-A64105	SSH-A-0813	15.0	2.80 ~ 4.80								12000N		
3	SSH-A64110	SSH-A-0814	15.6	3.50 ~ 5.35								12500N		
4	SSH-A64125	SSH-A-0815	17.0	4.80 ~ 6.80								14000N		
5	SSH-A64145	SSH-A-0817	19.0	6.80 ~ 8.80								15000N		
6	SSH-A64150	SSH-A-0818	19.7	7.50 ~ 9.50								16000N		
7	SSH-A64165	SSH-A-0819	21.0	8.80 ~ 10.80										
8	SSH-A64185	SSH-A-0821	23.0	10.80 ~ 12.80										
9	SSH-A64205	SSH-A-0823	25.2	12.80 ~ 14.80										
10	SSH-A64225	SSH-A-0825	27.2	14.80 ~ 16.80										
11	SSH-A64245	SSH-A-0827	29.5	16.80 ~ 18.80										
12	SSH-A64265	SSH-A-0829	31.5	18.80 ~ 20.80										

# Rivlok Double-locking System

## Available Sizes

Φ4.8 (3/16"), Φ6.4 (1/4")

## Head Styles

Dome Head, Truss Head

## Materials

Body: Carbon Steel  
Mandrel: Carbon Steel



Scan to View Test Video  
(Rivlok R8-7)  
In Youtube

Double-locking System

RVMATE

Washen

## Rivlok Double-locking System

Mandrel	Material	Carbon steel
	Surface	Green trivalent electroplating blue white zinc
Body	Material	Carbon steel
	Surface	Green trivalent electroplating blue white zinc

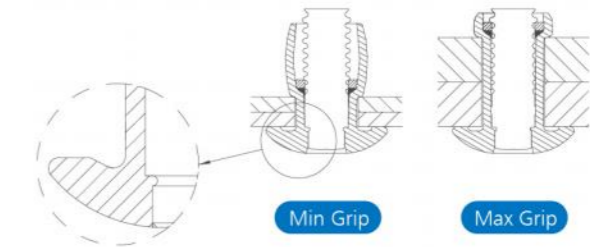
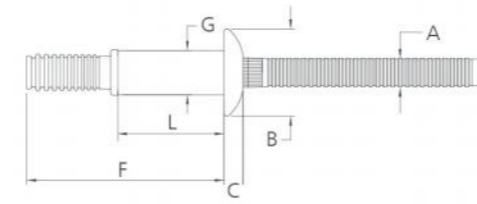

Units: mm

Part No.	Art. Code	Grip Range		Hole Size		A	B		C		L	F	G		Tensile	Shear	RETENTION
		Min	Max	Min	Max	Max	Min	Max	Min	Max	Max	Ref	Min	Max			
(Dome Head)																	
SSNLK48116	SNLK-R6-5	1.60	7.90								11.60	22.90					
				4.90	5.10	3.10	8.80	9.90	/	3.05			4.65	4.85	4400N	8400N	660N
SSNLK48148	SSNLK-R6-7	4.75	11.10								14.80	26.00					
SSNLK64142	SSNLK-R8-6	2.50	9.50								14.20	27.00					
SSNLK64158	SSNLK-R8-7	4.75	11.10								15.80	28.60					
SSNLK64206	SSNLK-R8-10	9.50	15.90	6.70	6.90	4.20	12.50	13.50	2.80	3.20	20.60	33.30	6.35	6.60	8400N	15500N	1700N
SSNLK64237	SSNLK-R8-12	12.70	19.10								23.70	36.50					
SSNLK64269	SSNLK-R8-14	15.90	22.20								26.90	39.70					
(Truss Head)																	
SSNLKTF6414214	SSNLKTF-R8-6	2.50	9.50								14.20	27.00					
SSNLKTF6415814	SSNLKTF-R8-7	4.75	11.10								15.80	28.60					
SSNLKTF6420614	SSNLKTF-R8-10	9.50	15.90	6.60	6.90	4.20	13.50	15.00	2.80	3.20	20.60	33.30	6.35	6.60	8400N	15500N	1700N
SSNLKTF6423714	SSNLKTF-R8-12	12.70	19.10								23.70	36.50					
SSNLKTF6426914	SSNLKTF-R8-14	15.90	22.20								26.90	39.70					

# Rivbulb Double-locking System

## Available Sizes

Φ4.8 (3/16"), Φ6.4 (1/4")

## Head Styles

Dome Head, CSK Head

## Materials

Body: Carbon Steel  
Mandrel: Carbon Steel



Scan to View Test Video  
(Rivbulb R8-M6)  
in Youtube

Double-locking System

RVMATE

Wasfen

## Rivbulb Double-locking System

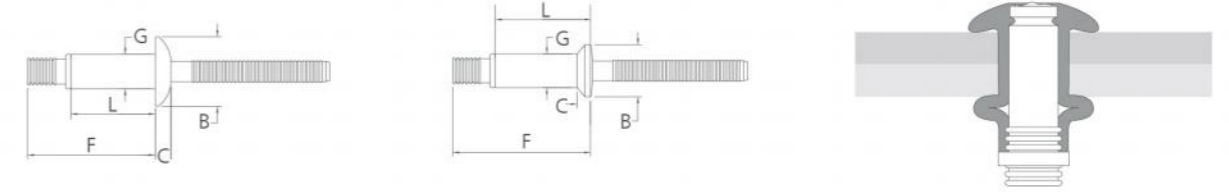

Units: mm

Part No.	Art. Code	Grip Range		Hole Size		B	C	L	F	G	Tensile	Shear	RETENTION
		Min	Max	Min	Max								
(Dome Head)													
SSHBU48083	SSHBU-R6-M2	1.90	2.80					8.30	15.00				
SSHBU48093	SSHBU-R6-M3	2.20	3.80					9.30	17.10				
SSHBU48103	SSHBU-R6-M4	3.20	4.80					10.30	17.70				
SSHBU48113	SSHBU-R6-M5	4.20	5.80					11.30	18.60				
SSHBU48123	SSHBU-R6-M6	5.20	6.80	4.90	5.10	9.80	2.60	12.30	19.70	4.75	4600N	7500N	660N
SSHBU48133	SSHBU-R6-M7	6.20	7.80					13.30	20.70				
SSHBU48143	SSHBU-R6-M8	7.20	8.80					14.30	21.70				
SSHBU48153	SSHBU-R6-M9	8.20	9.80					15.30	22.70				
SSHBU48163	SSHBU-R6-M10	9.20	10.80					16.30	23.70				
SSHBU64111	SSHBU-R8-M2	1.50	3.50					11.10	19.30			11500N	
SSHBU64124	SSHBU-R8-M3	2.80	4.80					12.40	21.90			12000N	
SSHBU64134	SSHBU-R8-M4	3.80	5.80					13.40	22.80			12200N	
SSHBU64144	SSHBU-R8-M5	4.80	6.80					14.40	23.20			13300N	
SSHBU64154	SSHBU-R8-M6	5.80	7.80					15.40	23.90			14200N	
SSHBU64164	SSHBU-R8-M7	6.80	8.80	6.60	6.90	13.50	3.20	16.40	24.90	6.40	8400N		1300N
SSHBU64174	SSHBU-R8-M8	7.80	9.80					17.40	25.90				
SSHBU64184	SSHBU-R8-M9	8.80	10.80					18.40	26.90				
SSHBU64194	SSHBU-R8-M10	9.80	11.80					19.40	28.00			15500N	
SSHBU64204	SSHBU-R8-M11	10.80	12.80					20.40	28.90				
SSHBU64214	SSHBU-R8-M12	11.80	13.80					21.40	30.00				
SSHBU64224	SSHBU-R8-M13	12.80	14.80					22.40	31.00				
SSHBU80158	SSHBU-R10-3	3.80	6.40					15.80	28.30				
SSHBU80170	SSHBU-R10-4	5.10	7.60					17.00	29.60				
SSHBU80183	SSHBU-R10-5	6.40	8.90					18.30	30.90				
SSHBU80196	SSHBU-R10-6	7.60	10.20	8.30	8.60	16.60	3.90	19.60	32.10	8.00	13000N	22000N	2000N
SSHBU80208	SSHBU-R10-7	8.90	11.40					20.80	33.40				
SSHBU80221	SSHBU-R10-8	10.20	12.70					22.10	34.70				
SSHBU80234	SSHBU-R10-9	11.40	14.00					23.40	36.00				
SSHBU80246	SSHBU-R10-10	12.70	15.20					24.60	37.20				
(CSK Head)													
SSHBUC64134	SSHBUC-R8-M4	3.80	5.80					13.40	22.00			12200N	
SSHBUC64144	SSHBUC-R8-M5	4.80	6.80					14.40	23.90			13300N	
SSHBUC64154	SSHBUC-R8-M6	5.80	7.80					15.40	25.90			14200N	
SSHBUC64164	SSHBUC-R8-M7	6.80	8.80	6.60	6.90	10.40	3.30	16.40	26.40	6.40	8400N		1300N
SSHBUC64184	SSHBUC-R8-M9	8.80	10.80					18.40	27.10				
SSHBUC64194	SSHBUC-R8-M10	9.80	11.80					19.40	28.10			15500N	
SSHBUC64224	SSHBUC-R8-M13	12.80	14.80					22.40	31.10				
SSHBUC80196	SSHBUC-R10-5	6.40	8.90					19.60	31.90				
SSHBUC80208	SSHBUC-R10-6	7.60	10.20					20.80	33.10				
SSHBUC80221	SSHBUC-R10-7	8.90	11.40					22.10	34.40				
SSHBUC80234	SSHBUC-R10-8	10.20	12.70					23.40	35.70				
SSHBUC80246	SSHBUC-R10-9	11.40	14.00	8.30	8.60	11.70	4.10	24.60	36.90	8.00	13000N	22000N	2000N
SSHBUC80259	SSHBUC-R10-10	12.70	15.20					25.90	38.20				
SSHBUC80272	SSHBUC-R10-11	14.00	16.50					27.20	39.50				
SSHBUC80285	SSHBUC-R10-12	15.20	17.80					28.50	40.70				
SSHBUC80297	SSHBUC-R10-13	16.50	19.10					29.70	42.00				

# Carbon Steel High Strength Lockbolt System

## Available Sizes

Φ4.8 (3/16"), Φ6.4 (1/4"),  
 Φ8.0 (5/16"), Φ9.6(3/8"),  
 Φ13.0(1/2"), Φ16.0(5/8"),  
 Φ19.0(3/4"), Φ22.0(7/8")

## Head Styles

Dome Head

## Materials

Body: Carbon Steel  
 Mandrel: Carbon Steel



Scan to View Test Video  
 (Carbon Steel High Strength Lockbolt R8-4)  
 In Youtube

Carbon Steel High Strength Lockbolt System

RVMATE

Washen

## Carbon Steel High Strength Lockbolt System

Mandrel	Material	Carbon steel
	Surface	Green trivalent electroplating blue white zinc
Body	Material	Carbon steel
	Surface	Green trivalent electroplating blue white zinc



Pin

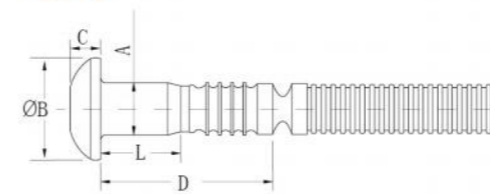

Standard Collar

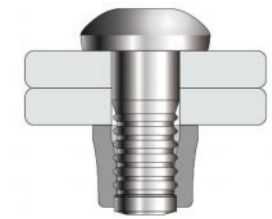
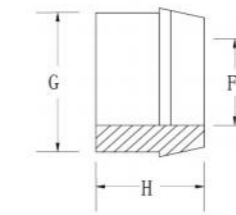

Units: mm

Pin		Grip Range		Hole Size	A	B	C	D	L	Standard Collar			Tensile	Shear
Part No.	Art. Code	Min	Max					Ref	Ref	F	G	H		
SLBP48130	SLBP-R6-4	4.8	7.9	5.1	4.9 (±0.2)	9.5 (±0.5)	3.0 (±0.4)	13.0	6.0	4.9	8.05	6.0	7500N	7800N
SLBP48150	SLBP-R6-5	6.4	9.5					15.0	8.0					
SLBP48170	SLBP-R6-6	7.9	11.1					17.0	10.0					
SLBP48180	SLBP-R6-7	9.5	12.7					18.0	11.0					
SLBP48200	SLBP-R6-8	11.1	14.3					20.0	13.0					
SLBP48210	SLBP-R6-9	12.7	15.9					21.0	14.0					
SLBP48230	SLBP-R6-10	14.3	17.5					23.0	16.0					
SLBP48240	SLBP-R6-11	15.9	19.1					24.0	17.0					
SLBP48260	SLBP-R6-12	17.5	20.7					26.0	19.0					
SLBP48280	SLBP-R6-13	19.1	22.2					28.0	21.0					
SLBP48290	SLBP-R6-14	20.7	23.8					29.0	22.0					
SLBP48310	SLBP-R6-15	22.2	25.4					31.0	24.0					
SLBP48320	SLBP-R6-16	23.8	27.0					32.0	25.0					

# Carbon Steel High Strength Lockbolt System

## Available Sizes

Φ4.8 (3/16"), Φ6.4 (1/4"),  
 Φ8.0 (5/16"), Φ9.6 (3/8"),  
 Φ13.0 (1/2"), Φ16.0 (5/8"),  
 Φ19.0 (3/4"), Φ22.0 (7/8")

## Head Styles

Dome Head

## Materials

Body: Carbon Steel  
 Mandrel: Carbon Steel



Units: mm

Pin		Grip Range		Hole Size	A	B	C	D	L	Standard Collar			Tensile	Shear
Part No.	Art. Code	Min	Max					Ref	Ref	F	G	H		
SLBP64125	SLBP-R8-2	1.6	4.8	6.6	6.4 (±0.2)	12.2 (±0.5)	3.2 (±0.4)	12.5	3.0	6.4	10.15	7.9	12500N	13500N
SLBP64145	SLBP-R8-3	3.2	6.4					14.5	5.0					
SLBP64155	SLBP-R8-4	4.8	7.9					15.5	6.0					
SLBP64175	SLBP-R8-5	6.4	9.5					17.5	8.0					
SLBP64195	SLBP-R8-6	7.9	11.1					19.5	10.0					
SLBP64205	SLBP-R8-7	9.5	12.7					20.5	11.0					
SLBP64225	SLBP-R8-8	11.1	14.3					22.5	13.0					
SLBP64235	SLBP-R8-9	12.7	15.9					23.5	14.0					
SLBP64255	SLBP-R8-10	14.3	17.5					25.5	16.0					
SLBP64265	SLBP-R8-11	15.9	19.1					26.5	17.0					
SLBP64285	SLBP-R8-12	17.5	20.7					28.5	19.0					
SLBP64305	SLBP-R8-13	19.1	22.2					30.5	21.0					
SLBP64315	SLBP-R8-14	20.7	23.8					31.5	22.0					
SLBP64335	SLBP-R8-15	22.2	25.4					33.5	24.0					
SLBP64345	SLBP-R8-16	23.8	27.0					34.5	25.0					
SLBP80191	SLBP-R10-4	3.2	9.5	8.2	8.1 (±0.05)	16 (±0.8)	4.8 (±0.3)	19.1	6.0	7.8	12.4	9.5	21000N	21500N
SLBP80222	SLBP-R10-6	6.4	12.7					22.2	10.0					
SLBP80254	SLBP-R10-8	9.5	15.9					25.4	13.0					
SLBP80286	SLBP-R10-10	12.7	19.1					28.6	16.0					
SLBP80318	SLBP-R10-12	15.9	22.2					31.8	19.0					
SLBP80349	SLBP-R10-14	19.1	25.4					34.9	22.0					
SLBP80381	SLBP-R10-16	22.2	28.6					38.1	25.0					
SLBP80412	SLBP-R10-18	25.4	31.8					41.2	28.0					
SLBP80444	SLBP-R10-20	28.9	34.9					44.4	32.0					

Units: mm

Pin		Grip Range		Hole Size	A	B	C	D	L	Standard Collar			Tensile	Shear
Part No.	Art. Code	Min	Max					Ref	Ref	F	G	H		
SLBP96207	SLBP-R12-4	3.2	9.5	9.8	9.7 (±0.05)	19 (±1.0)	6.0 (±0.3)	20.7	6.0	9.6	15.2	12.0	30000N	31000N
SLBP96238	SLBP-R12-6	6.4	12.7					23.8	10.0					
SLBP96270	SLBP-R12-8	9.5	15.9					27.0	13.0					
SLBP96301	SLBP-R12-10	12.7	19.1					30.1	16.0					
SLBP96332	SLBP-R12-12	15.9	22.2					33.2	19.0					
SLBP96364	SLBP-R12-14	19.1	25.4					36.4	22.0					
SLBP96396	SLBP-R12-16	22.2	28.6					39.6	25.0					
SLBP96428	SLBP-R12-18	25.4	31.8					42.8	28.0					
SLBP96460	SLBP-R12-20	28.9	34.9					46.0	32.0					
SLBP130308	SLBP-R16-4	6.4	12.7					13.5	12.8 (±0.3)					
SLBP130371	SLBP-R16-8	12.7	19.1	37.1	12.0									
SLBP130435	SLBP-R16-12	19.1	25.4	43.5	18.0									
SLBP130499	SLBP-R16-16	25.4	31.8	49.9	24.0									
SLBP130562	SLBP-R16-20	31.8	38.1	56.2	31.0									
SLBP130626	SLBP-R16-24	38.1	44.5	62.6	37.0									
SLBP130689	SLBP-R16-28	44.5	50.8	68.9	44.0									
SLBP130753	SLBP-R16-32	50.8	57.1	75.3	50.0									
SLBP130816	SLBP-R16-36	57.1	63.5	81.6	57.0									
SLBP130880	SLBP-R16-40	63.5	69.9	88.0	63.0									
SLBP130943	SLBP-R16-44	69.9	76.2	94.3	70.0									
SLBP1301007	SLBP-R16-48	76.2	82.6	100.7	77.0									
SLBP1301070	SLBP-R16-52	82.6	89.0	107.0	83.0									

Units: mm

Pin		Grip Range		Hole Size	A	B	C	D	L	Standard Collar			Tensile	Shear
Part No.	Art. Code	Min	Max					Ref	Ref	F	G	H		
SLBP160364	SLBP-R20-4	6.4	12.7	17.0	16.0 (±0.3)	29.0 (±0.5)	10.0 (±0.5)	36.4	6.0	16.6	25.1	22.0	120000N	100000N
SLBP160428	SLBP-R20-8	12.7	19.1					42.8	12.0					
SLBP160491	SLBP-R20-12	19.1	25.4					49.1	18.0					
SLBP160555	SLBP-R20-16	25.4	31.8					55.5	24.0					
SLBP160618	SLBP-R20-20	31.8	38.1					61.8	31.0					
SLBP160681	SLBP-R20-24	38.1	44.5					68.1	37.0					
SLBP160745	SLBP-R20-28	44.5	50.8					74.5	44.0					
SLBP160809	SLBP-R20-32	50.8	57.1					80.9	50.0					
SLBP160872	SLBP-R20-36	57.1	63.5					87.2	57.0					
SLBP160936	SLBP-R20-40	63.5	69.9					93.6	63.0					
SLBP160999	SLBP-R20-44	69.9	76.2	99.9	70.0									
SLBP1601063	SLBP-R20-48	76.2	82.6	106.3	77.0									
SLBP1601126	SLBP-R20-52	82.6	89.0	112.6	83.0									
SLBP190386	SLBP-R24-4	6.4	12.7	20.5	19.2 (±0.3)	35.0 (±0.5)	12.0 (±0.5)	38.6	6.0	19.8	29.7	24.0	181800N	146900N
SLBP190449	SLBP-R24-8	12.7	19.1					44.9	12.0					
SLBP190513	SLBP-R24-12	19.1	25.4					51.3	18.0					
SLBP190576	SLBP-R24-16	25.4	31.8					57.6	24.0					
SLBP190640	SLBP-R24-20	31.8	38.1					64.0	31.0					
SLBP190703	SLBP-R24-24	38.1	44.5					70.3	37.0					
SLBP190767	SLBP-R24-28	44.5	50.8					76.7	44.0					
SLBP190830	SLBP-R24-32	50.8	57.1					83.0	50.0					
SLBP190894	SLBP-R24-36	57.1	63.5					89.4	57.0					
SLBP190957	SLBP-R24-40	63.5	69.9					95.7	63.0					
SLBP1901021	SLBP-R24-44	69.9	76.2	102.1	70.0									
SLBP1901084	SLBP-R24-48	76.2	82.6	108.4	77.0									
SLBP1901148	SLBP-R24-52	82.6	89.0	114.8	83.0									
SLBP220488	SLBP-R28-8	12.7	19.1	23.5	22.3 (±0.3)	40.5 (±0.5)	13.9 (±0.5)	48.8	12.0	23.4	34.6	28.1	250000N	196000N
SLBP220551	SLBP-R28-12	19.1	25.4					55.1	18.0					
SLBP220615	SLBP-R28-16	25.4	31.8					61.5	24.0					
SLBP220678	SLBP-R28-20	31.8	38.1					67.8	31.0					
SLBP220742	SLBP-R28-24	38.1	44.5					74.2	37.0					
SLBP220805	SLBP-R28-28	44.5	50.8					80.5	44.0					
SLBP220869	SLBP-R28-32	50.8	57.1					86.9	50.0					
SLBP220932	SLBP-R28-36	57.1	63.5					93.2	57.0					
SLBP220996	SLBP-R28-40	63.5	69.9					99.6	63.0					
SLBP2201059	SLBP-R28-44	69.9	76.2					105.9	70.0					
SLBP2201123	SLBP-R28-48	76.2	82.6	112.3	77.0									
SLBP2201186	SLBP-R28-52	82.6	89.0	118.6	83.0									

# Carbon Steel High Strength Mi-Lock System

## Available Sizes

Φ4.8 (3/16"), Φ6.4 (1/4"),  
Φ8.0 (5/16")

## Head Styles

Standard Head  
"CSK" Head  
"T" Head

## Materials

Body: Carbon Steel  
Mandrel: Carbon Steel



Carbon Steel High Strength Mi-Lock System

RWMATE

Washen

## Carbon Steel High Strength Mi-Lock System

Collar	Material	Carbon steel
	Surface	Green trivalent electroplating blue white zinc
Pin	Material	Carbon steel
	Surface	Green trivalent electroplating blue white zinc

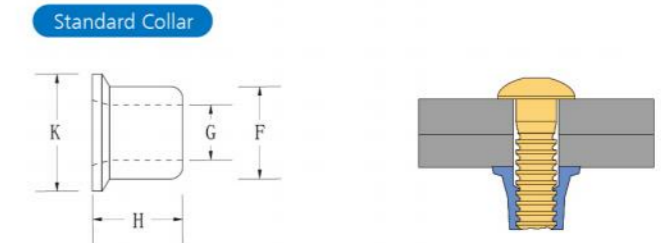
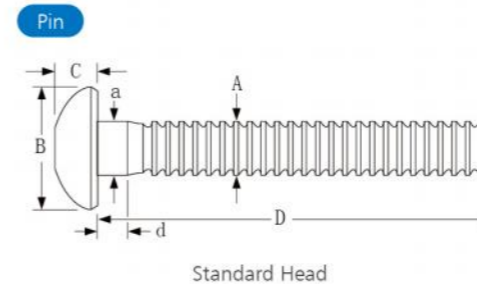

Units: mm

Pin		Grip Range		Hole Size Max.	A Max.	Dome Head		D	a Max.	d Ref.	Standard Collar				Tensile	Shear
Part No.	Art. Code	Min	Max			B	C				F	G	H	K		
SMLP0410	MGPB-R6-10G	1.6	15.9	5.6	4.7	9.1-9.9	2.8-3.2	45.0-46.5	4.9	2.2	7.7-8.0	4.8-5.2	6.8-7.2	9.1-9.9	7343N	7676N
SMLP0420	MGPB-R6-20G	7.9	31.8					59.8-61.3		7.9						
SMLP0610	MGPB-R8-10G	3.2	15.9	7.1	6.4	12.2-13.2	3.4-3.9	49.9-51.8	6.6	3.2	10.0-10.3	6.4-6.6	9.3-9.8	12.3-13.1	13128N	9790N
SMLP0620	MGPB-R8-20G	7.9	31.8					65.0-66.9		7.9						
SMLP0812	MGPB-R10-12G	3.2	19.1	9.1	7.9	15.2-16.5	4.6-5.2	59.4-60.7	8.2	2.5	12.7-13.0	7.9-8.1	10.9-11.4	15.4-16.4	19580N	13350N
SMLP0822	MGPB-R10-22G	15.9	34.9					72.1-73.4		14.0						

# Carbon Steel High Strength Mi-Lock System

## Available Sizes

Φ4.8 (3/16"), Φ6.4 (1/4"),  
Φ8.0 (5/16")

## Head Styles

Standard Head  
"CSK" Head  
"T" Head

## Materials

Body: Carbon Steel  
Mandrel: Carbon Steel



Pin

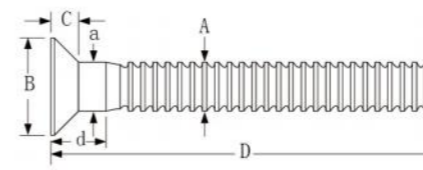

"CSK" Head

Standard Collar

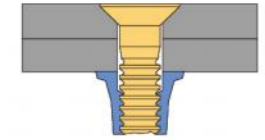
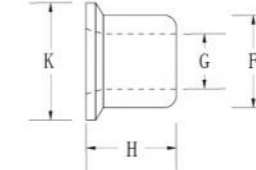

Units: mm

Pin		Grip Range		Hole Size Max.	A Max.	Dome Head		D	a Max.	d Ref.	Standard Collar				Tensile	Shear
Part No.	Art. Code	Min	Max			B	C				F	G	H	K		
SMLCP0410	MGP90-R6-10G	1.6	15.9	5.6	4.7	8.3-9.1	1.9-2.3	45.0-46.5	4.9	/	7.7-8.0	4.8-5.2	6.8-7.2	9.1-9.9	7343N	7676N
SMLCP0420	MGP90-R6-20G	7.9	31.8					59.8-61.3	7.9							
SMLCP0610	MGP90-R8-10G	3.2	15.9	7.1	6.4	11.0-12.1	2.9-3.3	49.9-51.8	6.6	/	10.0-10.3	6.4-6.6	9.3-9.8	12.3-13.1	13128N	9790N
SMLCP0620	MGP90-R8-20G	7.9	31.8					65.0-66.9	7.9							

Pin

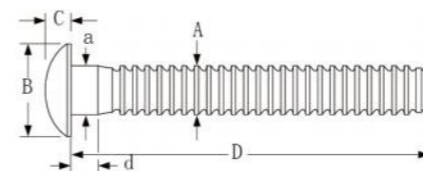

"T" Head

Standard Collar

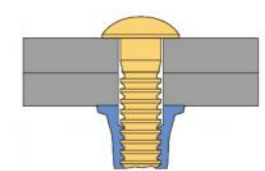
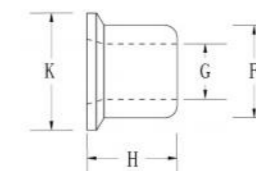

Units: mm

Pin		Grip Range		Hole Size Max.	A Max.	Dome Head		D	a Max.	d Ref.	Standard Collar				Tensile	Shear
Part No.	Art. Code	Min	Max			B	C				F	G	H	K		
SMLTP0410	MGP98T-R6-10G	1.6	15.9	5.6	4.7	11.9-12.4	2.5-2.8	45.0-46.5	4.9	2.2	7.7-8.0	4.8-5.2	6.8-7.2	9.1-9.9	7343N	7676N
SMLTP0420	MGP98T-R6-20G	7.9	31.8					59.8-61.3	7.9							

# Full Carbon Steel Boom-Lock Blind Rivet

## Available Sizes

Φ2.4(3/32"), Φ3.2(1/8"),  
Φ4.0(5/32"), Φ4.8(3/16"),  
Φ6.4(1/4")

## Materials

Body: Low-carbon Steel  
Mandrel: High-carbon Steel



Scan to View Test Video  
(Carbon Steel Boom-Lock R8-6)  
In Youtube

Full Carbon Steel Boom-Lock Blind Rivet

RVMATE

Washen

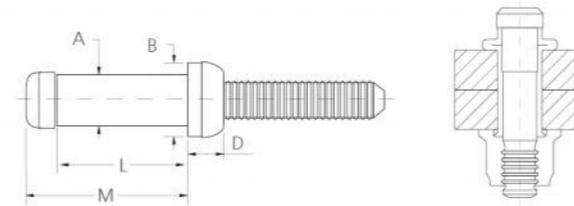

Material	Body	Alloy Steel
	Mandrel	High-carbon Steel
Finish	Body	Black Oxide
	Mandrel	Zinc Plated

\*IPX-7 Watertightness Approved!

Part Number No.	Diameter mm	Art. Code	Grip Range		Drill Diameter		ΦA Max	ΦB Max	D Max	L Max	M Max	Shear Force (KN Nom)	Tensile Force (KN Nom)
			Min	Max	Min	Max							
SSBOOM48095	4.8 mm (3/16")	SSBOOM-00602	2.40	4.00	5.30	5.65	5.20	7.40	4.95	9.50	12.70	12.40	8.00
SSBOOM48111		SSBOOM-00603	4.00	5.60						11.10	14.30		
SSBOOM48127		SSBOOM-00604	5.60	7.20						12.70	15.90		
SSBOOM48143		SSBOOM-00605	7.80	8.80						14.30	17.50		
SSBOOM48159		SSBOOM-00606	8.80	10.30						15.90	19.10		
SSBOOM48175		SSBOOM-00607	10.30	11.90						17.50	20.60		
SSBOOM48190		SSBOOM-00608	11.90	13.50						19.00	22.20		
SSBOOM48206		SSBOOM-00609	13.50	15.10						20.60	23.80		
SSBOOM48222		SSBOOM-00610	15.10	16.70						22.20	25.40		
SSBOOM48238		SSBOOM-00611	16.70	18.30						23.80	27.00		
SSBOOM48254		SSBOOM-00612	18.30	19.90						25.40	28.60		
SSBOOM64116		6.4 mm (1/4")	SSBOOM-00802	2.80						4.00	7.10		
SSBOOM64132	SSBOOM-00803		4.00	5.60	13.20	17.30							
SSBOOM64148	SSBOOM-00804		5.60	7.20	14.80	18.90							
SSBOOM64164	SSBOOM-00805		7.20	8.80	16.40	20.50							
SSBOOM64180	SSBOOM-00806		8.80	10.30	18.00	22.10							
SSBOOM64196	SSBOOM-00807		10.30	11.90	19.60	23.70							
SSBOOM64212	SSBOOM-00808		11.90	13.50	21.20	25.30							
SSBOOM64228	SSBOOM-00809		13.50	15.10	22.80	26.90							
SSBOOM64243	SSBOOM-00810		15.10	16.70	24.30	28.50							
SSBOOM64259	SSBOOM-00811		16.70	18.30	25.90	30.00							
SSBOOM64275	SSBOOM-00812		18.30	19.90	27.50	31.60							

# Full Carbon Steel Boom-Lock Blind Rivet

**Available Sizes**

Φ4.8(3/16"), Φ6.4(1/4"),  
 Φ8.0(5/16"), Φ10.0(3/8"),  
 Φ12.7(1/2")

**Materials**

Body: Low-carbon Steel  
 Mandrel: High-carbon Steel



Part Number No.	Diameter mm	Art. Code	Grip Range		Drill Diameter		ΦA Max	ΦB Max	D Max	L Max	M Max	Shear Force (KN Norm)	Tensile Force (KN Norm)
			Min	Max	Min	Max							
SSMBOOM80176	8.0 mm (5/16")	SSBOOM-01004	4.80	7.90	8.85	9.35	8.75	12.40	7.30	17.60	21.60	35.80	23.10
SSMBOOM80208		SSBOOM-01006	7.90	11.10						20.80	25.40		
SSMBOOM80240		SSBOOM-01008	11.10	14.30						24.00	28.60		
SSMBOOM80271		SSBOOM-01010	14.30	17.50						27.10	31.80		
SSMBOOM80303		SSBOOM-01012	17.50	20.60						30.30	34.90		
SSMBOOM80335		SSBOOM-01014	20.60	23.80						33.50	38.10		
SSMBOOM80367		SSBOOM-01016	23.80	27.00						36.70	41.30		
SSBOOM100194	10.0 mm (3/8")	SSBOOM-01204	4.80	7.90	10.50	11.05	10.45	14.70	8.30	19.40	24.60	49.40	32.30
SSBOOM100226		SSBOOM-01206	7.90	11.10						22.60	27.80		
SSBOOM100258		SSBOOM-01208	11.10	14.30						25.80	31.00		
SSBOOM100289		SSBOOM-01210	14.30	17.50						28.90	34.10		
SSBOOM100321		SSBOOM-01212	17.50	20.60						32.10	37.30		
SSBOOM100353		SSBOOM-01214	20.60	23.80						35.30	40.50		
SSBOOM100385		SSBOOM-01216	23.80	27.00						38.50	43.70		
SSBOOM100416		SSBOOM-01218	27.00	30.20						41.60	46.80		
SSBOOM100448		SSBOOM-01220	30.20	33.30						44.80	50.00		
SSBOOM127254		12.7 mm (1/2")	SSBOOM-01604	6.40						9.50	13.90		
SSBOOM127285	SSBOOM-01606		9.50	12.70	28.50	35.30							
SSBOOM127317	SSBOOM-01608		12.70	15.90	31.70	38.50							
SSBOOM127349	SSBOOM-01610		15.90	19.10	34.90	41.70							
SSBOOM127381	SSBOOM-01612		19.10	22.20	38.10	44.90							
SSBOOM127412	SSBOOM-01614		22.20	25.40	41.20	48.00							
SSBOOM127444	SSBOOM-01616		25.40	28.60	44.40	51.20							
SSBOOM127476	SSBOOM-01618		28.60	31.80	47.60	54.00							
SSBOOM127508	SSBOOM-01620		31.80	34.90	50.80	57.60							
SSBOOM127539	SSBOOM-01622		34.90	38.10	53.90	60.70							
SSBOOM127571	SSBOOM-01624		38.10	41.30	57.10	63.90							

# Double Countersunk Head Pull Through Rivet

## Available Sizes

Φ2.4(3/32"), Φ3.0(7/61"),  
Φ3.2(1/8")

## Materials

Body: Carbon Steel  
Mandrel: Carbon Steel



Double Countersunk Head Pull Through Rivet

RVMATE

Washen

## Double Countersunk Head Pull Through Rivet

Mandrel	Material	Carbon steel
	Surface	Zinc plated
Body	Material	Carbon steel
	Surface	Zinc plated

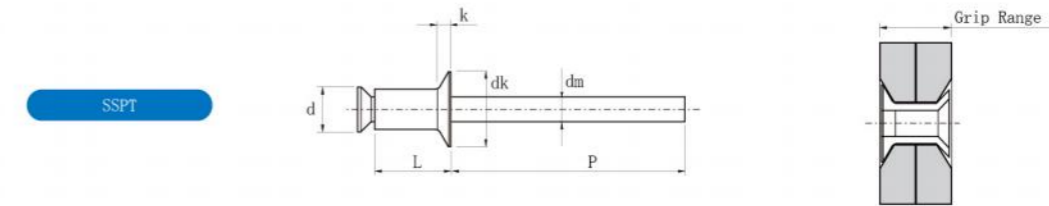

Units: mm

Diameter [d]	Part No.	Art.Code	Size	Body Length [L] (nom.)	Grip Range	Drill	dk	k	Mandrel Dia [dm] (ref.)	Mandrel Reveal [P] (min.)	Typical Ultimate Strength	
											Tensile	Shear
2.4 (3/32")	SSPT24021	/	2.4×2.1	1.9-2.3	1.3-1.8							
	SSPT24024	/	2.4×2.4	2.2-2.6	1.6-2.0							
	SSPT24028	/	2.4×2.8	2.6-3.0	2.0-2.5							
	SSPT24033	/	2.4×3.3	3.1-3.5	2.5-3.0							
	SSPT24038	/	2.4×3.8	3.6-4.0	3.0-3.5	2.5-2.6	3.8±0.2	0.50-0.70	1.4	27.0	500N	600N
	SSPT24043	/	2.4×4.3	4.1-4.5	3.5-4.0							
	SSPT24048	/	2.4×4.8	4.6-5.0	4.0-4.5							
	SSPT24053	/	2.4×5.3	5.1-5.5	4.5-5.0							
	SSPT24058	/	2.4×5.8	5.6-6.0	5.0-5.5							
	SSPT24063	/	2.4×6.3	6.1-6.5	5.5-6.0							

# Double Countersunk Head Pull Through Rivet

## Available Sizes

Φ2.4(3/32"), Φ3.0(7/61"),  
Φ3.2(1/8")

## Materials

Body: Carbon Steel  
Mandrel: Carbon Steel



Speed Rivet Series

RVMATE

Washen

Units: mm

Diameter [d]	Part No.	Art.Code	Size	Body Length [L] (nom.)	Grip Range	Drill	dk	k	Mandrel Dia [dm] (ref.)	Mandrel Reveal [P] (min.)	Typical Ultimate Strength	
											Tensile	Shear
3.0 (7/61")	SSPT30023	RSKK3025PT	3.0×2.3	2.0-2.6	1.5-2.0	3.1-3.2	4.9-5.4	0.7-0.95	1.85	27.0	700N	800N
	SSPT30028	RSKK3030PT	3.0×2.8	2.5-3.1	2.0-2.5							
	SSPT30033	RSKK3035PT	3.0×3.3	3.0-3.6	2.5-3.0							
	SSPT30038	RSKK3040PT	3.0×3.8	3.5-4.1	3.0-3.5							
	SSPT30043	RSKK3045PT	3.0×4.3	4.0-4.6	3.5-4.0							
	SSPT30048	RSKK3050PT	3.0×4.8	4.5-5.1	4.0-4.5							
	SSPT30053	RSKK3055PT	3.0×5.3	5.0-5.6	4.5-5.0							
	SSPT30058	RSKK3060PT	3.0×5.8	5.5-6.1	5.0-5.5							
SSPT30063	RSKK3065PT	3.0×6.3	6.0-6.6	5.5-6.0								
3.2 (1/8")	SSPT32021	/	3.2×2.1	1.8-2.4	1.3-1.8	3.3-3.4	4.9-5.4	0.7-0.95	1.85	27.0	800N	900N
	SSPT32024	/	3.2×2.4	2.1-2.7	1.6-2.0							
	SSPT32028	/	3.2×2.8	2.5-3.1	2.0-2.5							
	SSPT32033	/	3.2×3.3	3.0-3.6	2.5-3.0							
	SSPT32038	/	3.2×3.8	3.5-4.1	3.0-3.5							
	SSPT32043	/	3.2×4.3	4.0-4.6	3.5-4.0							
	SSPT32048	/	3.2×4.8	4.5-5.1	4.0-4.5							
	SSPT32053	/	3.2×5.3	5.0-5.6	4.5-5.0							
SSPT32058	/	3.2×5.8	5.5-6.1	5.0-5.5								
SSPT32063	/	3.2×6.3	6.0-6.6	5.5-6.0								

# Aluminum Speed Rivet

## Available Sizes

Φ2.4(3/32"), Φ3.2(1/8"),  
 Φ4.0(5/32"), Φ4.8(3/16"),  
 Φ6.0(15/64")

## Materials

Aluminum



Speed Rivet Series

RVMATE

Washen

## Aluminum Speed Rivet (BRV series)

Material Aluminum  
 Surface Natural polish



\*Optional on request: Stainless steel & Brass

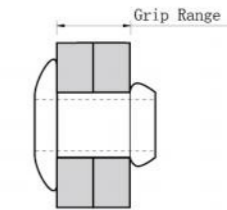
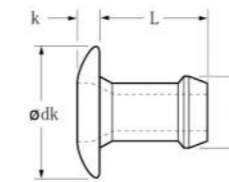

Units: mm

Size	Part No.	Art.Code	Grip Range	Drill	dk(Max.)	k(Max.)	Body Length [L](Max.)	D (Max.)	Shear	Tensile	Fasteners Per Pod
2.4 (3/32")	ASDR-BRV24040	ASDR-1801-0304	1.14-2.42	2.36-2.44	4.11	0.89	3.98	2.35	200N	400N	64
	ASDR-BRV24050	ASDR-1801-0306	2.15-3.43				5.00				52
	ASDR-BRV24060	ASDR-1801-0308	3.17-4.45				6.02				44
	ASDR-BRV24070	ASDR-1801-0310	4.19-5.47				7.04				38
	ASDR-BRV24080	ASDR-1801-0312	5.20-6.48				8.05				34
	ASDR-BRV24090	ASDR-1801-0314	6.22-7.50				9.07				30
	ASDR-BRV24096	ASDR-1801-0315	6.73-8.00				9.57				28
	ASDR-BRV24101	ASDR-1801-0316	7.24-8.51				10.08				27
	ASDR-BRV24106	ASDR-1801-0317	7.75-9.02				10.59				26
3.2 (1/8")	ASDR-BRV32039	ASDR-1801-0403	0.64-1.91	3.26-3.34	6.53	0.99	3.86	3.14	700N	1300N	59
	ASDR-BRV32044	ASDR-1801-0404	1.14-2.42				4.37				58
	ASDR-BRV32049	ASDR-1801-0405	1.65-2.87				4.87				50
	ASDR-BRV32054	ASDR-1801-0406	2.15-3.43				5.39				48
	ASDR-BRV32064	ASDR-1801-0408	3.17-4.45				6.41				42
	ASDR-BRV32074	ASDR-1801-0410	4.19-5.47				7.42				37
	ASDR-BRV32084	ASDR-1801-0412	5.20-6.48				8.44				33
	ASDR-BRV32094	ASDR-1801-0414	6.22-7.50				9.45				29
	ASDR-BRV32105	ASDR-1801-0416	7.24-8.51				10.46				26

# Aluminum Speed Rivet

## Available Sizes

Φ2.4(3/32"), Φ3.2(1/8"),  
Φ4.0(5/32"), Φ4.8(3/16"),  
Φ6.0(15/64")

## Materials

Aluminum



Speed Rivet Series

RWMATE

Washen

Units: mm

Size	Part No.	Art.Code	Grip Range	Drill	dk(Max.)	k(Max.)	Body Length [L](Max.)	D (Max.)	Shear	Tensile	Fasteners Per Pod
4.0 (5/32")	ASDR-BRV40049	ASDR-1801-0505	1.57-2.93	3.97-4.04	8.18	0.99	4.91	3.88	1100N	1700N	52
	ASDR-BRV40054	ASDR-1801-0506	2.15-3.43				5.41				49
	ASDR-BRV40059	ASDR-1801-0507	2.66-3.94				5.92				44
	ASDR-BRV40069	ASDR-1801-0509	3.68-4.96				6.94				39
	ASDR-BRV40079	ASDR-1801-0511	4.69-5.97				7.95				34
	ASDR-BRV40089	ASDR-1801-0513	5.71-6.99				8.97				31
	ASDR-BRV40099	ASDR-1801-0515	6.73-8.00				9.98				26
	ASDR-BRV40110	ASDR-1801-0517	7.75-9.02				11.00				24
4.8 (3/16")	ASDR-BRV48054	ASDR-1801-0606	1.65-3.30	4.85-4.93	9.71	1.17	5.39	4.77	1500N	2700N	46
	ASDR-BRV48061	ASDR-1801-0607	2.03-3.94				6.10				42
	ASDR-BRV48074	ASDR-1801-0609	3.68-5.21				7.37				35
	ASDR-BRV48086	ASDR-1801-0611	4.95-6.48				8.64				31
	ASDR-BRV48099	ASDR-1801-0613	6.22-7.75				9.91				27
	ASDR-BRV48112	ASDR-1801-0615	7.49-9.02				11.18				24
	ASDR-BRV48125	ASDR-1801-0617	8.76-10.29				12.45				22
	ASDR-BRV48135	ASDR-1801-0619	10.03-11.56				13.46				20
6.0 (15/64")	ASDR-BRV60069	ASDR-1801-06007	2.66-3.94	5.94-6.02	11.55	1.35	6.93	5.93	1600N	3200N	37
	ASDR-BRV60079	ASDR-1801-06009	3.68-4.95				7.94				33
	ASDR-BRV60089	ASDR-1801-06011	4.70-5.96				8.96				29
	ASDR-BRV60099	ASDR-1801-06013	5.71-6.98				9.98				26
	ASDR-BRV60110	ASDR-1801-06015	6.73-7.99				10.99				24
	ASDR-BRV60120	ASDR-1801-06017	7.74-9.01				12.00				23

## Aluminum Speed Rivet (CBT series)

Material Aluminum  
Surface Natural polish

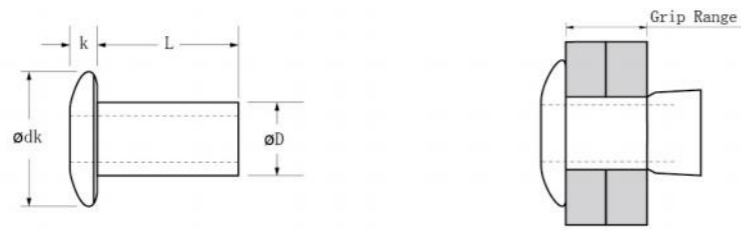

Units: mm

Size	Part No.	Art.Code	Grip Range	Drill	dk(Max.)	k(Max.)	Body Length [L](Max.)	D (Max.)	Shear	Tensile	Fasteners Per Pod
2.4 (3/32")	ASDR-CBT24032	ASDR-1131-0304	1.57	2.49-2.55	4.14	1.00	3.17	2.48	500N	/	73
	ASDR-CBT24048	ASDR-1131-0306	1.57-3.17				4.75				52
	ASDR-CBT24064	ASDR-1131-0308	3.17-4.75				6.35				41
	ASDR-CBT24079	ASDR-1131-0310	4.75-6.35				7.92				33
	ASDR-CBT24095	ASDR-1131-0312	6.35-7.92				9.52				28
	ASDR-CBT24111	ASDR-1131-0314	7.92-9.52				11.1				24
	ASDR-CBT24127	ASDR-1131-0316	9.52-11.1				12.7				22
3.2 (1/8")	ASDR-CBT32032	SSDR-1131-0404	1.57	3.26-3.34	5.52	1.20	3.17	3.27	800N	/	71
	ASDR-CBT32048	SSDR-1131-0406	1.57-3.17				4.75				51
	ASDR-CBT32064	SSDR-1131-0408	3.17-4.75				6.35				39
	ASDR-CBT32079	SSDR-1131-0410	4.75-6.35				7.92				32
	ASDR-CBT32095	SSDR-1131-0412	6.35-7.92				9.52				27
	ASDR-CBT32111	SSDR-1131-0414	7.92-9.52				11.10				23
4.0 (5/32")	ASDR-CBT40048	ASDR-1131-0506	1.57-3.17	4.09-4.17	6.53	1.50	4.75	4.06	1600N	/	47
	ASDR-CBT40064	ASDR-1131-0508	3.17-4.75				6.35				38
	ASDR-CBT40079	ASDR-1131-0510	4.75-6.35				7.92				31
	ASDR-CBT40095	ASDR-1131-0512	6.35-7.92				9.52				27
	ASDR-CBT40111	ASDR-1131-0514	7.92-9.52				11.10				23
	ASDR-CBT40127	ASDR-1131-0516	9.52-11.1				12.70				21
	ASDR-CBT40144	ASDR-1131-0518	11.1-12.7				14.40				
	ASDR-CBT40160	ASDR-1131-0520	12.7-14.27				16.00				

Units: mm

Size	Part No.	Art.Code	Grip Range	Drill	dk(Max.)	k(Max.)	Body Length [L](Max.)	D (Max.)	Shear	Tensile	Fasteners Per Pod
4.8 (3/16")	ASDR-CBT48040	ASDR-1131-0605	1.57	4.85-4.93	8.92	1.81	3.96	4.82	2000N	/	50
	ASDR-CBT48056	ASDR-1131-0607	1.57-3.17				5.56				38
	ASDR-CBT48071	ASDR-1131-0609	3.17-4.75				7.14				33
	ASDR-CBT48087	ASDR-1131-0611	4.75-6.35				8.74				28
	ASDR-CBT48103	ASDR-1131-0613	6.35-7.92				10.31				24
	ASDR-CBT48119	ASDR-1131-0615	7.92-9.52				11.91				21
	ASDR-CBT48135	ASDR-1131-0617	9.52-11.1				13.49				19
	ASDR-CBT48151	ASDR-1131-0619	11.1-12.7				15.09				17
	6.4 (1/4")	ASDR-CBT64071	ASDR-1131-0809				3.17-4.75				6.35-6.43
ASDR-CBT64087		ASDR-1131-0811	4.75-6.35	8.74	33						
ASDR-CBT64103		ASDR-1131-0813	6.35-7.92	10.31	28						
ASDR-CBT64119		ASDR-1131-0815	7.92-9.52	11.91	25						
ASDR-CBT64135		ASDR-1131-0817	9.52-11.1	13.49	22						
ASDR-CBT64151		ASDR-1131-0819	11.1-12.7	15.09	19						
ASDR-CBT64167		ASDR-1131-0821	12.7-14.27	16.66	17						
ASDR-CBT64183		ASDR-1131-0823	14.27-15.87	18.26	16						
ASDR-CBT64198		ASDR-1131-0825	15.87-17.45	19.84	13						

# Q-Lock Blind Rivet

### Available Sizes

Φ3.2(1/8") , Φ4.0(5/32") ,  
Φ4.8 (3/16") , Φ6.4 (1/4")

### Head Styles

Dome Head, CSK Head, Large Flange

### Materials

Body: Aluminum  
Mandrel: Aluminum

## Q-Lock Blind Rivet (All aluminum)

Mandrel	Material	Aluminum
	Surface	Natural Polish
Body	Material	Aluminum
	Surface	Natural Polish

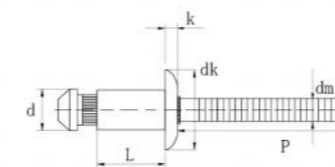

Dome Head

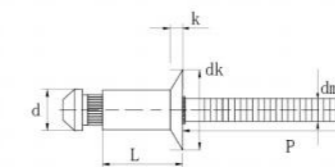

Countersunk Head

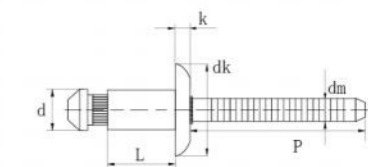

Large Flange

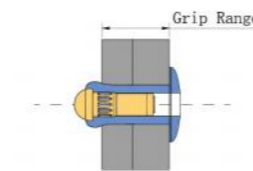

AAQ

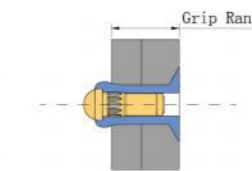

AAQC

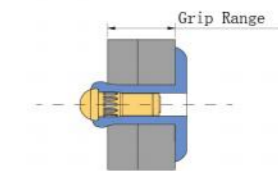

AAQLF



Units: mm

Diameter [d]	Part No.	Art.Code	Size	Body Length [L] (Max.)	Grip Range			Drill	Dome Head		Csk Head		Large Head		Mandrel Dia [dm] (Ref.)	Mandrel Reveal [P] (Min.)	Typical Ultimate Strength		
					Min.	Mid.	Max.		dk	K (Max.)	dk	K (Ref.)	dk	K (Max.)			Tensile	Shear	
3.2(1/8")	AAQ32070 AAQC32070 AAQLF3207010	AAQ0402 AAQC0402 AAQLF0402	3.2×7.0	7.0	1.60	2.36	3.18												
	AAQ32086 AAQC32086 AAQLF3208610	AAQ0403 AAQC0403 AAQLF0403	3.2×8.6	8.6	2.39	3.56	4.75												
	AAQ32102 AAQC32102 AAQLF3210210	AAQ0404 AAQC0404 AAQLF0404	3.2×10.2	10.2	3.20	4.75	6.35												
	AAQ32118 AAQC32118 AAQLF3211810	AAQ0405 AAQC0405 AAQLF0405	3.2×11.8	11.8	4.78	6.35	7.92	3.3-3.4	6.3 (±0.4)	1.1	5.7 (±0.2)	0.8	9.5 (±0.4)	1.7	1.9	27.0	1100N	1000N	
	AAQ32136 AAQC32136 AAQLF3213610	AAQ0406 AAQC0406 AAQLF0406	3.2×13.6	13.6	6.38	7.92	9.53												
	AAQ32153 AAQC32153 AAQLF3215310	AAQ0407 AAQC0407 AAQLF0407	3.2×15.3	15.3	7.95	9.53	11.10												
	AAQ32171 AAQC32171 AAQLF3217110	AAQ0408 AAQC0408 AAQLF0408	3.2×17.1	17.1	9.55	11.10	12.70												

Optional:  
A. Stems break flush with rivet head at min. grip  
B. Stems break flush with rivet head at mid. grip



# Q-Lock Blind Rivet

### Available Sizes

Ø3.2 (1/8") , Ø4.0 (5/32") ,  
Ø4.8 (3/16") , Ø6.4 (1/4")

### Head Styles

Dome Head, CSK Head, Large Flange

### Materials

Body: Aluminum, Carbon steel, Stainless steel  
Mandrel: Aluminum, Carbon steel, Stainless steel



Units: mm

Diameter [d]	Part No.	Art. Code	Size	Body Length [L] (Max.)	Grip Range			Drill	Dome Head		Csk Head		Large Head		Mandrel Dia [dm] (Ref.)	Mandrel Reveal [P] (Min.)	Typical Ultimate Strength	
					Min.	Mid.	Max.		dk	K (max.)	dk	K (Ref.)	dk	K (max.)			Tensile	Shear
4.0 (5/32")	AAQ40077 AAQC40077 AAQLF4007712	AAQ0502 AAQC0502 AAQLF0502	4.0×7.7	7.7	1.57	2.36	3.18	4.1-4.2	7.9 (±0.5)	1.3	7.1 (±0.2)	1.0	11.9 (±0.5)	1.9	2.4	27.0	1450N	1450N
	AAQ40108 AAQC40108 AAQLF4010812	AAQ0504 AAQC0504 AAQLF0504	4.0×10.8	10.8	3.20	4.75	6.35											
	AAQ40140 AAQC40140 AAQLF4014012	AAQ0506 AAQC0506 AAQLF0506	4.0×14.0	14.0	6.38	7.92	9.53											
	AAQ40177 AAQC40177 AAQLF4017712	AAQ0508 AAQC0508 AAQLF0508	4.0×17.7	17.7	9.55	11.10	12.70											
4.8 (3/16")	AAQ48083 AAQC48083 AAQLF4808316	AAQ0602 AAQC0602 AAQLF0602	4.8×8.3	8.3	1.57	2.36	3.18	4.9-5.0	9.5 (±0.5)	1.5	8.7 (±0.2)	1.3	15.9 (±0.7)	2.4	2.9	27.0	2000N	2200N
	AAQ48115 AAQC48115 AAQLF4811516	AAQ0604 AAQC0604 AAQLF0604	4.8×11.5	11.5	3.20	4.75	6.35											
	AAQ48147 AAQC48147 AAQLF4814716	AAQ0606 AAQC0606 AAQLF0606	4.8×14.7	14.7	6.38	7.92	9.53											
	AAQ48178 AAQC48178 AAQLF4817816	AAQ0608 AAQC0608 AAQLF0608	4.8×17.8	17.8	9.55	11.10	12.70											
	AAQ48216 AAQC48216 AAQLF4821616	AAQ0610 AAQC0610 AAQLF0610	4.8×21.6	21.6	12.73	14.27	15.88											
6.4 (1/4")	AAQ64096 AAQC64096 AAQLF6409619	AAQ0802 AAQC0802 AAQLF0802	6.4×9.6	9.6	1.57	2.36	3.18	6.5-6.6	12.7 (±0.7)	2.0	11.9 (±0.2)	1.8	19.1 (±0.7)	2.8	3.8	30.0	3340N	3780N
	AAQ64127 AAQC64127 AAQLF6412719	AAQ0804 AAQC0804 AAQLF0804	6.4×12.7	12.7	3.20	4.75	6.35											
	AAQ64159 AAQC64159 AAQLF6415919	AAQ0806 AAQC0806 AAQLF0806	6.4×15.9	15.9	6.38	7.92	9.53											
	AAQ64191 AAQC64191 AAQLF6419119	AAQ0808 AAQC0808 AAQLF0808	6.4×19.1	19.1	9.55	11.10	12.70											
	AAQ64229 AAQC64229 AAQLF6422919	AAQ0810 AAQC0810 AAQLF0810	6.4×22.9	22.9	12.73	14.27	15.88											

Optional:  
A. Stems break flush with rivet head at min. grip  
B. Stems break flush with rivet head at mid. grip

## Q-Lock Blind Rivet (Aluminum & Carbon steel)

Mandrel	Material	Carbon steel
	Surface	Zinc plated
Body	Material	Aluminum
	Surface	Natural polish

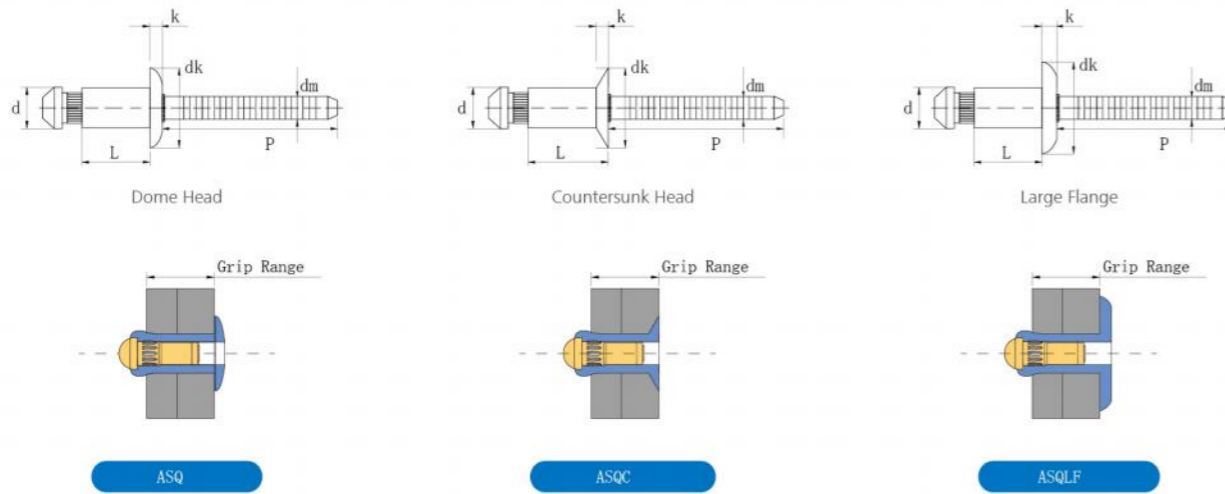

Units: mm

Diameter [d]	Part No.	Art.Code	Size	Body Length [L] (Max.)	Grip Range			Drill	Dome Head			Csk Head			Large Head			Mandrel Dia [dm] (Ref.)	Mandrel Reveal [P] (Min.)	Typical Ultimate Strength	
					Min.	Mid.	Max.		dk	K (Max.)	dk	K (Ref.)	dk	K (Max.)	Tensile	Shear					
3.2(1/8")	ASQ32070 ASQC32070 ASQLF3207010	ASQ0402 ASQC0402 ASQLF0402	3.2×7.0	7.0	1.60	2.36	3.18	3.3-3.4	6.3 (±0.4)	1.1	5.7 (±0.2)	0.8	9.5 (±0.4)	1.7	1.9	27.0	1450N	1560N			
	ASQ32086 ASQC32086 ASQLF3208610	ASQ0403 ASQC0403 ASQLF0403	3.2×8.6	8.6	2.39	3.56	4.75														
	ASQ32102 ASQC32102 ASQLF3210210	ASQ0404 ASQC0404 ASQLF0404	3.2×10.2	10.2	3.20	4.75	6.35														
	ASQ32118 ASQC32118 ASQLF3211810	ASQ0405 ASQC0405 ASQLF0405	3.2×11.8	11.8	4.78	6.35	7.92														
	ASQ32136 ASQC32136 ASQLF3213610	ASQ0406 ASQC0406 ASQLF0406	3.2×13.6	13.6	6.38	7.92	9.53														
	ASQ32153 ASQC32153 ASQLF3215310	ASQ0407 ASQC0407 ASQLF0407	3.2×15.3	15.3	7.95	9.53	11.10														
	ASQ32171 ASQC32171 ASQLF3217110	ASQ0408 ASQC0408 ASQLF0408	3.2×17.1	17.1	9.55	11.10	12.70														

Optional:  
 A. Stems break flush with rivet head at min. grip  
 B. Stems break flush with rivet head at mid. grip

Units: mm

Diameter [d]	Part No.	Art.Code	Size	Body Length [L] (Max.)	Grip Range			Drill	Dome Head			Csk Head			Large Head			Mandrel Dia [dm] (Ref.)	Mandrel Reveal [P] (Min.)	Typical Ultimate Strength	
					Min.	Mid.	Max.		dk	K (Max.)	dk	K (Ref.)	dk	K (Max.)	Tensile	Shear					
4.0(5/32")	ASQ40077 ASQC40077 ASQLF4007712	ASQ0502 ASQC0502 ASQLF0502	4.0×7.7	7.7	1.57	2.36	3.18	4.1-4.2	7.9 (±0.5)	1.3	7.1 (±0.2)	1.0	11.9 (±0.5)	1.9	2.4	27.0	2000N	2340N			
	ASQ40092 ASQC40092 ASQLF4009212	ASQ0503 ASQC0503 ASQLF0503	4.0×9.2	9.2	2.39	3.56	4.75														
	ASQ40108 ASQC40108 ASQLF4010812	ASQ0504 ASQC0504 ASQLF0504	4.0×10.8	10.8	3.20	4.75	6.35														
	ASQ40140 ASQC40140 ASQLF4014012	ASQ0506 ASQC0506 ASQLF0506	4.0×14.0	14.0	6.38	7.92	9.53														
	ASQ40177 ASQC40177 ASQLF4017712	ASQ0508 ASQC0508 ASQLF0508	4.0×17.7	17.7	9.55	11.10	12.70														
4.8(3/16")	ASQ48083 ASQC48083 ASQLF4808316	ASQ0602 ASQC0602 ASQLF0602	4.8×8.3	8.3	1.57	2.36	3.18	4.9-5.0	9.5 (±0.5)	1.6	8.7 (±0.2)	1.3	15.9 (±0.7)	2.4	2.9	27.0	2890N	3340N			
	ASQ48094 ASQC48094 ASQLF4809416	ASQ0603 ASQC0603 ASQLF0603	4.8×9.4	9.4	2.39	3.56	4.75														
	ASQ48115 ASQC48115 ASQLF4811516	ASQ0604 ASQC0604 ASQLF0604	4.8×11.5	11.5	3.20	4.75	6.35														
	ASQ48130 ASQC48130 ASQLF4813016	ASQ0605 ASQC0605 ASQLF0605	4.8×13.0	13.0	4.78	6.35	7.92														
	ASQ48147 ASQC48147 ASQLF4814716	ASQ0606 ASQC0606 ASQLF0606	4.8×14.7	14.7	6.38	7.92	9.53														
	ASQ48178 ASQC48178 ASQLF4817816	ASQ0608 ASQC0608 ASQLF0608	4.8×17.8	17.8	9.55	11.10	12.70														
	ASQ48216 ASQC48216 ASQLF4821616	ASQ0610 ASQC0610 ASQLF0610	4.8×21.6	21.6	12.73	14.27	15.88														
6.4(1/4")	ASQ64096 ASQC64096 ASQLF6409619	ASQ0802 ASQC0802 ASQLF0802	6.4×9.6	9.6	1.57	2.36	3.18	6.5-6.6	12.7 (±0.7)	2.0	11.9 (±0.2)	1.8	19.1 (±0.7)	2.8	3.8	30.0	4670N	5560N			
	ASQ64127 ASQC64127 ASQLF6412719	ASQ0804 ASQC0804 ASQLF0804	6.4×12.7	12.7	3.20	4.75	6.35														
	ASQ64159 ASQC64159 ASQLF6415919	ASQ0806 ASQC0806 ASQLF0806	6.4×15.9	15.9	6.38	7.92	9.53														
	ASQ64191 ASQC64191 ASQLF6419119	ASQ0808 ASQC0808 ASQLF0808	6.4×19.1	19.1	9.55	11.10	12.70														
	ASQ64229 ASQC64229 ASQLF6422919	ASQ0810 ASQC0810 ASQLF0810	6.4×22.9	22.9	12.73	14.27	15.88														

Optional:  
 A. Stems break flush with rivet head at min. grip  
 B. Stems break flush with rivet head at mid. grip

### Q-Lock Blind Rivet (All carbon steel)

Mandrel	Material	Carbon steel
	Surface	Zinc plated
Body	Material	Carbon steel
	Surface	Zinc plated

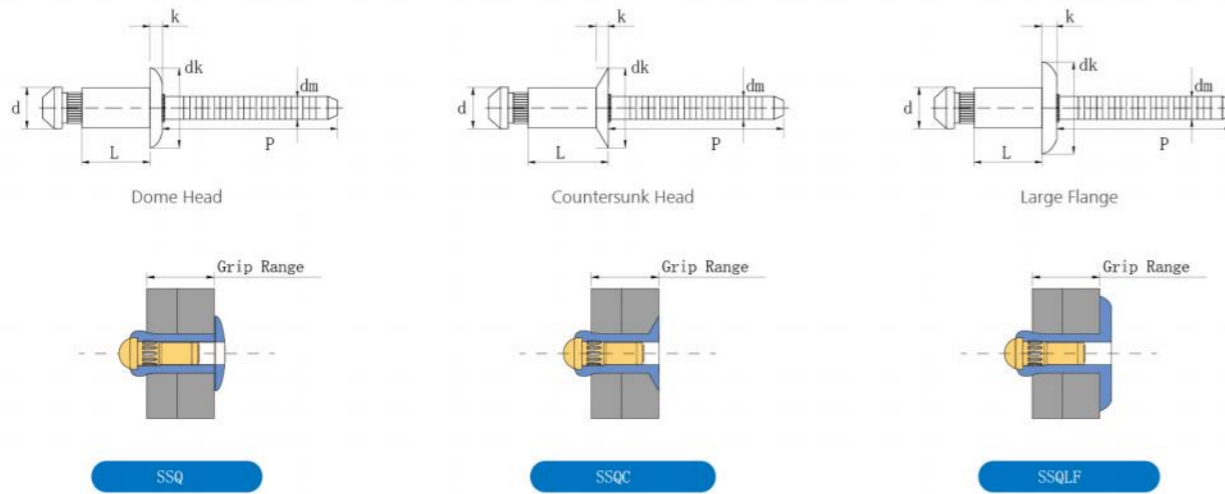

Units: mm

Diameter [d]	Part No.	Art.Code	Size	Body Length [L] (Max.)	Grip Range			Drill	Dome Head		Csk Head		Large Head		Mandrel Dia [dm] (Ref.)	Mandrel Reveal [P] (Min.)	Typical Ultimate Strength	
					Min.	Mid.	Max.		dk	K (Max.)	dk	K (Ref.)	dk	K (Max.)			Tensile	Shear
3.2(1/8")	SSQ32070 SSQC32070 SSQLF3207010	SSQ0402 SSQC0402 SSQLF0402	3.2×7.0	7.0	1.60	2.36	3.18	3.3-3.4	6.3 (±0.4)	1.1	5.7 (±0.2)	0.8	9.5 (±0.4)	1.7	1.9	27.0	1780N	2220N
	SSQ32086 SSQC32086 SSQLF3208610	SSQ0403 SSQC0403 SSQLF0403	3.2×8.6	8.6	2.39	3.56	4.75											
	SSQ32102 SSQC32102 SSQLF3210210	SSQ0404 SSQC0404 SSQLF0404	3.2×10.2	10.2	3.20	4.75	6.35											
	SSQ32118 SSQC32118 SSQLF3211810	SSQ0405 SSQC0405 SSQLF0405	3.2×11.8	11.8	4.78	6.35	7.92											
	SSQ32136 SSQC32136 SSQLF3213610	SSQ0406 SSQC0406 SSQLF0406	3.2×13.6	13.6	6.38	7.92	9.53											
	SSQ32153 SSQC32153 SSQLF3215310	SSQ0407 SSQC0407 SSQLF0407	3.2×15.3	15.3	7.95	9.53	11.10											
SSQ32171 SSQC32171 SSQLF3217110	SSQ0408 SSQC0408 SSQLF0408	3.2×17.1	17.1	9.55	11.10	12.70												

Optional:  
 A. Stems break flush with rivet head at min. grip  
 B. Stems break flush with rivet head at mid. grip

Units: mm

Diameter [d]	Part No.	Art.Code	Size	Body Length [L] (Max.)	Grip Range			Drill	Dome Head		Csk Head		Large Head		Mandrel Dia [dm] (Ref.)	Mandrel Reveal [P] (Min.)	Typical Ultimate Strength	
					Min.	Mid.	Max.		dk	K (Max.)	dk	K (Ref.)	dk	K (Max.)			Tensile	Shear
4.0(5/32")	SSQ40077 SSQC40077 SSQLF4007712	SSQ0502 SSQC0502 SSQLF0502	4.0×7.7	7.7	1.57	2.36	3.18	4.1-4.2	7.9 (±0.5)	1.3	7.1 (±0.2)	1.0	11.9 (±0.5)	1.9	2.4	27.0	2440N	3110N
	SSQ40092 SSQC40092 SSQLF4009212	SSQ0503 SSQC0503 SSQLF0503	4.0×9.2	9.2	2.39	3.56	4.75											
	SSQ40108 SSQC40108 SSQLF4010812	SSQ0504 SSQC0504 SSQLF0504	4.0×10.8	10.8	3.20	4.75	6.35											
	SSQ40124 SSQC40124 SSQLF4012412	SSQ0505 SSQC0505 SSQLF0505	4.0×12.4	12.4	4.78	6.35	7.92											
	SSQ40140 SSQC40140 SSQLF4014012	SSQ0506 SSQC0506 SSQLF0506	4.0×14.0	14.0	6.38	7.92	9.53											
	SSQ40177 SSQC40177 SSQLF4017712	SSQ0508 SSQC0508 SSQLF0508	4.0×17.7	17.7	9.55	11.10	12.70											
4.8(3/16")	SSQ48083 SSQC48083 SSQLF4808316	SSQ0602 SSQC0602 SSQLF0602	4.8×8.3	8.3	1.57	2.36	3.18	4.9-5.0	9.5 (±0.5)	1.5	8.7 (±0.2)	1.3	15.9 (±0.7)	2.4	2.9	27.0	3670N	4670N
	SSQ48098 SSQC48098 SSQLF4809416	SSQ0603 SSQC0603 SSQLF0603	4.8×9.8	9.8	1.65	3.2	4.75											
	SSQ48115 SSQC48115 SSQLF4811516	SSQ0604 SSQC0604 SSQLF0604	4.8×11.5	11.5	3.20	4.75	6.35											
	SSQ48130 SSQC48130 SSQLF4813016	SSQ0605 SSQC0605 SSQLF0605	4.8×13.0	13.0	4.78	6.35	7.92											
	SSQ48147 SSQC48147 SSQLF4814716	SSQ0606 SSQC0606 SSQLF0606	4.8×14.7	14.7	6.38	7.92	9.53											
	SSQ48178 SSQC48178 SSQLF4817816	SSQ0608 SSQC0608 SSQLF0608	4.8×17.8	17.8	9.55	11.10	12.70											
SSQ48216 SSQC48216 SSQLF4821616	SSQ0610 SSQC0610 SSQLF0610	4.8×21.6	21.6	12.73	14.27	15.88												
6.4(1/4")	SSQ64096 SSQC64096 SSQLF6409619	SSQ0802 SSQC0802 SSQLF0802	6.4×9.6	9.6	1.57	2.36	3.18	6.5-6.6	12.7 (±0.7)	2.0	11.9 (±0.2)	1.8	19.1 (±0.7)	2.8	3.8	30.0	6450N	7780N
	SSQ64127 SSQC64127 SSQLF6412719	SSQ0804 SSQC0804 SSQLF0804	6.4×12.7	12.7	3.20	4.75	6.35											
	SSQ64159 SSQC64159 SSQLF6415919	SSQ0806 SSQC0806 SSQLF0806	6.4×15.9	15.9	6.38	7.92	9.53											
	SSQ64191 SSQC64191 SSQLF6419119	SSQ0808 SSQC0808 SSQLF0808	6.4×19.1	19.1	9.55	11.10	12.70											
	SSQ64229 SSQC64229 SSQLF6422919	SSQ0810 SSQC0810 SSQLF0810	6.4×22.9	22.9	12.73	14.27	15.88											

Optional:  
 A. Stems break flush with rivet head at min. grip  
 B. Stems break flush with rivet head at mid. grip

### Q-Lock Blind Rivet (All stainless steel)

Mandrel	Material	Stainless steel
	Surface	Natural polish
Body	Material	Stainless steel
	Surface	Natural polish

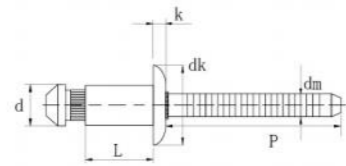

Dome Head

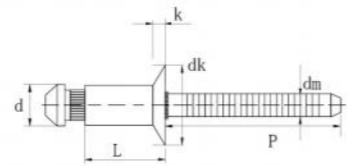

Countersunk Head

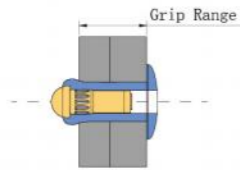

BBQ

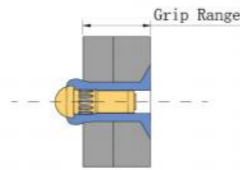

BBQC

Units: mm

Diameter [d]	Part No.	Art. Code	Size	Body Length [L] (Max.)	Grip Range			Drill	Dome Head		Csk Head		Large Head		Mandrel Dia [dm] (Ref.)	Mandrel Reveal [P] (Min.)	Typical Ultimate Strength	
					Min.	Mid.	Max.		dk	K (Max.)	dk	K (Ref.)	dk	K (Max.)			Tensile	Shear
3.2(1/8")	BBQ32070 BBQC32070	BBQ0402 BBQC0402	3.2×7.0	7.0	1.60	2.36	3.18	3.3-3.4	6.3 (±0.4)	1.1	5.7 (±0.2)	0.8	/	/	1.9	27.0	2670N	3110N
	BBQ32086 BBQC32086	BBQ0403 BBQC0403	3.2×8.6	8.6	2.39	3.56	4.75											
	BBQ32102 BBQC32102	BBQ0404 BBQC0404	3.2×10.2	10.2	3.20	4.75	6.35											
	BBQ32118 BBQC32118	BBQ0405 BBQC0405	3.2×11.8	11.8	4.78	6.35	7.92											
	BBQ32136 BBQC32136	BBQ0406 BBQC0406	3.2×13.6	13.6	6.38	7.92	9.53											
BBQ32171 BBQC32171	BBQ0408 BBQC0408	3.2×17.1	17.1	9.55	11.10	12.70												

Optional:  
 A. Stems break flush with rivet head at min. grip  
 B. Stems break flush with rivet head at mid. grip

Units: mm

Diameter [d]	Part No.	Art. Code	Size	Body Length [L] (Max.)	Grip Range			Drill	Dome Head		Csk Head		Large Head		Mandrel Dia [dm] (Ref.)	Mandrel Reveal [P] (Min.)	Typical Ultimate Strength	
					Min.	Mid.	Max.		dk	K (Max.)	dk	K (Ref.)	dk	K (Max.)			Tensile	Shear
4.0(5/32")	BBQ40077 BBQC40077	BBQ0502 BBQC0502	4.0×7.7	7.7	1.57	2.36	3.18	4.1-4.2	7.9 (±0.5)	1.3	7.1 (±0.2)	1.0	/	/	2.4	27.0	4450N	4670N
	BBQ40092 BBQC40092	BBQ0503 BBQC0503	4.0×9.2	9.2	2.39	3.56	4.75											
	BBQ40108 BBQC40108	BBQ0504 BBQC0504	4.0×10.8	10.8	3.20	4.75	6.35											
	BBQ40140 BBQC40140	BBQ0506 BBQC0506	4.0×14.0	14.0	6.38	7.92	9.53											
	BBQ40177 BBQC40177	BBQ0508 BBQC0508	4.0×17.7	17.7	9.55	11.10	12.70											
4.8(3/16")	BBQ48083 BBQC48083	BBQ0602 BBQC0602	4.8×8.3	8.3	1.57	2.36	3.18	4.9-5.0	9.5 (±0.5)	1.5	8.7 (±0.2)	1.3	/	/	2.9	27.0	5780N	7340N
	BBQ48115 BBQC48115	BBQ0604 BBQC0604	4.8×11.5	11.5	3.20	4.75	6.35											
	BBQ48130 BBQC48130	BBQ0605 BBQC0605	4.8×13.0	13.0	4.78	6.35	7.92											
6.4(1/4")	BBQ64127 BBQC64127	BBQ0804 BBQC0804	6.4×12.7	12.7	3.20	4.75	6.35	6.5-6.6	12.7 (±0.7)	2.0	11.9 (±0.2)	1.8	/	/	3.8	30.0	10000N	10900N
	BBQ64159 BBQC64159	BBQ0806 BBQC0806	6.4×15.9	15.9	6.38	7.92	9.53											
	BBQ64191 BBQC64191	BBQ0808 BBQC0808	6.4×19.1	19.1	9.55	11.10	12.70											

Optional:  
 A. Stems break flush with rivet head at min. grip  
 B. Stems break flush with rivet head at mid. grip

# Carbon Steel Self Piercing Rivet

## Available Sizes

Ø3.2 , Ø3.3 , Ø5.2 , Ø5.3

## Materials

Medium-carbon Steel

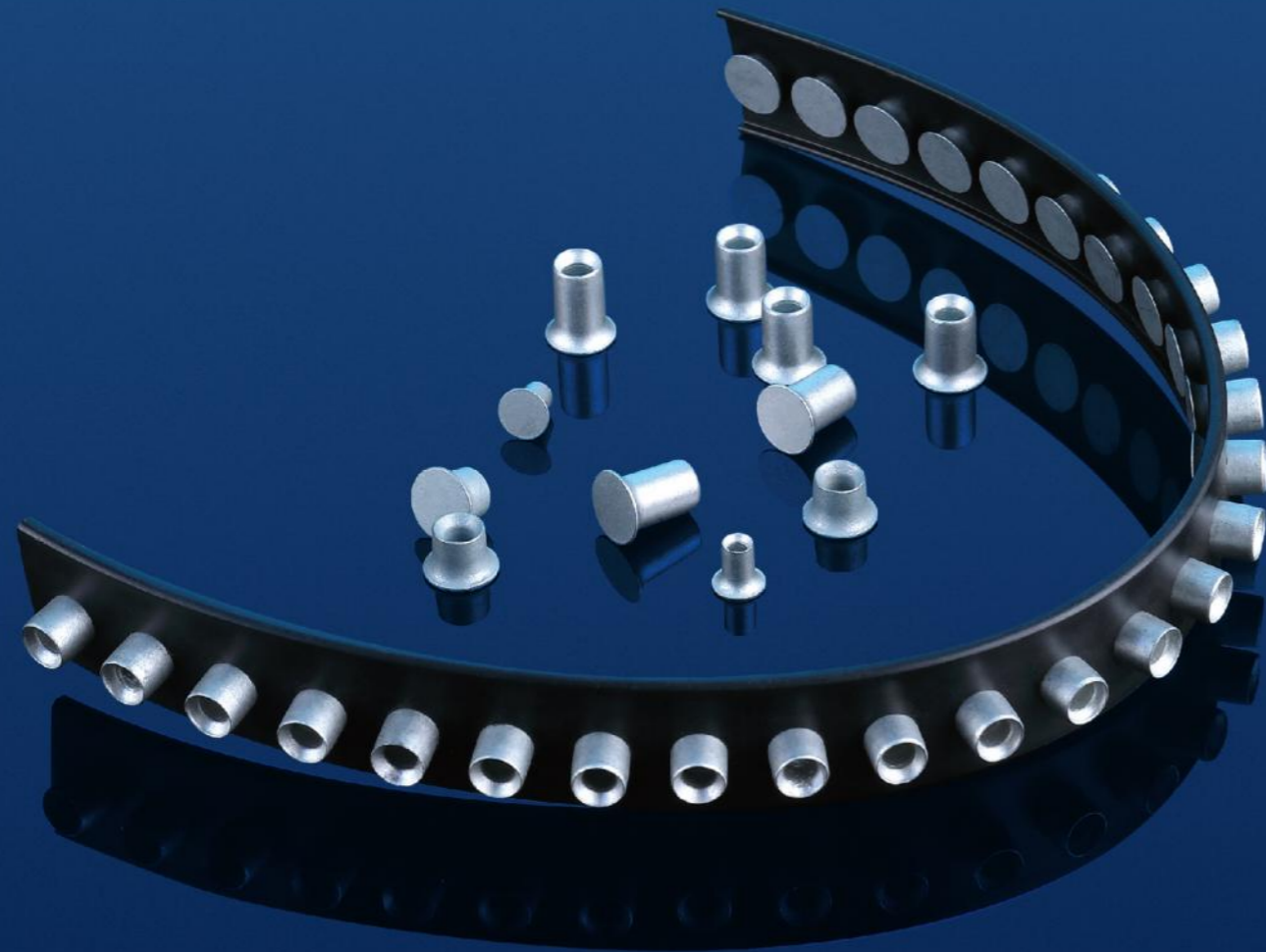

Scan to View Test Video  
(Carbon Steel Self Piercing Rivet 5.3x8.5)  
In Youtube

## Rivmate Rivet Catalog

C3xxxxx

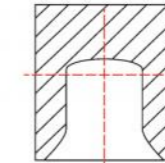

Applications	Automotive; Thinner Al. alloys and mild steel sheets
Diameters	3.3mm
Lengths	3.5 and 4 mm
Materials	Steel type"4" only
Hardnesses	Hardness Levels : H1, H2, H4, H6
Head Styles	"A" and "P" head

J3xxxxx

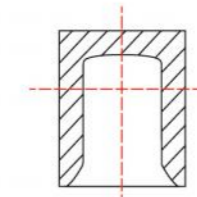

Applications	Automotive/Transport/General Industry; All - aluminum and mixed material joints including milder steels up to some grades of higher strength steels
Diameters	3.3mm
Lengths	5 and 6 mm
Materials	Steel type"4" only
Hardnesses	Hardness Levels : H1, H2, H4, H6
Head Styles	"A" and "P" head

## Rivmate Rivet Catalog

P3xxxxxx

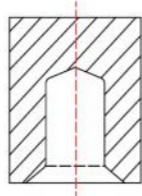

Applications	Automotive/Transport/General Industry; All - steel and mixed material joints including milder steels up to some grades of higher strength steels
Diameters	3.2mm
Lengths	4,5,6,7 mm
Materials	Steel type"4" only
Hardnesses	Hardness Levels : H1, H2, H4, H6
Head Styles	"C" and "P" head

R3xxxxxx

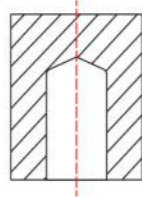

Applications	General Industry; All - steel and mixed material joints including milder steels up to some gauges of HSS
Diameters	3.2mm
Lengths	4,5,6,7 mm
Materials	Steel type"4" only
Hardnesses	Hardness Levels : H2, H4, H6
Head Styles	"C" and "P" head

## Rivmate Rivet Catalog

A5xxxxxx

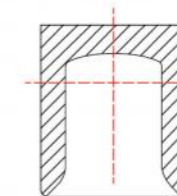

Applications	Automotive; Thinner Al. alloys and mild steel sheets
Diameters	5.3mm
Lengths	4 , 5, 5.5, 6, 6.5, 7, 7.5, 8, 8.5, 9, 9.5, 10, 10.5, 11, 12mm
Materials	Steel type"4" only
Hardnesses	Hardness Levels : H0, H1, H2, H4, H5, H6
Head Styles	"A" head

C5xxxxxx

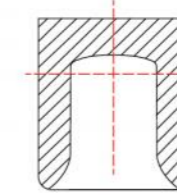

Applications	Automotive/Transport/General Industry; All - aluminum and mixed material joints including milder steels up to some grades of higher strength steels
Diameters	5.3mm
Lengths	4,5,5.5,6,6.5mm
Materials	Steel type"4" only
Hardnesses	Hardness Level : "A" :H0, H1, H2, H4, H5, H6 "P" :H1, H2, H4, H6
Head Styles	"A" and "P" head

## Rivmate Rivet Catalog

K5xxxxx

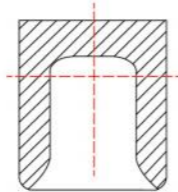

Applications	Automotive/Transport/General Industry; All - aluminum and mixed material joints including milder steels up to some grades of higher strength steels
Diameters	5.3mm
Lengths	7, 7.5, 8, 8.5, 9, 9.5, 10, 10.5, 11, 12mm
Materials	Steel type "4" only
Hardnesses	Hardness Level : "A" :H0, H1, H2, H4, H5, H6 "F"and "P":H1, H2, H4, H6
Head Styles	"A", "F"and "P"head

P5xxxxx

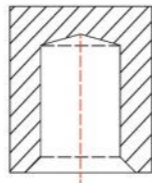

Applications	Automotive/Transport/General Industry;All-steel and mixed material joints including milder steels up to some grades of higher strength steels
Diameters	5.2mm
Lengths	5,6,7,8,9,10,11,12 mm
Materials	Steel type "4" only
Hardnesses	Hardness Levels : H1, H2, H4, H6
Head Styles	"C" and "P" head

## Rivmate Rivet Catalog

PGxxxxx

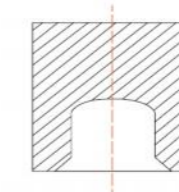

Applications	General Industry; All - steel and mixed material joints including milder steels up to some grades of HSS
Diameters	5.5mm
Lengths	5,6,7,8mm
Materials	Steel type "4" only
Hardnesses	Hardness Levels : H4, H6
Head Styles	"F" "L" and "P" head

HGxxxxx

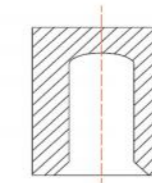

Applications	General Industry; All - steel and mixed material joints including milder steels up to some grades of higher strength steels
Diameters	5.5mm
Lengths	5, 5.5, 6.0, 6.5, 7.0,7.5 , 8.0mm
Materials	Steel type "4" only
Hardnesses	Hardness Levels : H4, H6
Head Styles	"M" head

